

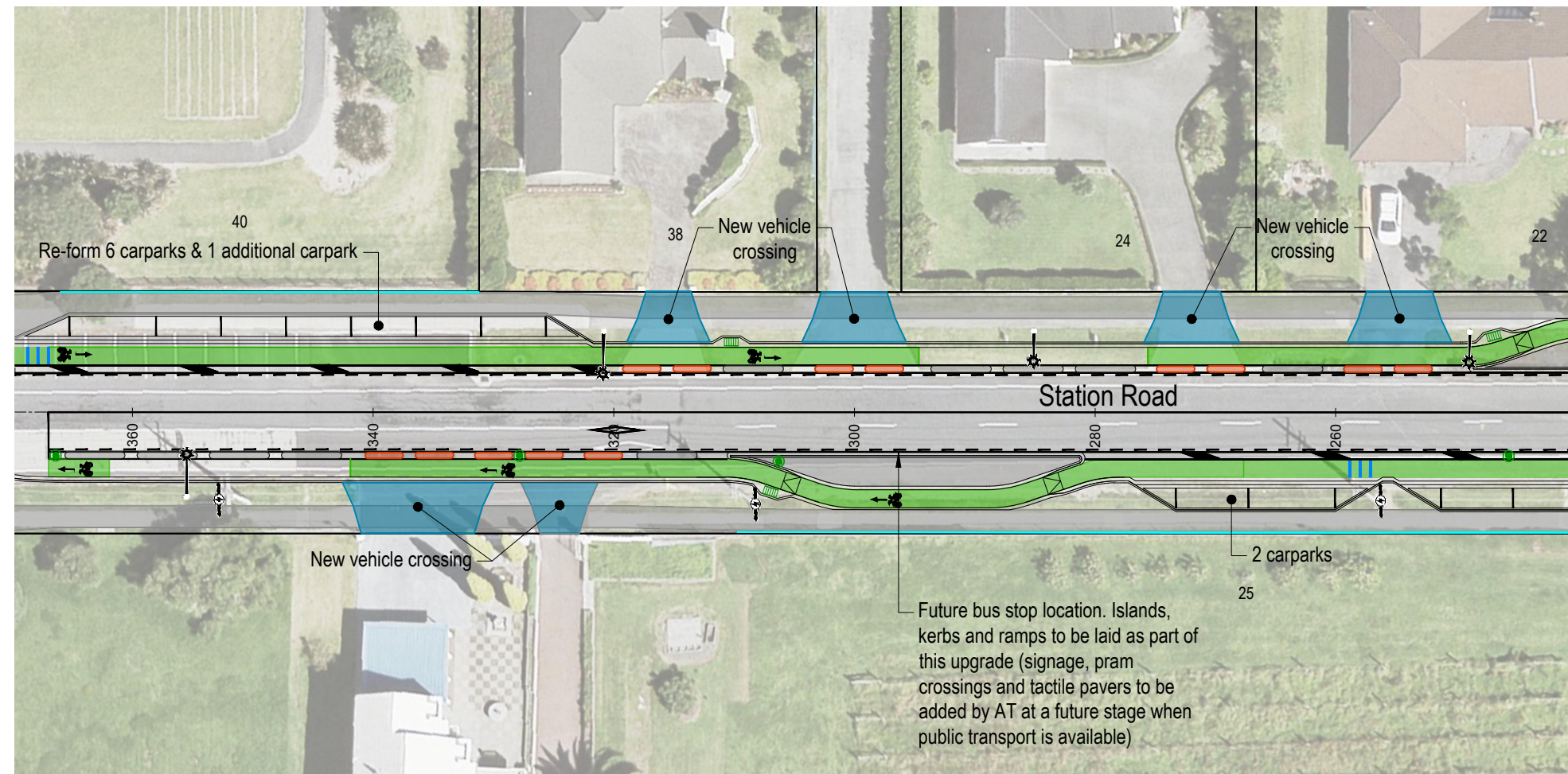

Legend

- Proposed Footpath
- Tactile Ground Surface Indicators
- Proposed Road Marking
- Street Light
- Existing Power Pole
- Proposed Power Pole (subject to Vector approval)
- Power Pole to be Removed
- Proposed Traffic Signals
- Proposed Vehicle Crossing
- Proposed Pedestrian Refuge Island
- Proposed Retaining Wall
- Proposed Cycle Lane
- High Friction Surface Markings
- Raised Island Separator
- Black & Yellow Rubber Speed Hump
- Proposed Stormwater Manhole
- Proposed Stormwater Catchpit



- ### NOTES
- #### GENERAL
1. The Contractor shall be responsible for locating all existing services prior to commencement of works. The Contractor shall make good at their own expense any damage to existing services.
 2. Levels are in terms of Auckland Vertical Datum 1946.
 3. All works are to be installed in accordance with Auckland Council Design Manual - Code of Practice for Land Development and Subdivision: (www.aucklanddesignmanual.co.nz/regulations/codes-of-practice)
 - Chapter 1 - General Requirements
 - Chapter 2 - Earthworks & Geotechnical
 - Chapter 3 - Transport (Auckland Transport)
 - Chapter 4 - Stormwater
 - Chapter 5 - Wastewater (Watercare)
 - Chapter 6 - Water (Watercare)
 4. If discrepancies are found between the standards, confirmation shall be sought from the Engineer and supervising council field officer.
- Standard Drawings available from their respective websites or the Engineer.

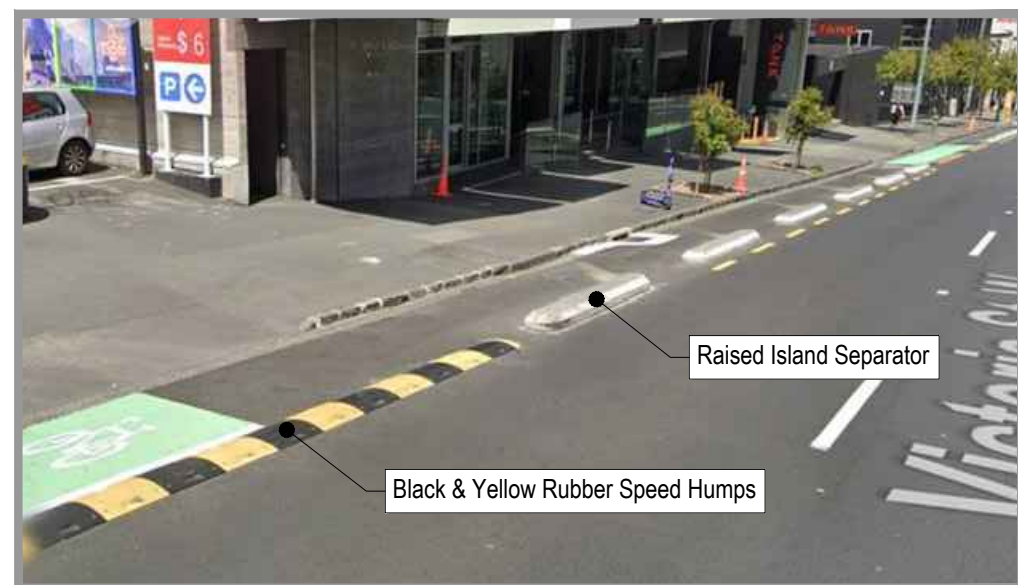

Example Raised Island Separator & Rubber Speed Hump Image

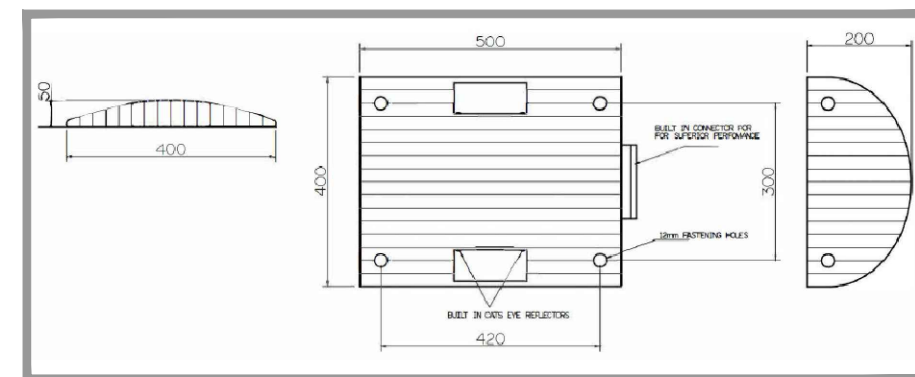

Black & Yellow Rubber Speed Hump Cross Section



Black & Yellow Rubber Speed Hump Reference Image

No.	REVISION (DESCRIPTIONS)	NAME	DATE
A	Issued for Discussion	BN	08/07/2021

FOR DISCUSSION

	NAME	DATE
SURVEYED		
DESIGNED	KM	04/11/2020
DRAWN	BN	08/07/2021
DATE	ORIGINAL SCALE	ORIGINAL SIZE
08/07/2021	1:500	A3

DRAWING NO.	REVISION
43786-DR-C-3012	A