









LEGEND

-  EXISTING KERB
-  EXISTING FENCE
-  NEW KERB
-  EXISTING FOOTPATH EDGE
-  NEW WHITE ROAD MARKING
-  NEW YELLOW ROAD MARKING
-  NEW / RECONSTRUCTED FOOTPATH
-  NEW/ RECONSTRUCTED DRIVEWAY
-  NEW BERM
-  NEW WHEELSTOP
-  EXISTING TREE
-  NEW STEEL GATE

-  1 NEW OFF STREET ANGLED PARKING - 27 BAYS
-  2 NEW OFF STREET MOBILITY PARKING - 2 BAYS
-  3 NEW OFF STREET PARALLEL PARKING- 4 BAYS
-  4 NEW RECESSED PARALLEL PARKING - 7 BAYS
-  5 NEW PAINTED PEDESTRIAN WALKWAY
-  6 NEW NO STOPPING AT ALL TIMES YELLOW LINES
-  7 RELOCATED MAINTENANCE VEHICLE ACCESS
-  8 RELOCATED PARKING AREA VEHICLE ENTRY / EXIT

TITIRANGI BADMINTON CLUB



200mm DO NOT SCALE - IF IN DOUBT, ASK

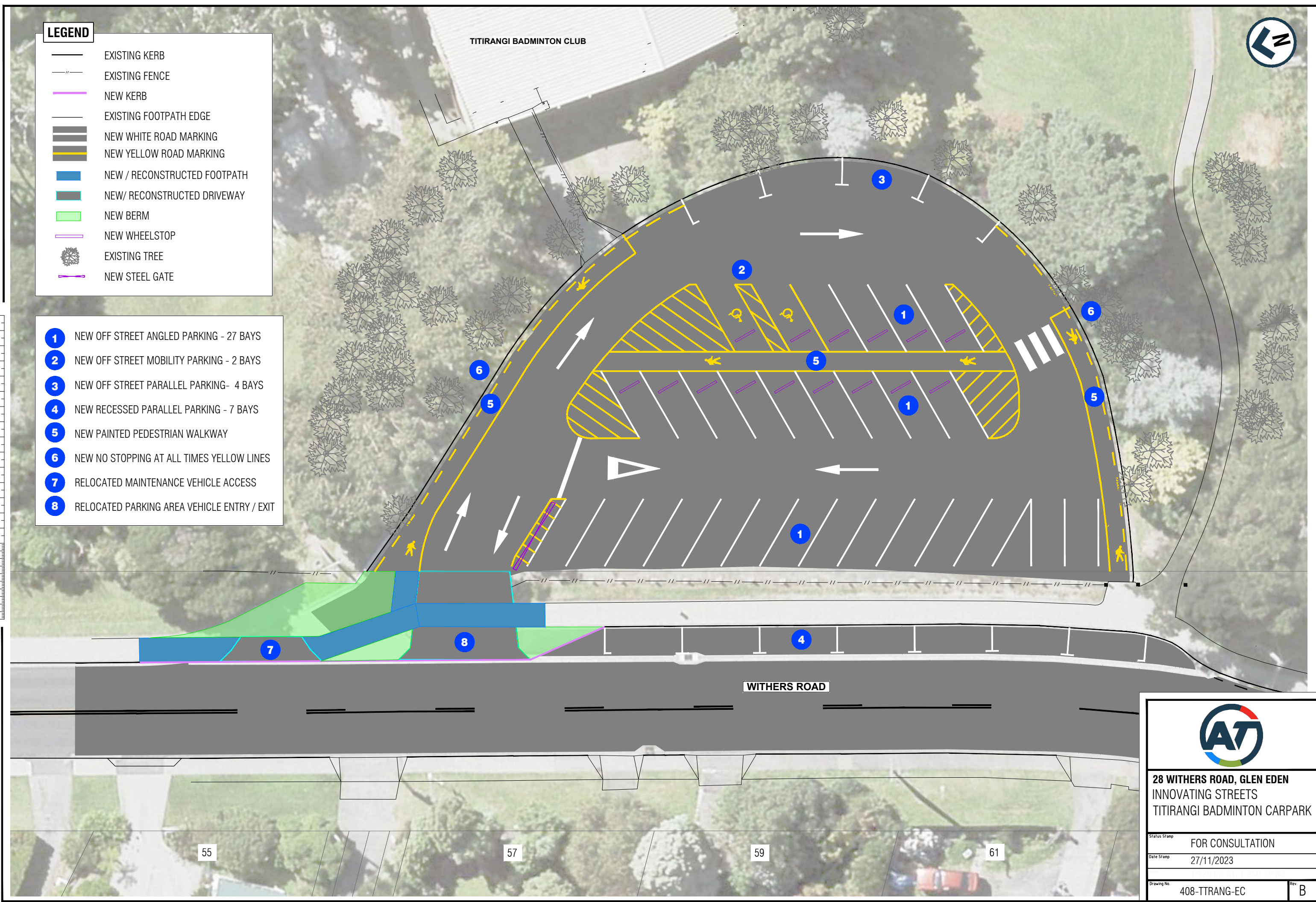

WITHERS ROAD



28 WITHERS ROAD, GLEN EDEN
 INNOVATING STREETS
 TITIRANGI BADMINTON CARPARK

Status Stamp	FOR CONSULTATION	
Date Stamp	27/11/2023	
Drawing No.	408-TTRANG-EC	Rev. B

55

57

59

61