

Signs and Markings Index

SED_NO	Title
SM0000	Signs and Markings index
SM0001	Single pole signs - Kerbed Road
SM0002	Single pole signs upto ## sq m - Unkerbed Road
SM0003	Surface mount socket
SM0004	Guide signs indicative single pole assembly
SM0005	Guide signs indicative multipole assembly
SM0006	Guide signs indicative single pole pile foundation
SM0007	Guide signs indicative single pole pad foundation
SM0008	Guide signs monopole pad foundation
SM0009	School Patrol Arm

Review

1



DATE: March 9, 2022

TDM TECHNICAL STANDARDS

Signs and Markings index

Date:

Document in Review

SED No.

SM0000

Version

A

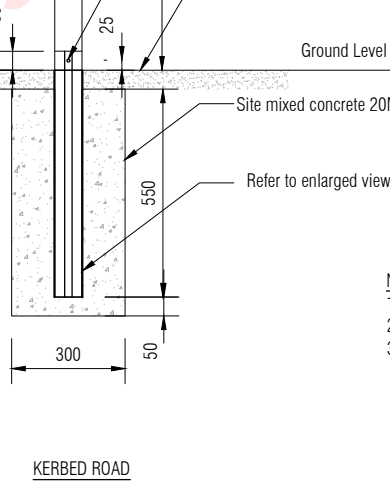
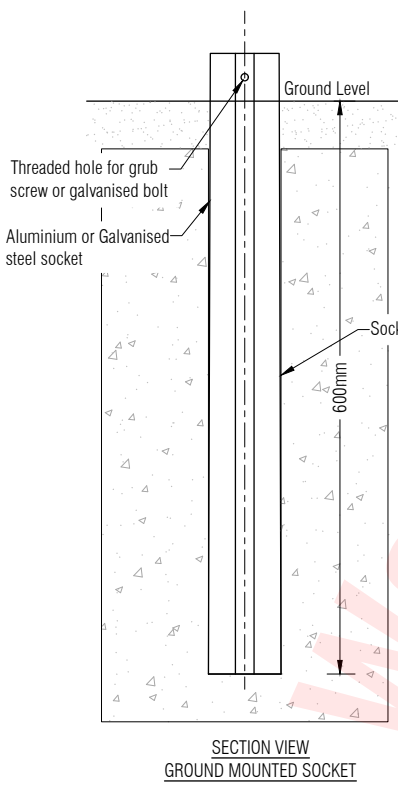
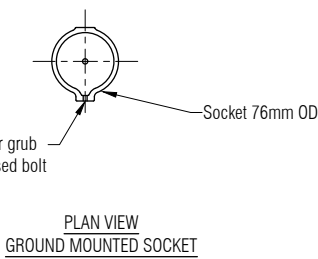
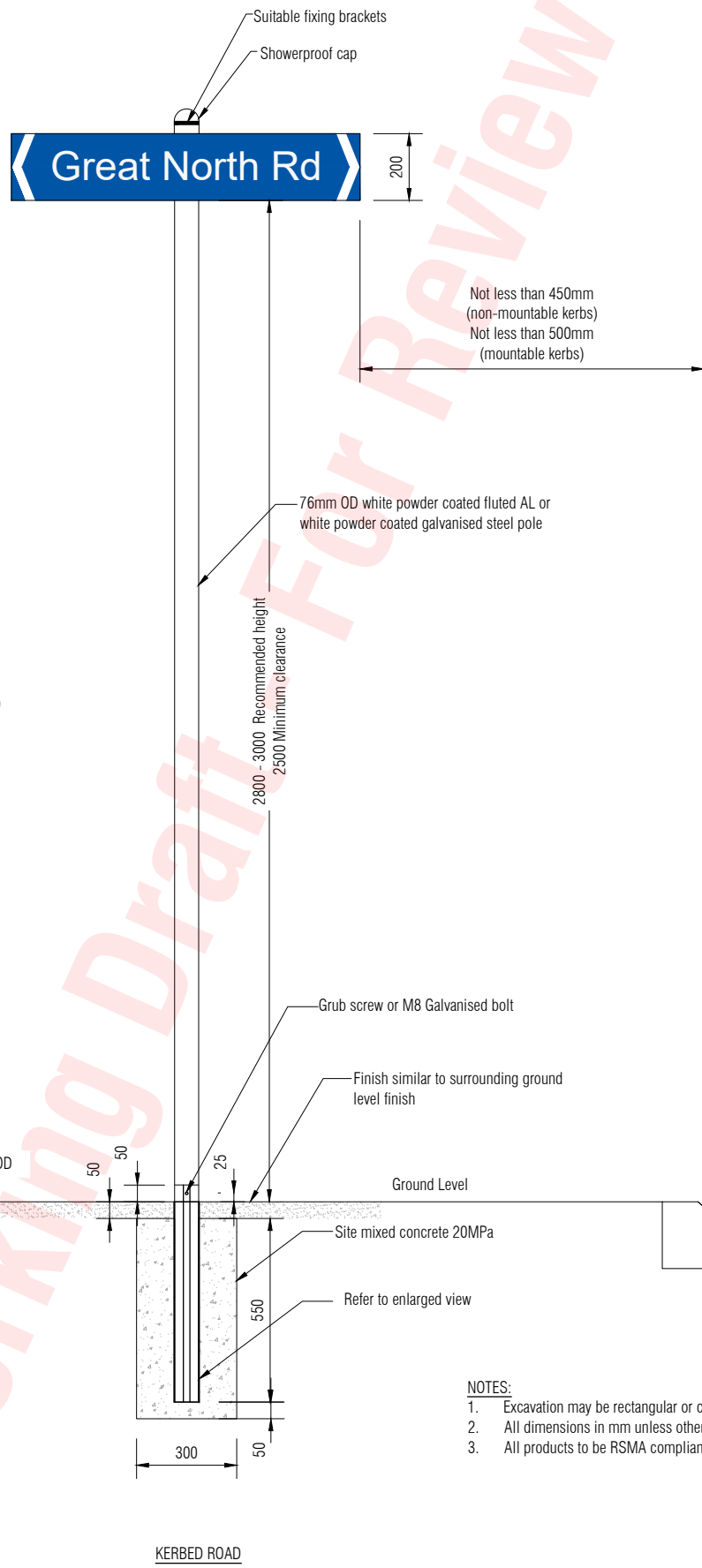

- NOTES:
1. Excavation may be rectangular or circular cross section
 2. All dimensions in mm unless otherwise shown.
 3. All products to be RSMA compliant.

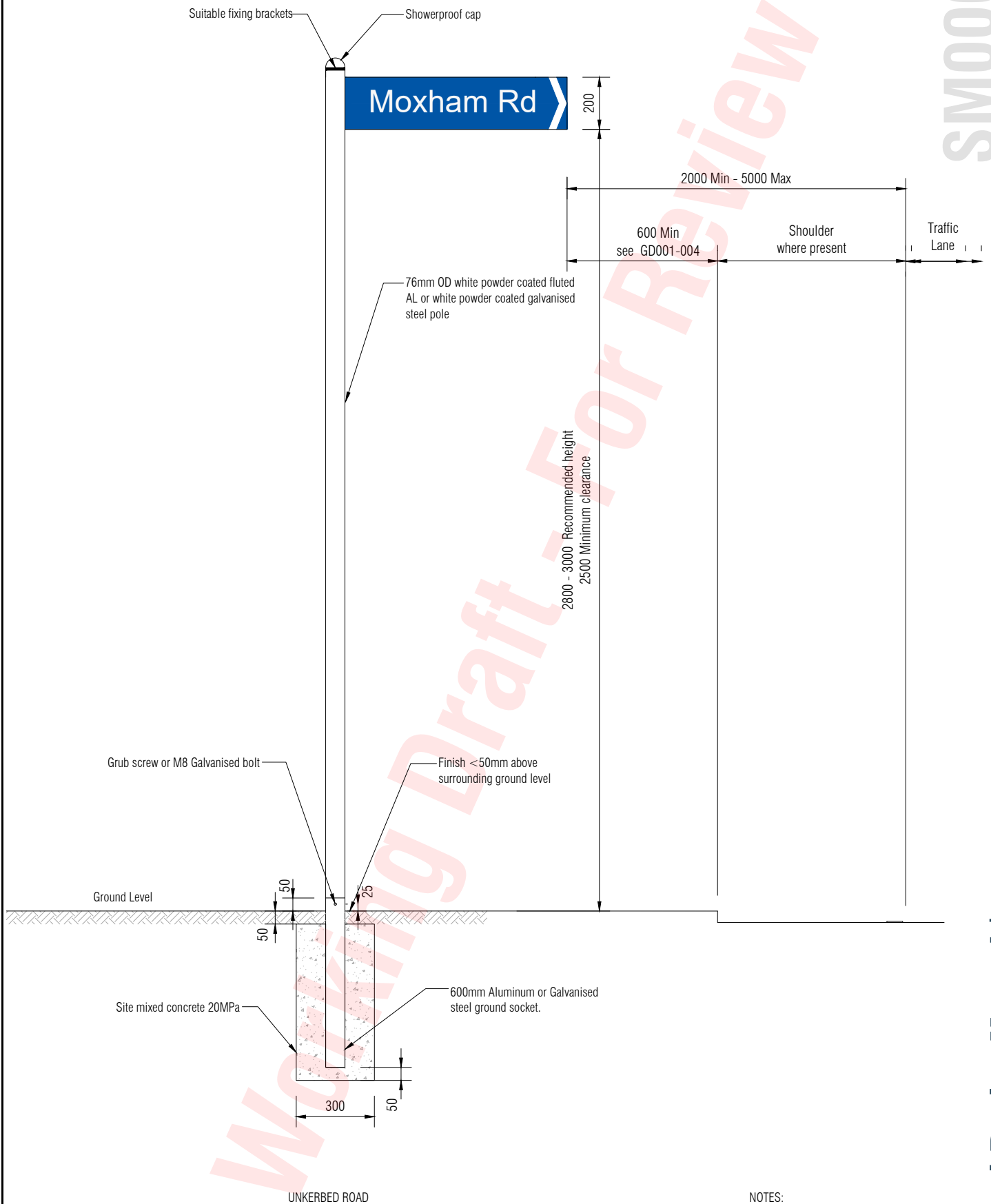

- NOTES:**
1. Excavation may be rectangular or circular cross section
 2. All dimensions in mm unless otherwise shown.
 3. All products to be RSMA compliant.

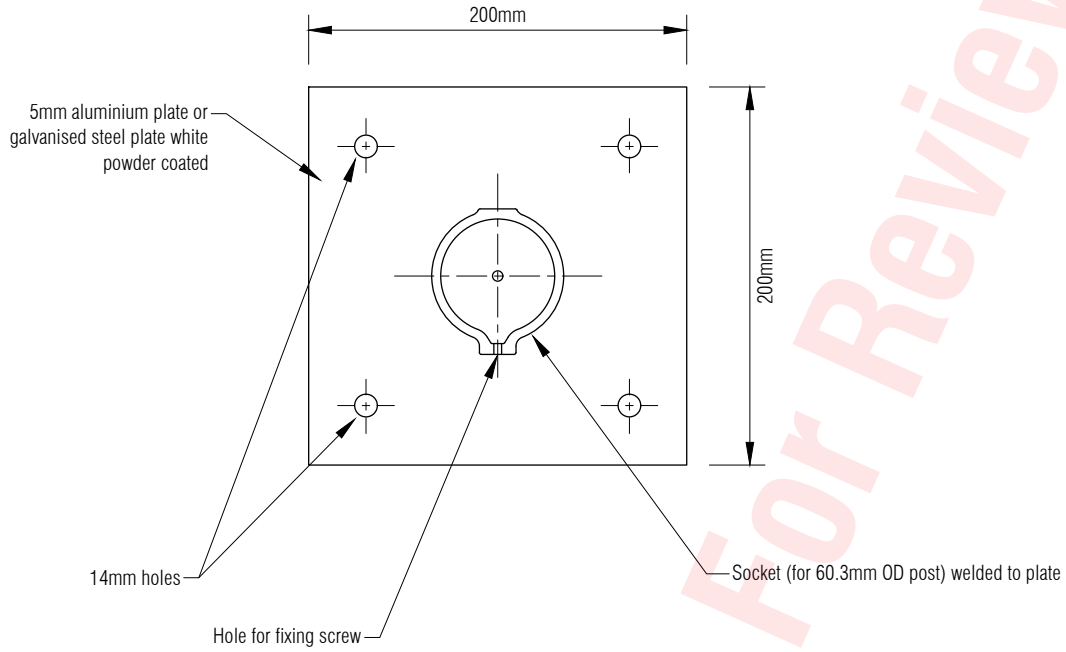

SURFACE MOUNT SOCKET

Must be used for securing to concrete bridges, etc. where no digging is permitted.
 N.B. All components must be powder coated white

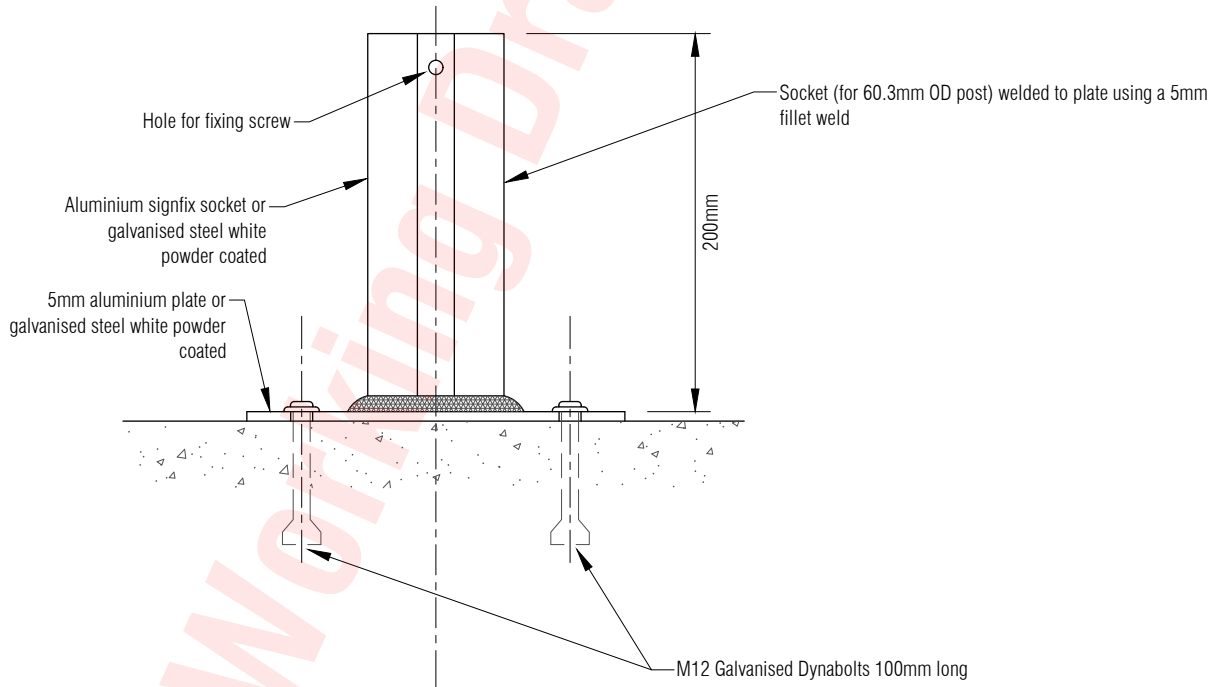

NOTE:

1. All products to be RSMA compliant.

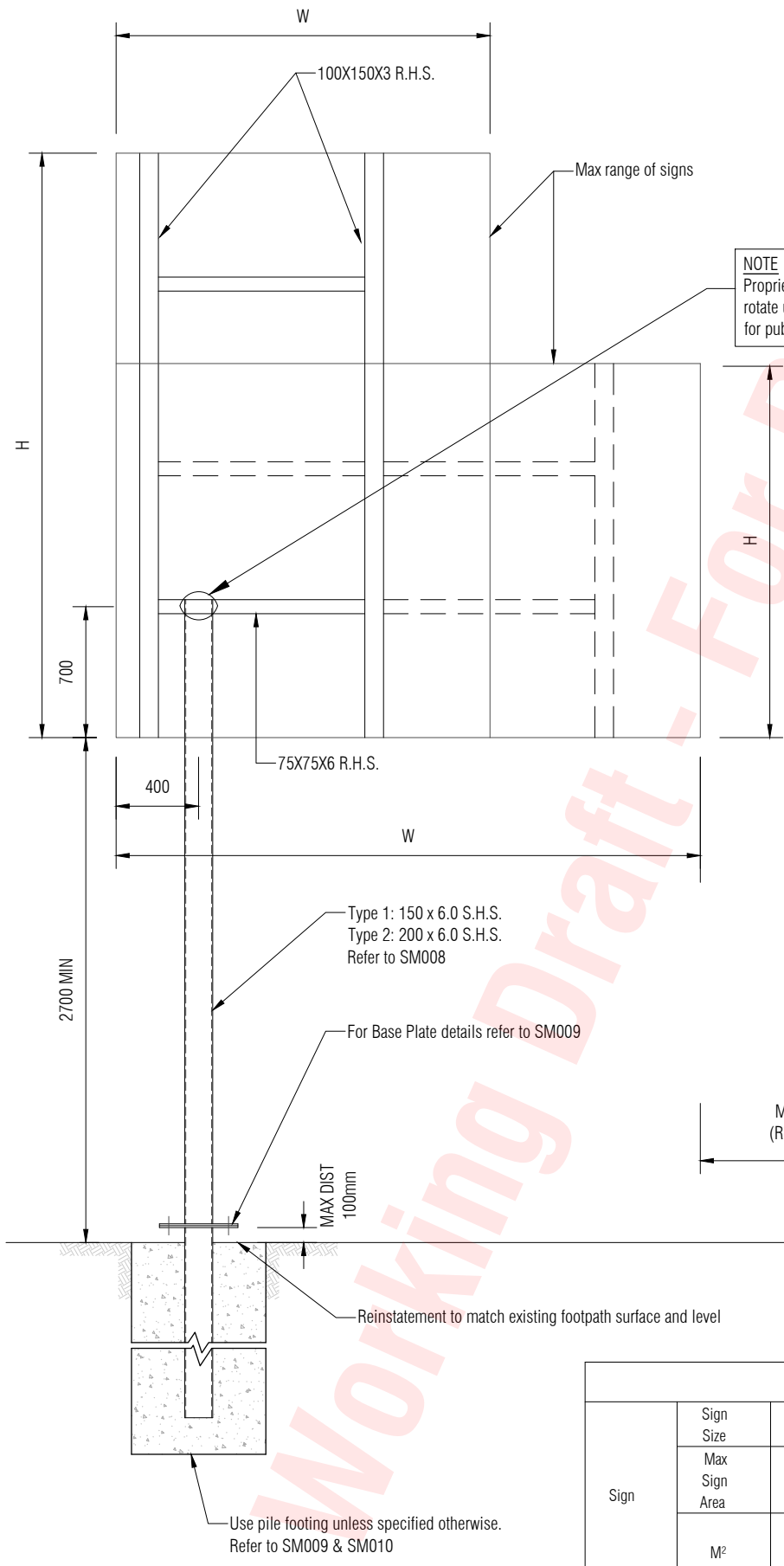

NOTE
 Propriety support and sign provided by sign provider to rotate under impact by high vehicle, leaving structure safe for public and undamaged for reinstatement

- NOTES:**
1. Minimum lateral clearance between the kerb face and edge of the sign to be 500mm.
 2. Minimum lateral clearance between the edge of seal and edge of sign to be 600mm.
 3. Minimum vertical clearance 2500mm
 4. Specific structural design required for Sign, Sign fixings, posts, post-foundation connections and foundation.
 5. Use in speed zones ≤ 70 km/hr.
 6. Locate pole as close as practical to boundary.
 7. Maintain clear footpath width of 1.2m.

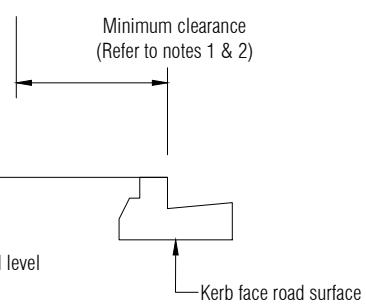

Guide sign schedule					
Sign	Sign Size	Medium		Tall	
	Max Sign Area	$2.5 \geq W/h$	≥ 1.5	$1.5 \geq W/h$	≥ 0.9
	M ²	Max Width (w) m	Max Height (h) m	Max Width (w) m	Max Height (h) m
Type 1	6.25	3.4	1.65	2.55	2.65
Type 2	9.5	4	2.25	3.30	2.85

Use pile footing unless specified otherwise. Refer to SM009 & SM010

Review 1
 DATE: March 9, 2022

TDM TECHNICAL STANDARDS
 Guide signs indicative single pole assembly

Date: **Document in Review**
 SED No. **SM0004** Version **A**

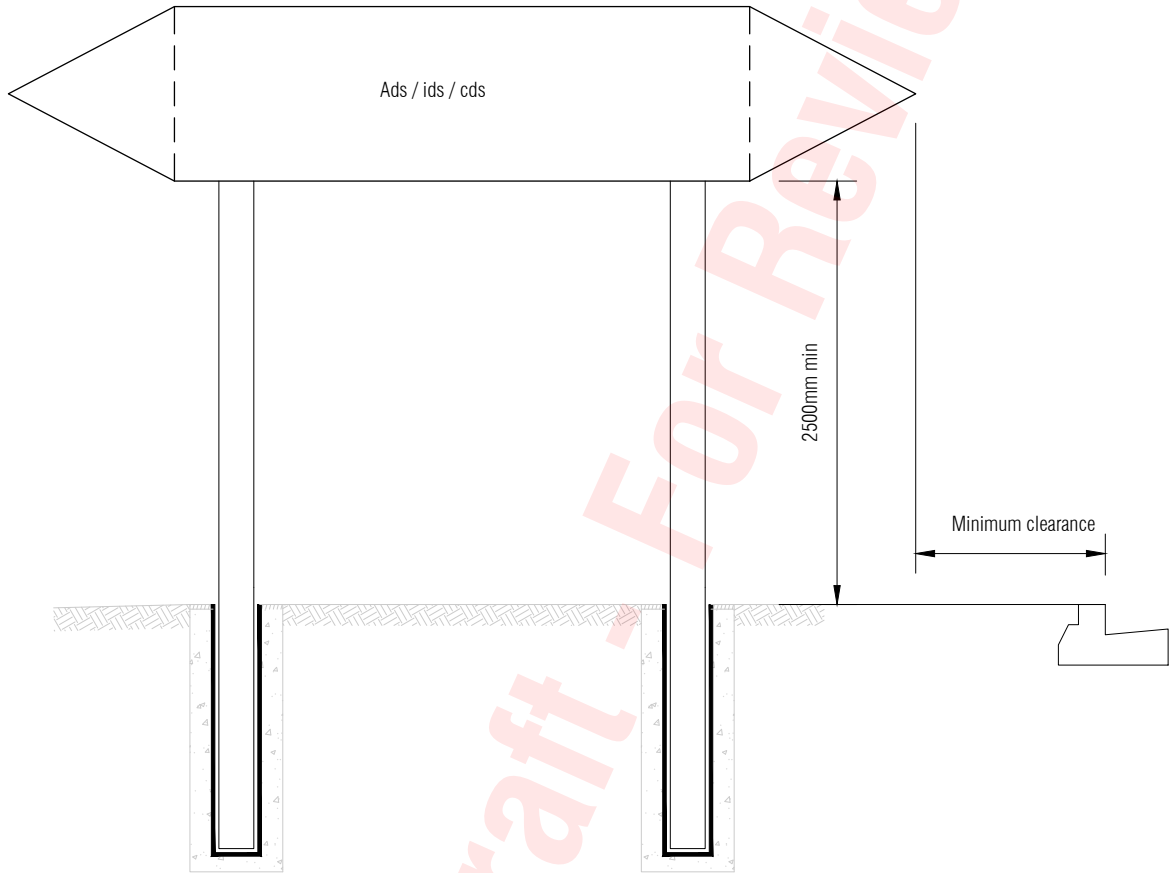

Post & footing selection (diameter & embedment depth) as per appendix b and c of the rsma compliance standard for traffic signs

NOTES:

1. Minimum lateral clearance between the kerb face and edge of the sign to be 500mm.
2. Minimum lateral clearance between the edge of seal and edge of sign to be 600mm.
3. Minimum vertical clearance 2500mm in pedestrian area.
4. Minimum vertical clearance 2100mm on berm areas clear off footpaths and pedestrian.
5. Specific design required for sign, sign fixings, posts, post-foundation connections and foundation.



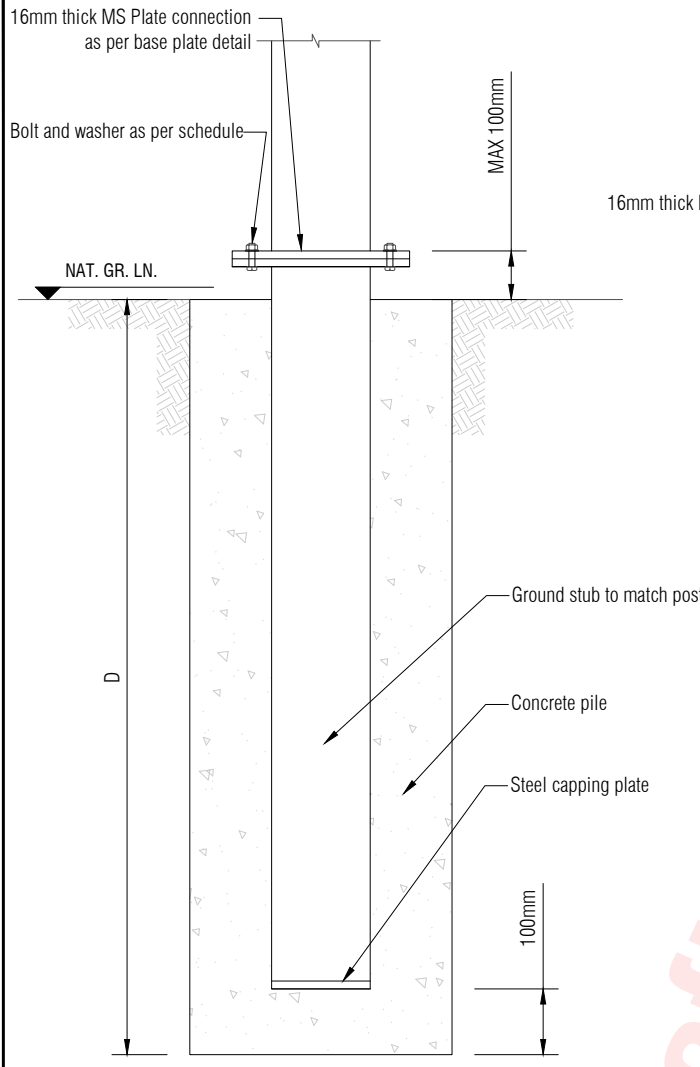

FOR LEVEL SITE

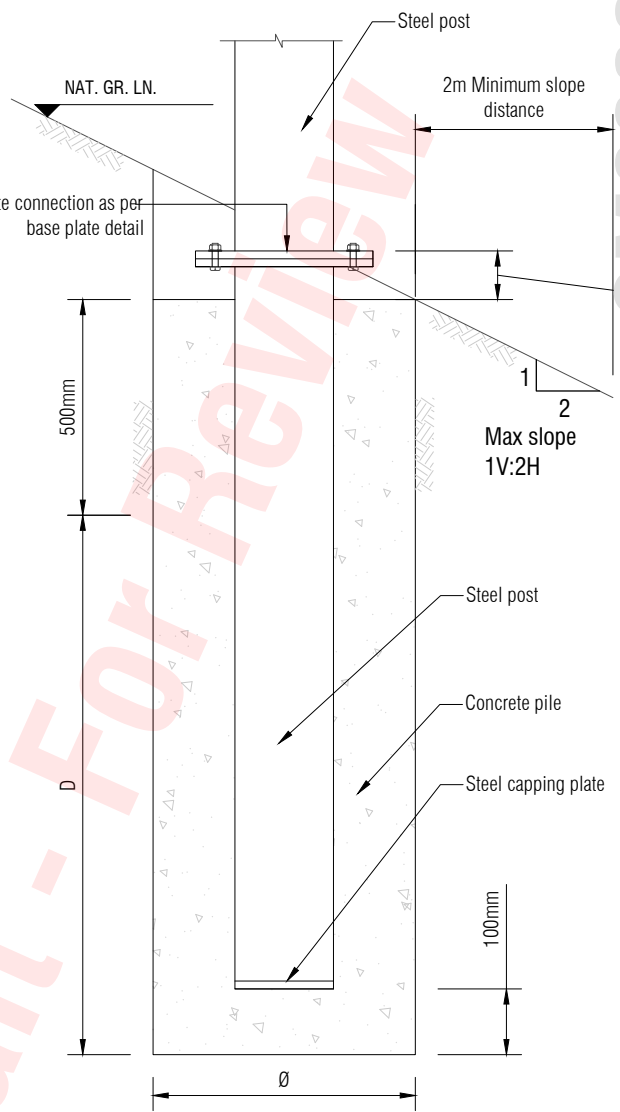

FOR SLOPING SITE

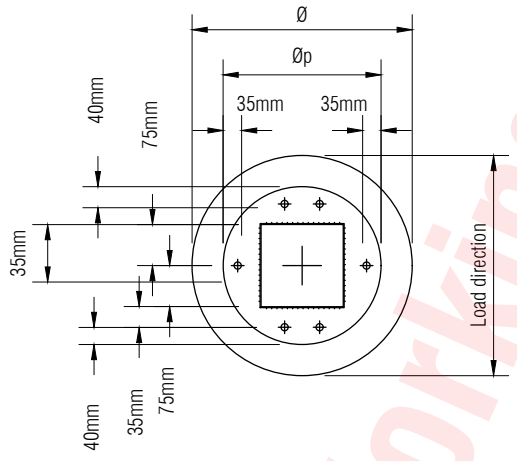

BASE PLATE DETAIL

DESIGN PARAMETERS:

- Above signage has adequate strength and durability, and capable of transferring all design loads to the foundation.
- Dependable undrained shear strength of soil = 50KPa
- Nominal concrete strength of min 20 mpa.
- regional wind speed, $V_{100}=41$ M/S (Region A) - as per AS1170:2002
- Terrain category 2 (for wind load derivation).
- Foundation depth measure from cleared ground level.
- No underground services within the zone of influence of the sign foundation.
- All steel work to be h.d galv. grade 350
- Welds 6mm fwar uno.
- Fixing and washers to be hd galv.
- Based on height to centre of sign of 4.2m
- Specific design required for Sign, Sign fixings, Posts, Post-Foundation connections and Foundation.

FOUNDATION SCHEDULE					
SIGN AREA	DIMENSION			BOLTS	POST
	Depth (D) mm	Diameter(Ø) mm	Base plate Diameter (Øp)		
≤ 6.25	1600	600		6 - M16 8.8/S	150x6 SHS
≤ 9.5	1800	600		6 - M20 8.8/S	200X6 SHS

Review 1

DATE: March 9, 2022

TDM TECHNICAL STANDARDS

Guide signs indicative single pole pile foundation

Date: **Document in Review**

SED No. **SM0006** Version **A**

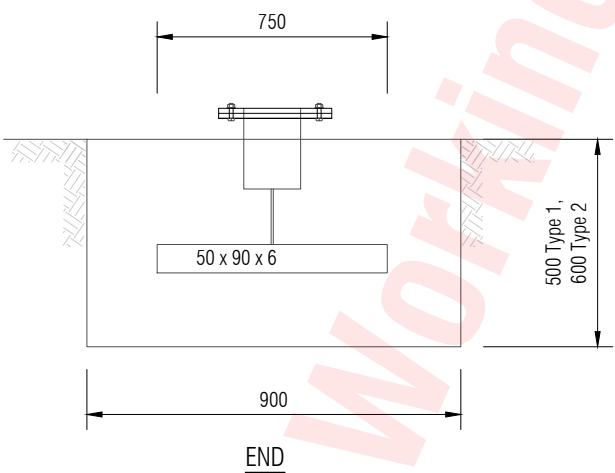
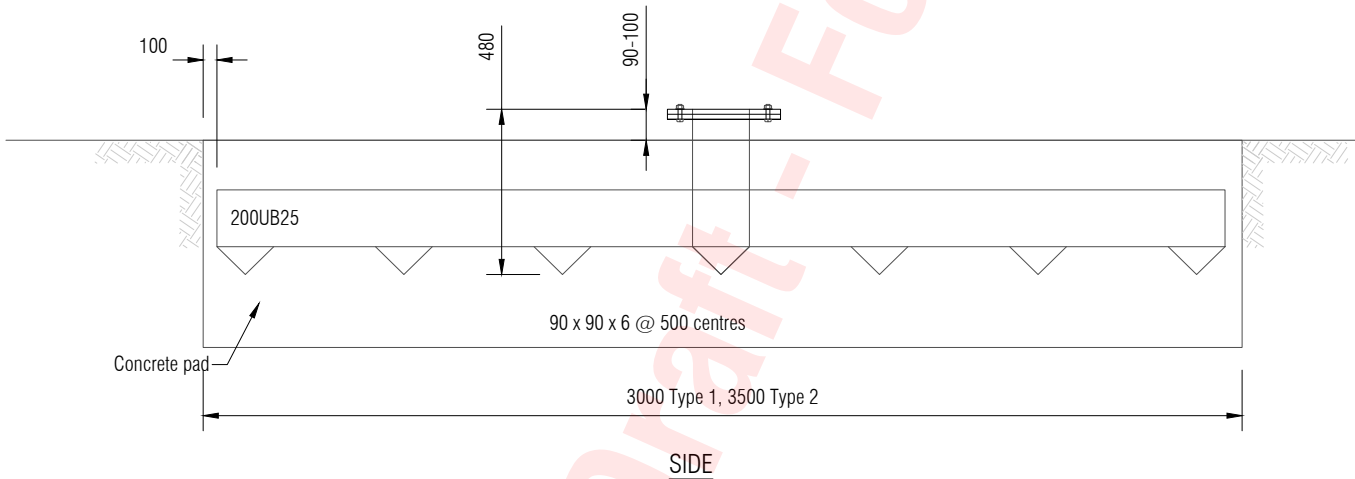
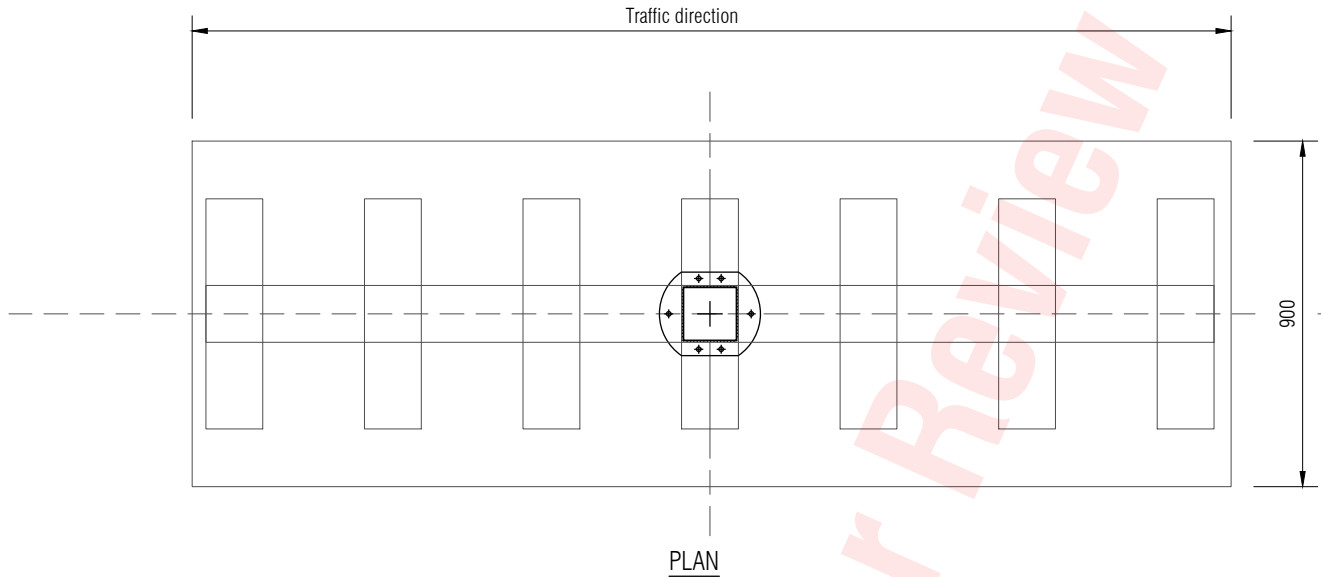

DESIGN PARAMETERS:

1. Above signage has adequate strength and durability, and capable of transferring all design loads to the foundation.
2. Dependable undrained shear strength of soil = 50KPa
3. Nominal concrete strength of min 20 mpa.
4. regional wind speed, V100=41 M/S (Region A) - as per AS1170:2002
5. Terrain category 2 (for wind load derivation).
6. Foundation depth measure from cleared ground level.
7. No underground services within the zone of influence of the sign foundation.
8. All steel work to be h.d galv. grade 350
9. Welds 6mm fwar uno.
10. Fixing and washers to be hd galv.
11. Based on height to centre of sign of 4.2m
12. Specific design required for Sign, Sign fixings, Posts, Post-Foundation connections and Foundation.

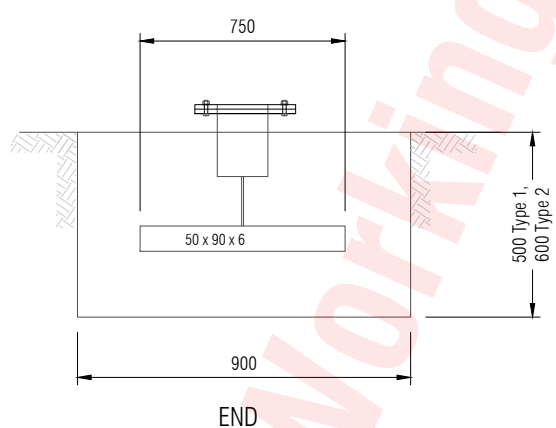
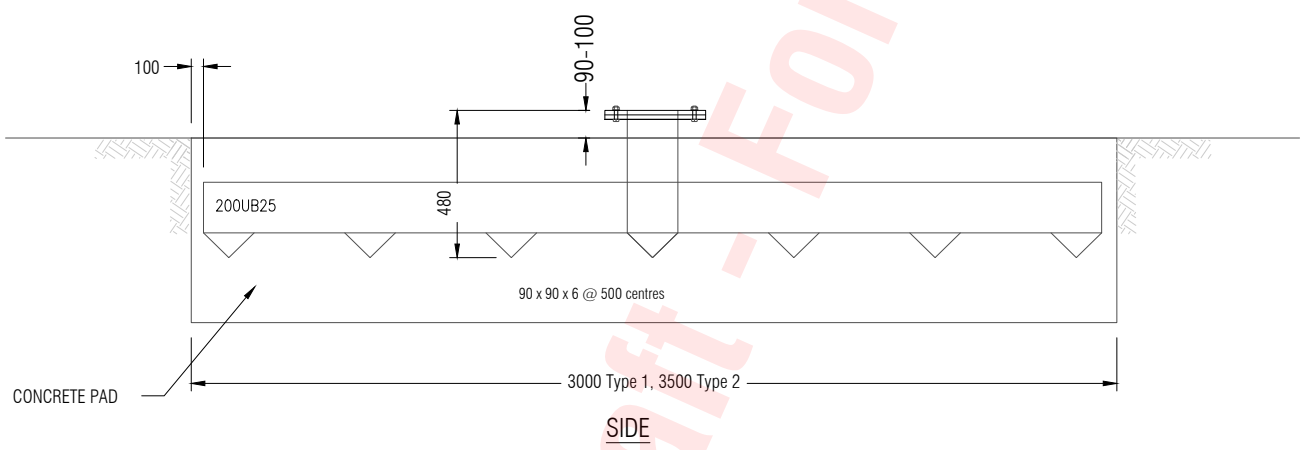
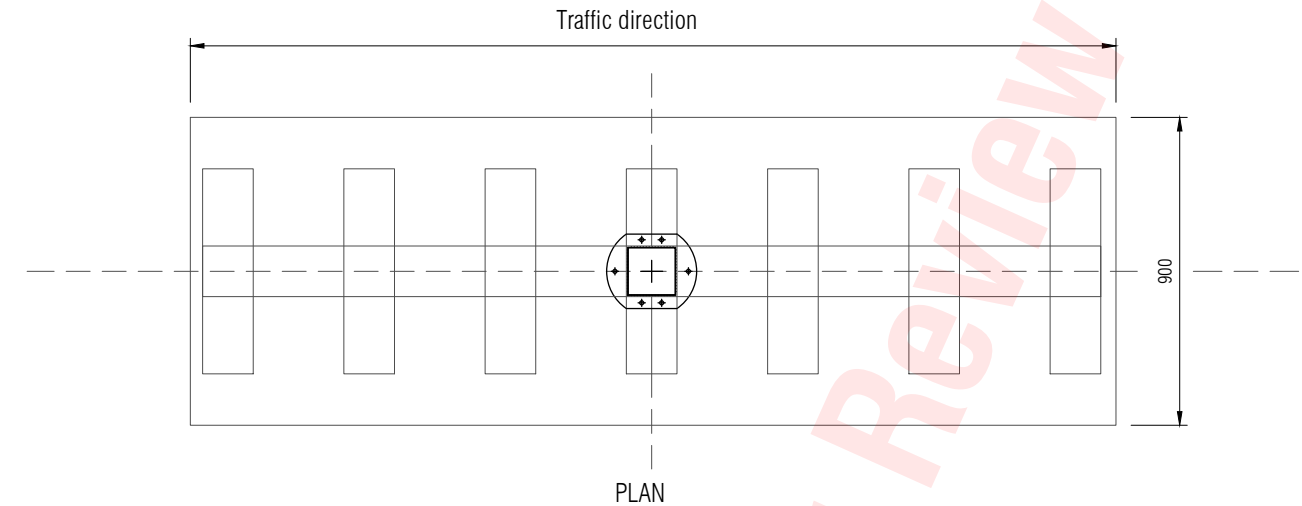

DESIGN PARAMETERS:

1. Above signage has adequate strength and durability, and capable of transferring all design loads to the foundation.
2. Dependable undrained shear strength of soil = 50KPa
3. Nominal concrete strength of min 20 mpa.
4. regional wind speed, V100=41 M/S (Region A) - as per AS1170:2002
5. Terrain category 2 (for wind load derivation).
6. Foundation depth measure from cleared ground level.
7. No underground services within the zone of influence of the sign foundation.
8. All steel work to be h.d galv. grade 350
9. Welds 6mm fwar uno.
10. Fixing and washers to be hd galv.
11. Based on height to centre of sign of 4.2m
12. Producer statement(s) required

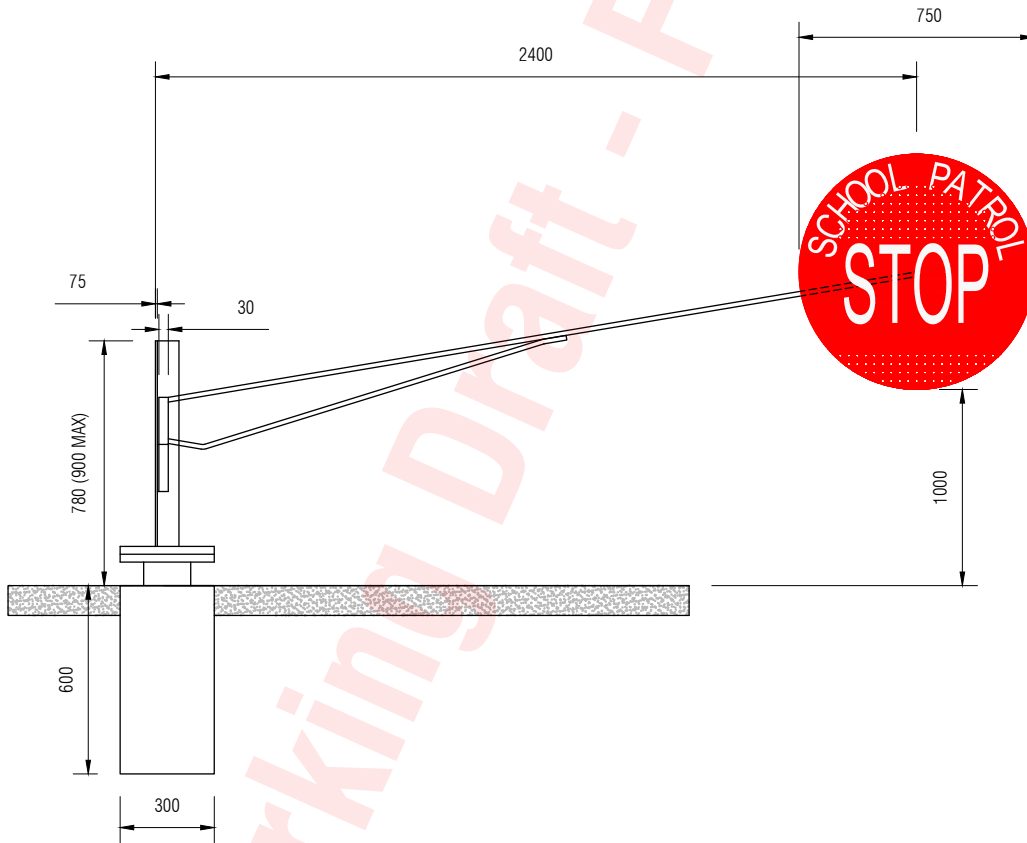
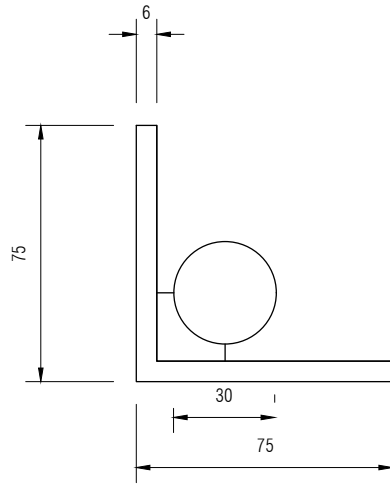

NOTES:

- 1. All dimensions in mm unless otherwise stated
- 2. RG-28 ('school patrol stop') sign must be as per NZTA 'priority school patrol perforated' sign detail

Working Draft - For Review