

FENCE OVER STEEP SECTIONS

A-A

NOTES

1. STEEL TO BE HIGH TENSILE WITH ULTIMATE STRENGTH OF 600-800N/mm .
2. THE RODS ARE TO BE ELECTRICALLY WELDED TO COMPLY WITH NZS 3422:1975.
3. TOLERANCES ON OVERALL DIMENSIONS OF THE FINISHED PANEL TO BE 25mm AND BARS TO BE PLACED WITHIN 2mm OF THEIR TRUE LOCATION.
4. FOLDED PANELS TO BE GALVANISED TO SPECIFICATION CES 306:1992.
5. SHARP EDGES OF THE PANEL ARE TO BE ROUNDED OFF BEFORE GALVANISING.

Alternate Fixing

Post bolted to concrete work,
wall, nib, etc.

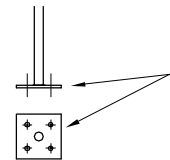

190x190x10mm plate welded to base of
galvanised pipe.
Fixed by 4xM16 dynabolts.



PREPARED BY OPUS:

AUCKLAND CITY
Transport

TYPICAL WIRE
FENCE DETAIL B

SCALE:	NTS
DRAWN:	TA
ISSUE DATE:	11/2008
APPROVED:	
PLAN No.	Issue B
2008/0411	