

Stop ID:
2127

ID:

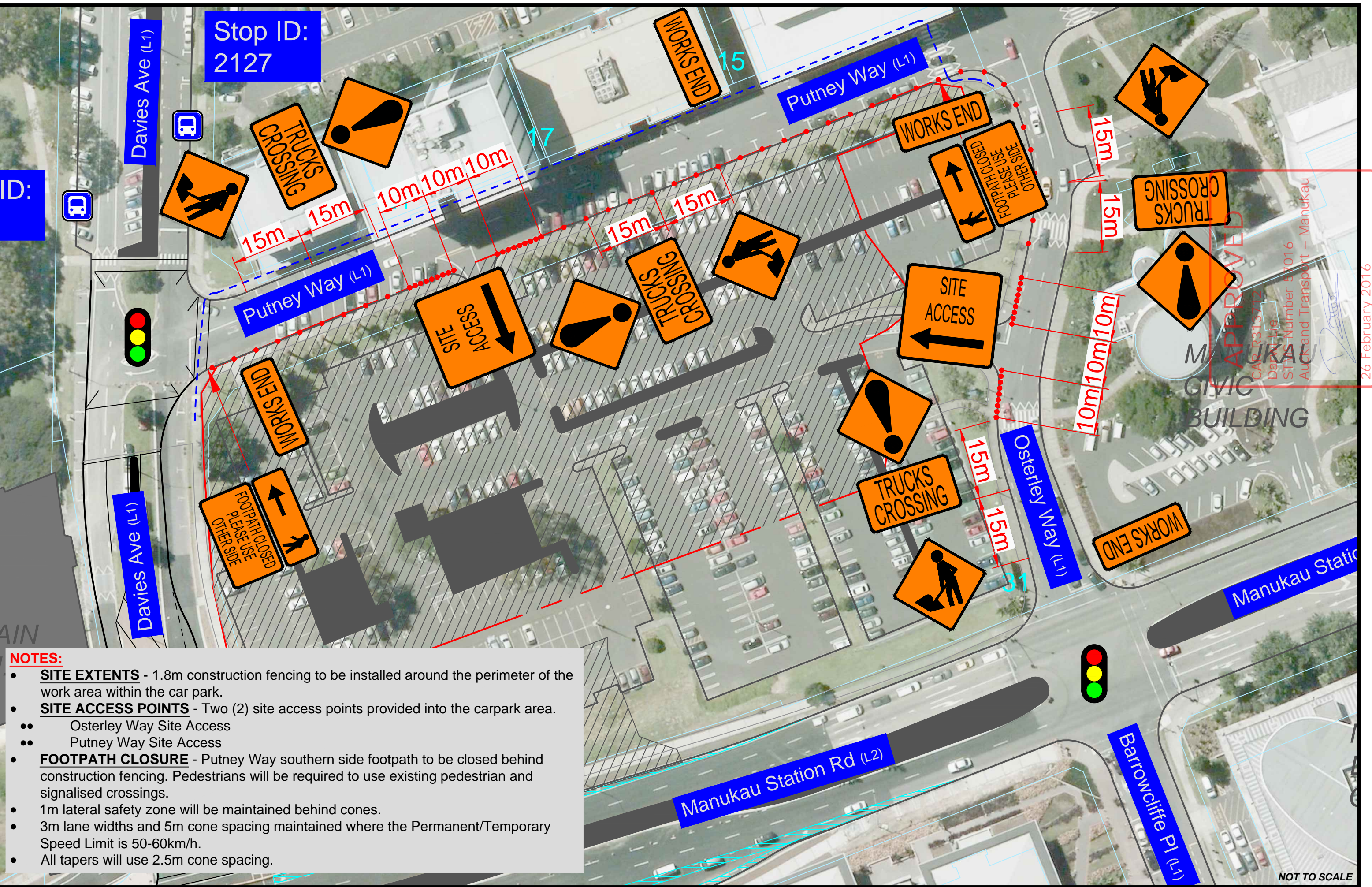

- NOTES:**
- **SITE EXTENTS** - 1.8m construction fencing to be installed around the perimeter of the work area within the car park.
 - **SITE ACCESS POINTS** - Two (2) site access points provided into the carpark area.
 - Osterley Way Site Access
 - Putney Way Site Access
 - **FOOTPATH CLOSURE** - Putney Way southern side footpath to be closed behind construction fencing. Pedestrians will be required to use existing pedestrian and signalised crossings.
 - 1m lateral safety zone will be maintained behind cones.
 - 3m lane widths and 5m cone spacing maintained where the Permanent/Temporary Speed Limit is 50-60km/h.
 - All tapers will use 2.5m cone spacing.



LEGEND

1. [Green dashed box] WORK AREA	4. [Blue line] CONE ARM CONNECTORS
2. [Yellow dashed box] SAFETY ZONE	5. [Blue dashed line] PEDESTRIAN ROUTE
3. [Red dashed line with dots] CONES	6. [Red dashed line] EXTENTS OF ENABLING WORKS
	7. [Red solid line] 1.8m CONSTRUCTION FENCING
	8. [Blue dashed line] CYCLE LANES

DRAWN BY
D.Wignall
ID:19518
28/06/16

TITLE
MANUKAU BUS TRAIN INTERCHANGE
ENABLING WORKS/VEHICLE CROSSING CONSTRUCTION
SITE EXTENTS/SITE ACCESS POINTS

TMP NO 3930	
SHEET 1	REV

NOT TO SCALE

APPROVED

MANUKAU CIVIC BUILDING

CAE R313772
Date: 1/16
STIS Number 57016
Auckland Transport - Manukau

26 February 2016