

TE ATATU & EDMONTON RD CORRIDOR IMPROVEMENTS NEWSLETTER



PROGRESS UPDATE

HELLO TE ATATU,

We have some exciting work coming up in the next few months! Last month, various service connections and switch overs have taken place, and a major retaining wall was completed.

Soon, you will start to see more progress with the actual road widening, which begins on Edmonton Road in late July (more details below).

In early August we will be installing the 2nd stormwater treatment station on Lyndhurst Road. This is a major excavation which will require the closure of the intersection of Lyndhurst Road with Te Atatu Road for approximately 3 weeks.

The purpose of this station is to assist the stormwater upgrade on Te Atatu and Edmonton Road, and reduce stormwater contamination through its filter system.

While this is underway, other service relocations and upgrades will continue along Te Atatu Road and side streets, along with property works, and the construction of essential retaining walls.



CALENDAR

Coming Up

25/07 Pavement works commence on Edmonton Road.

01/08 Closure of Lyndhurst Road intersection with Te Atatu Road:

- Approximately 3 weeks
- 24/7 closure
- Day works
- Detours available via Jaemont & Wakeling Avenue.

PAVEMENT WORKS COMMENCING LATE JULY ON EDMONTON ROAD

Services upgrades and relocations are essentially complete on Edmonton Road, which enables us to get on with the pavement works in this section. There is a sequence to undertaking this work, which put simply is as follows:

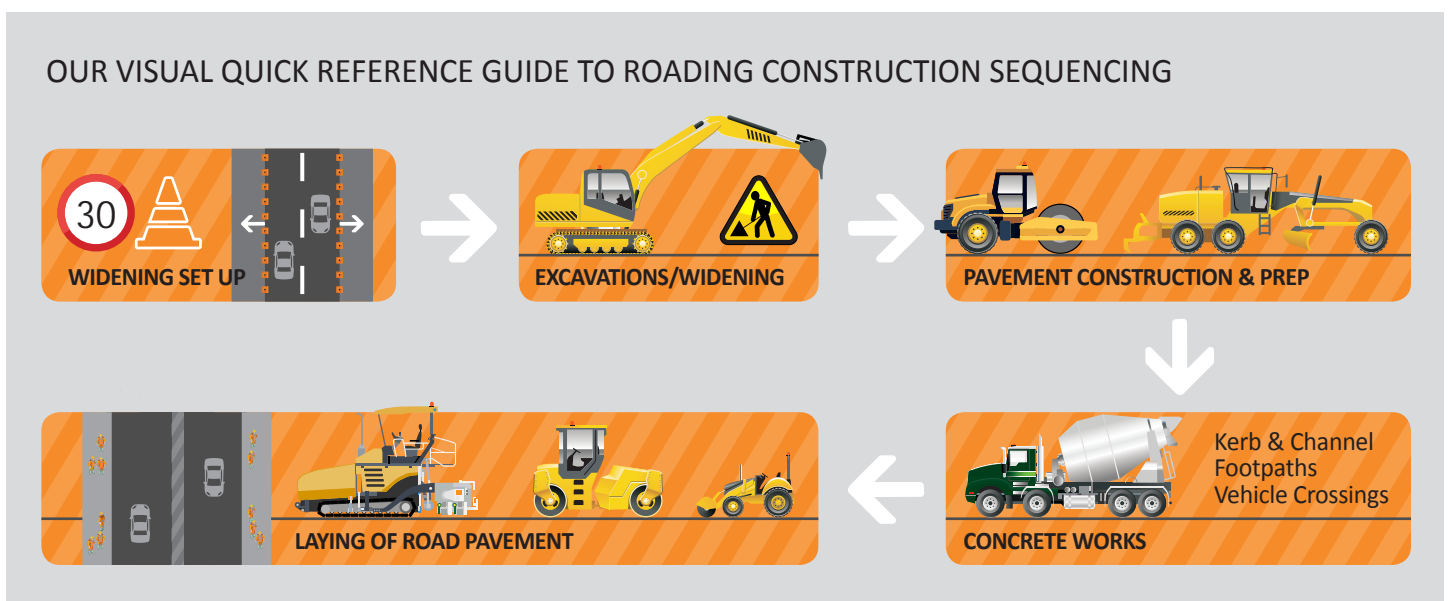

The painted flush median that has been removed on Edmonton Road will compensate for the limited space, and continue to allow two lanes to operate during the day to minimise any further congestion. Works will be undertaken on one side of the road at a time, with some work to be undertaken at night. Directly affected residents will be notified separately.

REMOVAL OF THE LANE

We often get asked why we have removed one northbound lane, when we are not working along the whole stretch. We have crews working in different areas on different days, all in the course of the week.

Causing multiple closures would create more bottlenecks (more merging), and would not increase traffic flow. Also, looking at it from a safety perspective - if the traffic configuration was to change on a daily basis, this would be confusing for motorists, and we would have to revert back to traffic cones, which create their own hazard when they are knocked over on the road.

The closure of the lane allows us to get in and work when and where we can. Sometimes it may not look like it, but we are utilising the closed lane for multiple works, and for multiple crews.

BUILDING THE ROAD - PROGRESS OF STAGES

TENTATIVE COMPLETION

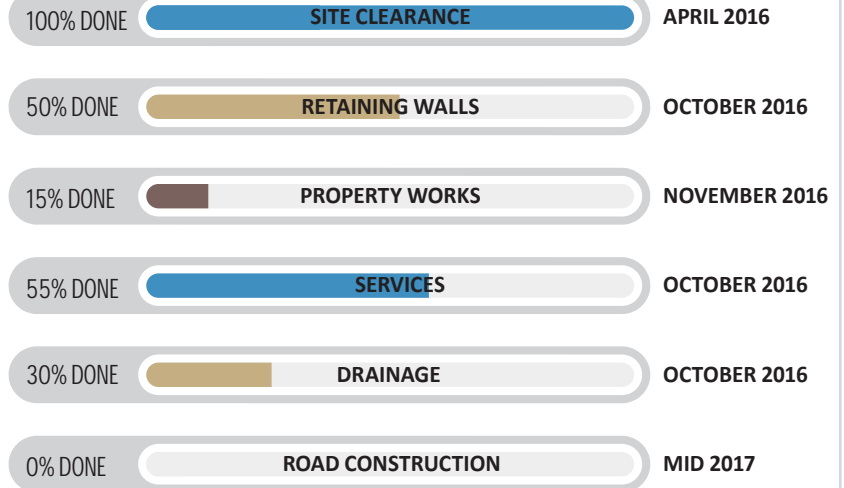

WINTER SEASON... STAY SAFE TE ATATU!

Some of the activities that we undertake are limited during the wet season, however will endeavour to continue to work wherever and whenever we can.

Our team will soldier on through this weather, but if conditions become hazardous then they will stop, so at times you may see reduced activities during winter months.

Winter poses its own set of risks to both our team and the public, so please take extra care out there.

MOTORISTS



SLIPPERY WHEN WET!

WEATHER



DRIVE TO THE CONDITIONS



STAY SAFE
this winter...

PEDESTRIANS



STAY WARM AND DRY

TAKE CARE



REDUCED VISIBILITY

PEDESTRIANS AND CYCLISTS



STAY BRIGHT!

Questions: **Higgins Contractors Ltd**
Contact: Samantha
P: 09 273 7300
E: S.Irvine@higgins.co.nz

Auckland Transport
Contact: Greg Horne
P: 09 355 3553
E: G.Horne@at.govt.nz

NZ TRANSPORT AGENCY
WAKA KOTAHĪ
HIGGINS



Thank you for your patience during the project so far.