

09 March 2017

Ponsonby Pedestrian Improvement Project

STAGE 2 Ponsonby Rd and Mackelvie St



Construction begins

Work to create a more attractive and pedestrian-friendly street environment in Ponsonby Road and Mackelvie Street is set to begin on Tuesday 14 March.

Work includes street landscaping with new street furniture and new lighting, footpath widening and the introduction of speed tables across Mackelvie Street. This work comprises Stage 2 of the Ponsonby Road Pedestrian Improvements programme funded by the Waitematā Local Board and Auckland Transport (AT). The overall project will be delivered by Downer NZ in several stages. The work will be staggered to work around key events in Ponsonby to the end of April, including the World Masters Games.

The changes are aimed at creating a safer, more appealing environment for pedestrians, improved pedestrian connectivity across the roads and space for street furniture or other amenities. They will also help slow down vehicles turning into and out of side streets.

What to expect

Mackelvie Street intersection will be reduced to one way traffic for the duration of work.

Downer NZ will need to excavate parts of the road. Because of this, traffic cones, signs and fencing will stay in place overnight to keep people safe.

Stage 2	Starting from Tuesday 14 March and will finish early April
Work Times	Our standard hours of work are Monday—Saturday 7am—7pm
Where	Please see map over page
Traffic Management Safety	<ul style="list-style-type: none">• Please see overleaf, this alters for each stage• During work hours, traffic controllers will assist vehicles and pedestrians to move safely through the work site• Pedestrian detours will be in place. Please take care and follow detour signs.
Weather and below ground conditions	Unforeseen circumstances such as weather and below ground conditions may impact the project timeframes.
Environment	We will try to keep noise and dust to a minimum.
Construction Contacts	Downer Stakeholder Manager: Carol Moffatt 09 580 4900 or email carol.moffatt@downer.co.nz
For Project Information	Visit www.AT.govt.nz or call Auckland Transport on (09) 355 3553.

Auckland Transport, the Waitematā Local Board and Downer NZ would like to thank you for your patience while we carry out this work

Stage 2 – Mackelvie Street work details

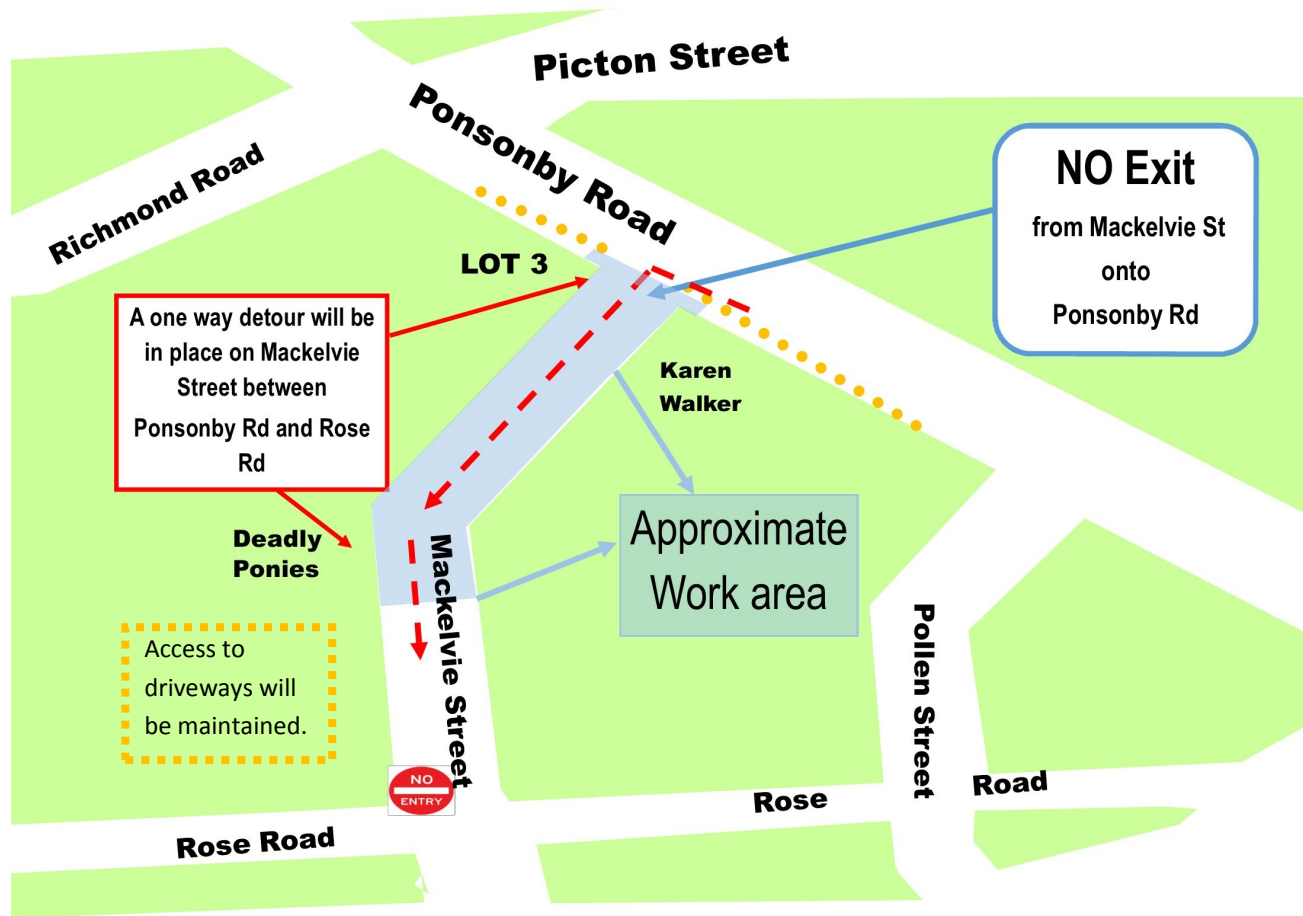

Image is not to scale

What are we doing:

Ponsonby Road and Mackelvie Street intersection

Work includes but is not limited to:

- Footpath widening
- Construction of two raised speed tables across Mackelvie Street
- Landscaping and installing street furniture like seating and cycle racks
- Installing new street lighting

Traffic and pedestrian impact

- Mackelvie Street will be one way from Ponsonby Road to Rose Road. This means no exit from Mackelvie Street onto Ponsonby Road.
- Driveway and pedestrian access to businesses will be maintained.
- Some on-street parking will be restricted around the worksite.
- Traffic management including signs and posted pedestrian and vehicle detours will be in place.