

ORIGINAL SIZE A1

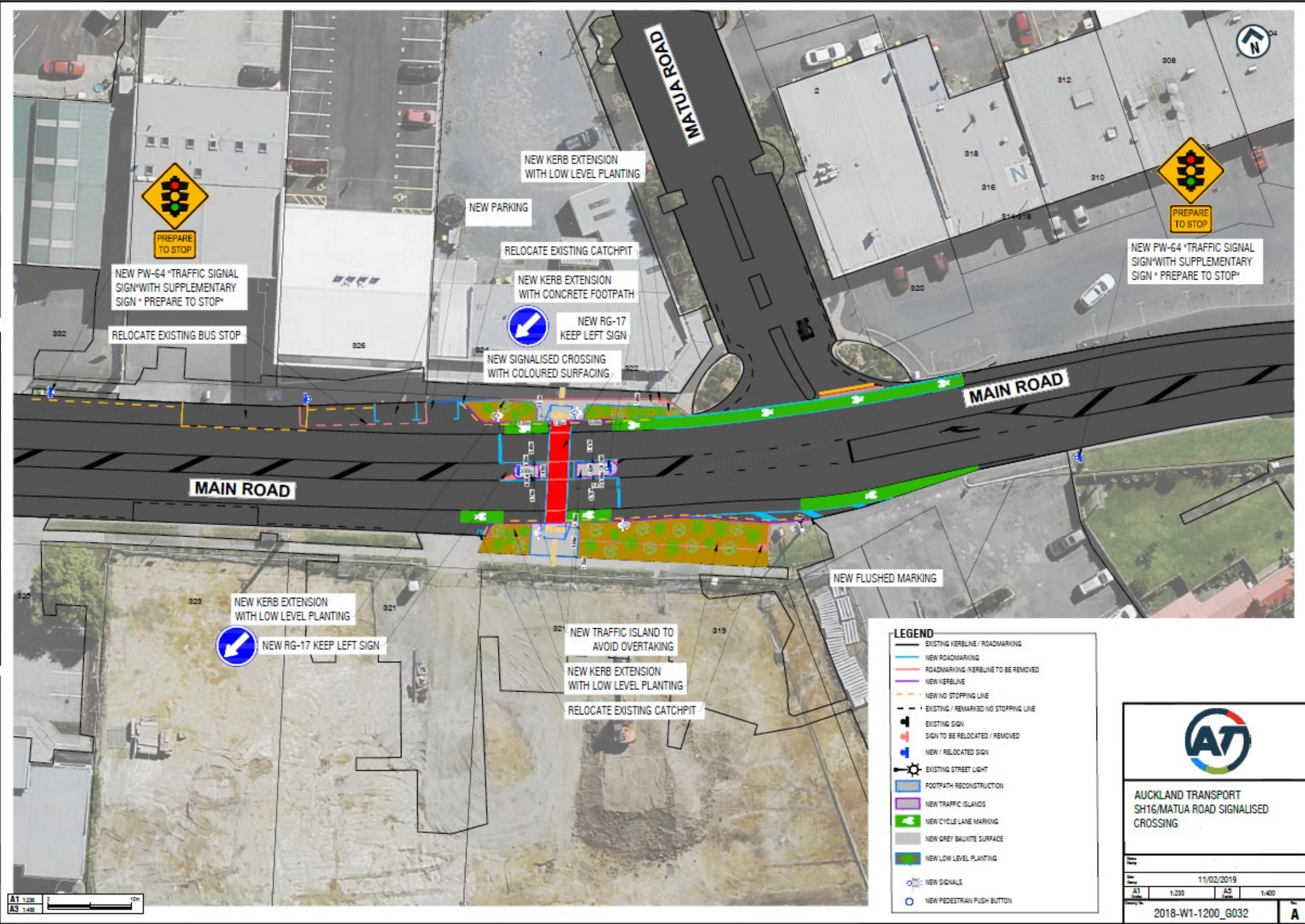

NEW PW-64 \*TRAFFIC SIGNAL SIGN\* WITH SUPPLEMENTARY SIGN \* PREPARE TO STOP\*



RELOCATE EXISTING BUS STOP

NEW KERB EXTENSION WITH LOW LEVEL PLANTING

NEW PARKING

RELOCATE EXISTING CATCHPIT

NEW KERB EXTENSION WITH CONCRETE FOOTPATH

NEW RG-17 KEEP LEFT SIGN

NEW SIGNALISED CROSSING WITH COLOURED SURFACING



NEW PW-64 \*TRAFFIC SIGNAL SIGN\* WITH SUPPLEMENTARY SIGN \* PREPARE TO STOP\*



MAIN ROAD

MAIN ROAD

MATUA ROAD

NEW KERB EXTENSION WITH LOW LEVEL PLANTING



NEW RG-17 KEEP LEFT SIGN

NEW TRAFFIC ISLAND TO AVOID OVERTAKING

NEW KERB EXTENSION WITH LOW LEVEL PLANTING

RELOCATE EXISTING CATCHPIT

NEW FLUSHED MARKING

**LEGEND**

- EXISTING KERBLINE / ROADMARKING
- NEW ROADMARKING
- ROADMARKING / KERBLINE TO BE REMOVED
- NEW KERBLINE
- NEW NO STOPPING LINE
- EXISTING / REMARKED NO STOPPING LINE
- EXISTING SIGN
- SIGN TO BE RELOCATED / REMOVED
- NEW / RELOCATED SIGN
- EXISTING STREET LIGHT
- FOOTPATH RECONSTRUCTION
- NEW TRAFFIC ISLANDS
- NEW CYCLE LANE MARKING
- NEW GREY BAUXITE SURFACE
- NEW LOW LEVEL PLANTING
- NEW SIGNALS
- NEW PEDESTRIAN PUSH BUTTON



AUCKLAND TRANSPORT  
SH16/MATUA ROAD SIGNALISED  
CROSSING

Date Issued		11/02/2019	
Scale	A1	A2	A4
	1:200	1:400	1:400
2018-W1-1200_G032			
			A

A1 1:200  
A2 1:400