

200mm DO NOT SCALE - IF IN DOUBT, ASK
150
100
90
80
70
60
50
40
30
20
10
0
ORIGINAL SIZE A1

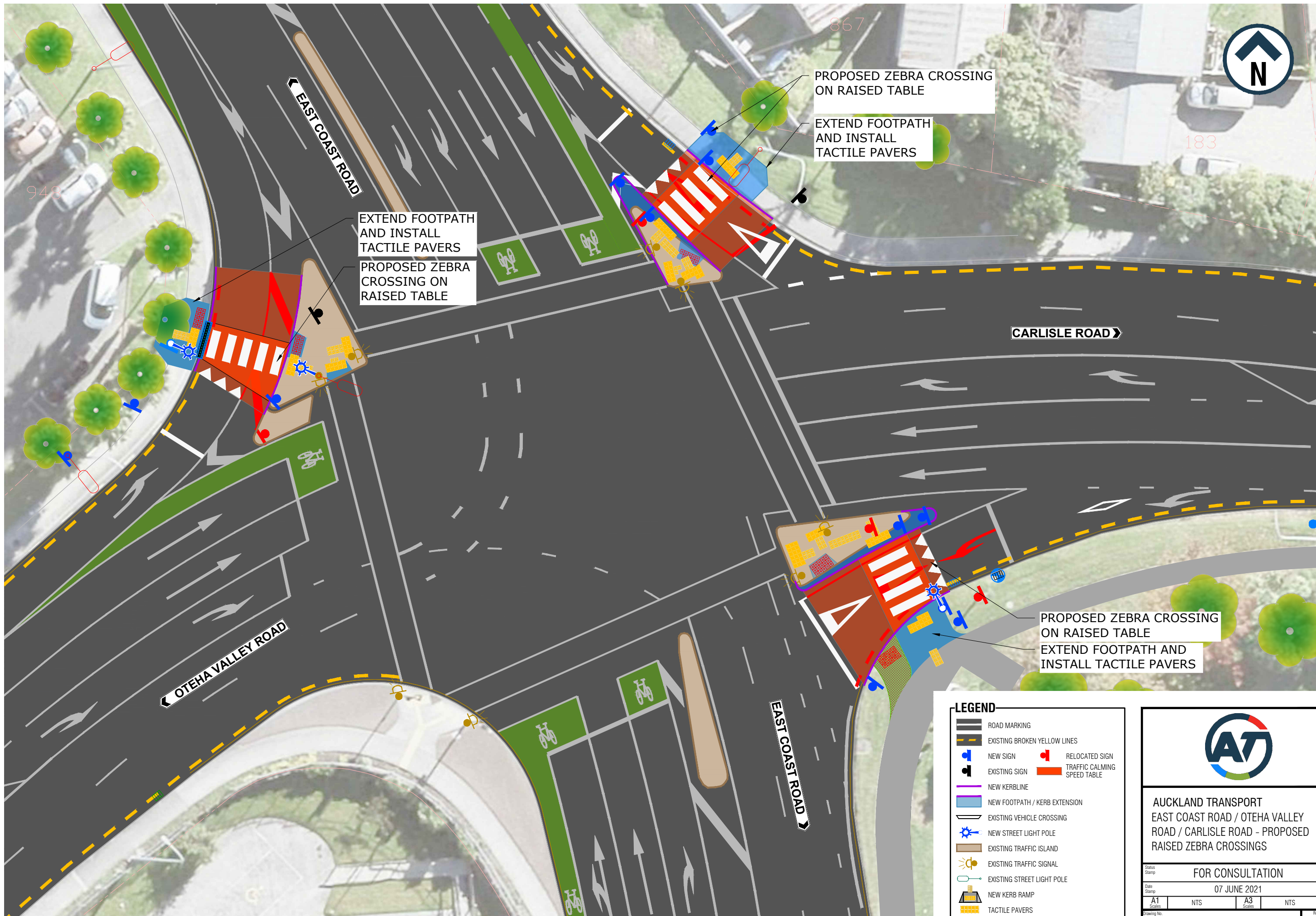

EXTEND FOOTPATH AND INSTALL TACTILE PAVERS
PROPOSED ZEBRA CROSSING ON RAISED TABLE

PROPOSED ZEBRA CROSSING ON RAISED TABLE
EXTEND FOOTPATH AND INSTALL TACTILE PAVERS

PROPOSED ZEBRA CROSSING ON RAISED TABLE
EXTEND FOOTPATH AND INSTALL TACTILE PAVERS

LEGEND

	ROAD MARKING		RELOCATED SIGN
	EXISTING BROKEN YELLOW LINES		TRAFFIC CALMING SPEED TABLE
	NEW SIGN		
	EXISTING SIGN		
	NEW KERBLINE		
	NEW FOOTPATH / KERB EXTENSION		
	EXISTING VEHICLE CROSSING		
	NEW STREET LIGHT POLE		
	EXISTING TRAFFIC ISLAND		
	EXISTING TRAFFIC SIGNAL		
	EXISTING STREET LIGHT POLE		
	NEW KERB RAMP		
	TACTILE PAVERS		



AUCKLAND TRANSPORT
EAST COAST ROAD / OTEHA VALLEY ROAD / CARLISLE ROAD - PROPOSED RAISED ZEBRA CROSSINGS

FOR CONSULTATION

Date Stamp: 07 JUNE 2021

A1	NTS	A3	NTS
----	-----	----	-----

Drawing No. J002312-CS001

Rev. **A**