

ACCDoc\Mot\_MacDonald\419032-PT Chevalier\Drawings\0100-0199 General Arrangement\419032-MMD-XX-00-DR-C-0110.dwg Mar 6, 2022 - 6:04PM

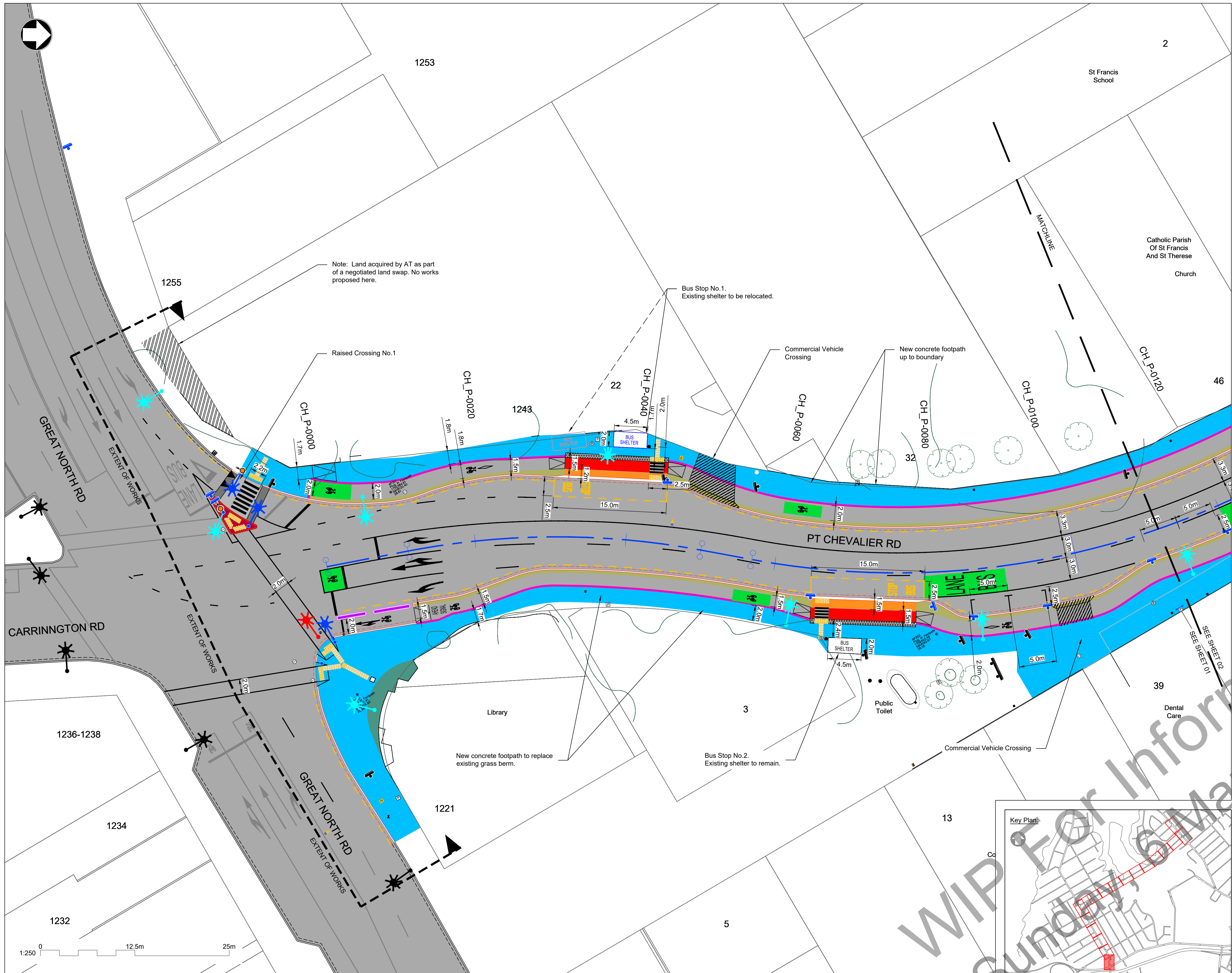

Notes:

1. This drawing is to be read in conjunction with all supplied drawings and design documentation.
2. All dimensions are in meters (unless noted otherwise).
3. Do not obtain dimensions from scaling.
4. Chainages shown on plan are in meters.
5. Drawing projection and coordinates are in terms of New Zealand Transverse Mercator circuit (NZTM) 2000.
6. Levels shown are to Auckland 1946 local vertical datum.
7. Background imagery sourced from Nearmap™ in 2020.
8. Proposed trees to be confirmed with finalised 2D design.

Legend:

General Arrangement:

- Pt Chevalier Rd Control Line
- Meola Rd Control Line
- Garnet Road Control Line
- Existing Property Boundary
- Existing Kerb & channel to remain
- Proposed Kerb & channel
- Existing Building Outlines (surveyed)
- Proposed Cycle Path Surfacing at Bus Stops
- Proposed Cycle Path Markings
- Proposed Cycle/Ped Separation Kerb (Type 2 unless stated otherwise)
- Proposed Concrete Buffer
- Proposed Island
- Proposed Bus Stop Passenger Wait Zone
- Proposed Planting Zone
- Proposed Warning Tactile Treatment (Yellow)
- Proposed Warning Tactile Treatment (Green)
- Proposed Warning Tactile Treatment (Type 3 Separator)
- Proposed Directional Tactile Treatment
- Proposed Vehicle Crossing (Reinforced or Commercial Construction where indicated)
- Proposed Cycle Path
- Proposed Footpath
- Grass to be retained
- Proposed Grass Berm
- Existing Trees / Vegetation
- Proposed Shared Path
- Approximate Edge of closed landfill
- Traffic Signs (Existing / New)
- Cycle Parking (as TDM Technical Standards Detail CY0002A Sheffield Type with Scratch protection on top rail)
- On Road Lane Separator as CY0005A 600mm Wide
- Existing Pole and Luminaire to remain
- New Pole and Luminaire
- Existing Pole with New Luminaire
- Existing Pole decommissioned and removed
- Existing Pole relocate retrofit

SKETCH / WORK IN PROGRESS

DRAWING  
Civils - General Arrangement Plan  
Sheet 1 of 18

DRAWING NO. 419032-MMD-XX-00-DR-C-0110 C1  
C  
SCALE (A1) 1:250

REV	DESCRIPTION	DATE
A	Detailed Design - Draft for Comment	29/09/2020
B	For Stage 1 Tender	18/11/2020
C1	FOR INTERNAL USE ONLY / Work in Progress	6/03/2022

DRAWING Q.A.

WORK IN PROGRESS  
DRAWING

DO NOT SCALE OFF THIS DRAWING.  
VERIFY ALL DIMENSIONS ON SITE  
BEFORE COMMENCING ANY WORK.

CLIENT



PROJECT  
POINT CHEVALIER TO WESTMERE CYCLEWAY

PROJECT TYPE TRANSPORT INFRASTRUCTURE	PROJECT PHASE DETAILED DESIGN
CONTRACT NO. 365-20-671-PS	CONSULTANT PROJECT NO. 419032



ACCDoc\Mot\_MacDonald\419032-PT Chevalier\Drawings\0100-0199 General Arrangement\419032-MMD-XX-00-DR-C-0110.dwg Mar 6, 2022 - 6:04PM

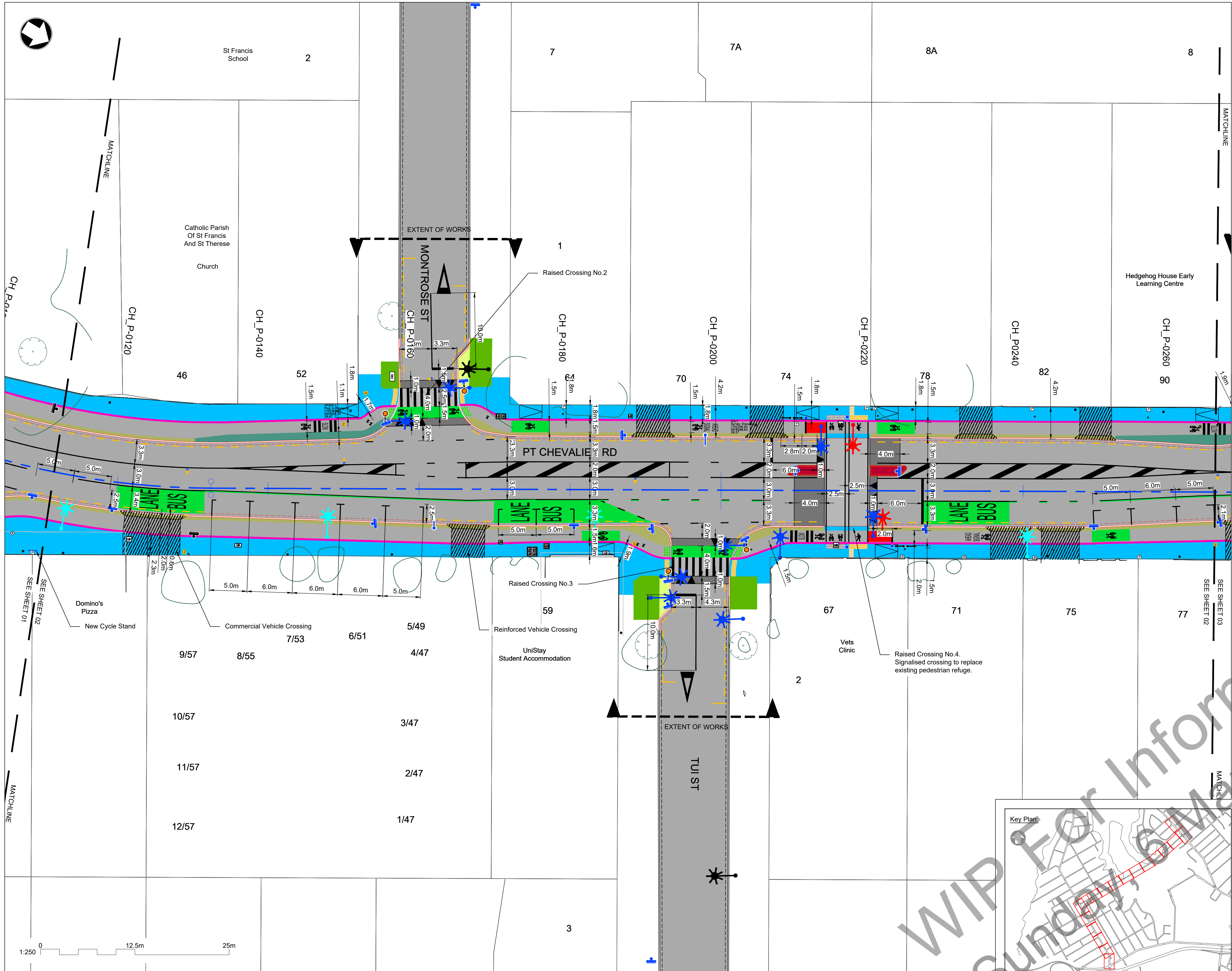

Notes:

1. This drawing is to be read in conjunction with all supplied drawings and design documentation.
2. All dimensions are in meters (unless noted otherwise).
3. Do not obtain dimensions from scaling.
4. Chainages shown on plan are in meters.
5. Drawing projection and coordinates are in terms of New Zealand Transverse Mercator circuit (NZTM) 2000.
6. Levels shown are to Auckland 1946 local vertical datum.
7. Background imagery sourced from Nearmap™ in 2020.
8. Proposed trees to be confirmed with finalised 2D design.

Legend:

General Arrangement:

- Pt Chevalier Rd Control Line
- Meola Rd Control Line
- Garnet Road Control Line
- Existing Property Boundary
- Existing Kerb & channel to remain
- Proposed Kerb & channel
- Existing Building Outlines (surveyed)
- Proposed Cycle Path Surfacing at Bus Stops
- Proposed Cycle Path Markings
- Proposed Cycle/Ped Separation Kerb (Type 2 unless stated otherwise)
- Proposed Concrete Buffer
- Proposed Island
- Proposed Bus Stop Passenger Wait Zone
- Proposed Planting Zone
- Proposed Warning Tactile Treatment (Yellow)
- Proposed Warning Tactile Treatment (Green)
- Proposed Warning Tactile Treatment (Type 3 Separator)
- Proposed Directional Tactile Treatment
- Proposed Vehicle Crossing (Reinforced or Commercial Construction where indicated)
- Proposed Cycle Path
- Proposed Footpath
- Grass to be retained
- Proposed Grass Berm
- Existing Trees / Vegetation
- Proposed Shared Path
- Approximate Edge of closed landfill
- Traffic Signs (Existing / New)
- Cycle Parking (as TDM Technical Standards Detail CY0002A Sheffield Type with Scratch protection on top rail)
- On Road Lane Separator as CY0005A 600mm Wide
- Existing Pole and Luminaire to remain
- New Pole and Luminaire
- Existing Pole with New Luminaire
- Existing Pole decommissioned and removed
- Existing Pole relocate retrofit

SKETCH / WORK IN PROGRESS

ORIGINAL DRAWING IN COLOUR

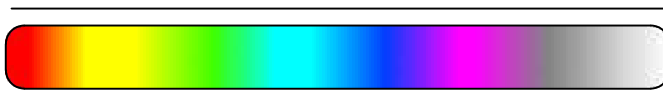

REV	DESCRIPTION	DATE
A	Detailed Design - Draft for Comment	29/09/2020
B	For Stage 1 Tender	18/11/2020
C1	FOR INTERNAL USE ONLY / Work in Progress	6/03/2022

DRAWING Q.A.

WORK IN PROGRESS  
DRAWING

DO NOT SCALE OFF THIS DRAWING.  
VERIFY ALL DIMENSIONS ON SITE  
BEFORE COMMENCING ANY WORK.

CLIENT



PROJECT

POINT CHEVALIER TO WESTMERE CYCLEWAY

PROJECT TYPE

TRANSPORT INFRASTRUCTURE

CONTRACT NO.

365-20-671-PS

PROJECT PHASE

DETAILED DESIGN

CONSULTANT PROJECT NO.

419032

DRAWING

Civils - General Arrangement Plan

Sheet 2 of 18

DRAWING NO.

419032-MMD-XX-00-DR-C-0111

C

REVISION

C1

SCALE (A1)

1:250



ACCDoc\Mot\ MacDonald\19032-Pt Chev\Final\_Civil\01-Design\Drawings\0100-0199\_General Arrangement\19032-MMD-XX-00-DR-C-0110.dwg Mar 6, 2022 - 6:04PM

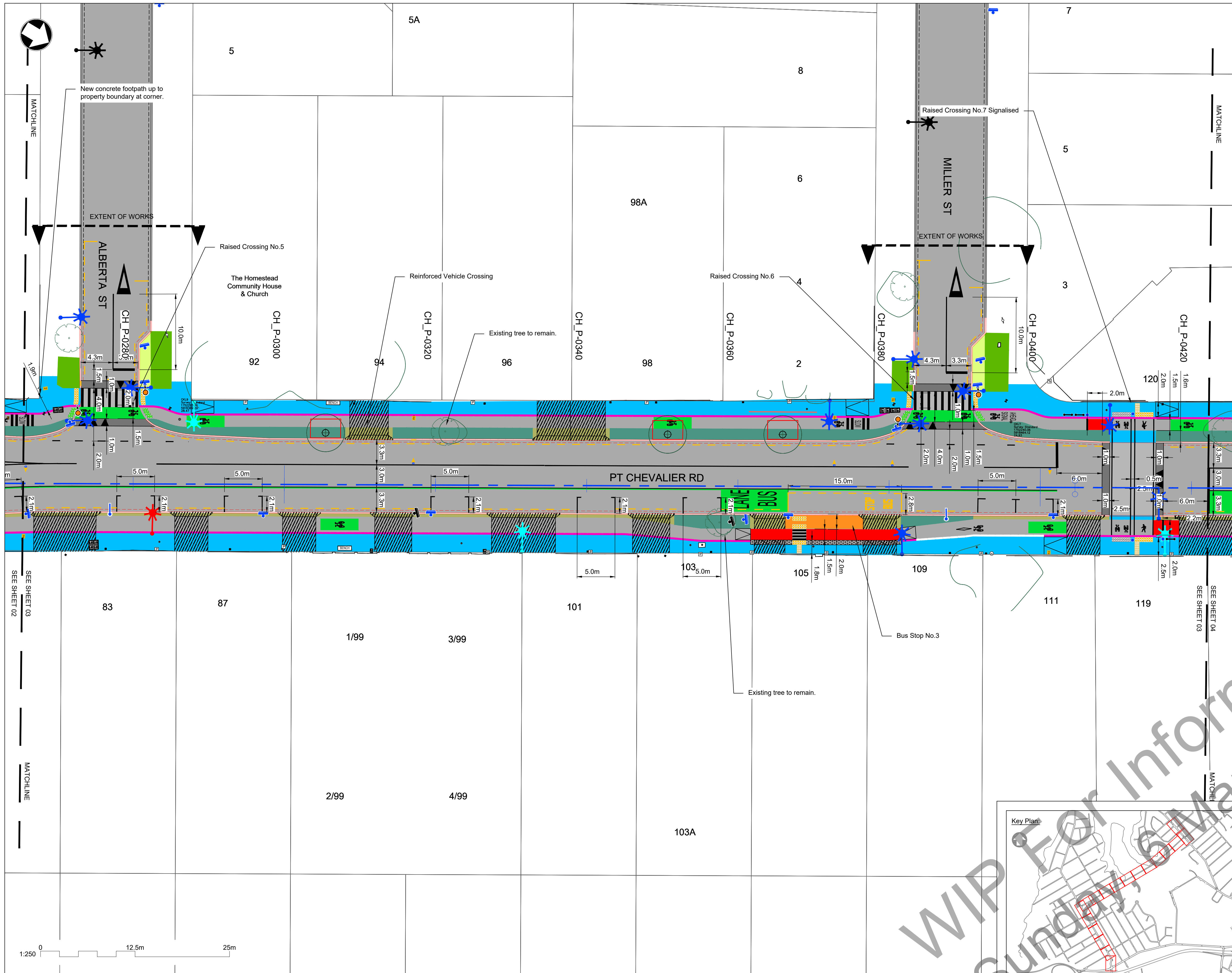

Notes:

1. This drawing is to be read in conjunction with all supplied drawings and design documentation.
2. All dimensions are in meters (unless noted otherwise).
3. Do not obtain dimensions from scaling.
4. Chainages shown on plan are in meters.
5. Drawing projection and coordinates are in terms of New Zealand Transverse Mercator circuit (NZTM) 2000.
6. Levels shown are to Auckland 1946 local vertical datum.
7. Background imagery sourced from Nearmap™ in 2020.
8. Proposed trees to be confirmed with finalised 2D design.

Legend:

General Arrangement:

- Pt Chevalier Rd Control Line
- Meola Rd Control Line
- Garnet Road Control Line
- Existing Property Boundary
- Existing Kerb & channel to remain
- Proposed Kerb & channel
- Existing Building Outlines (surveyed)
- Proposed Cycle Path Surfacing at Bus Stops
- Proposed Cycle Path Markings
- Proposed Cycle/Ped Separation Kerb (Type 2 unless stated otherwise)
- Proposed Concrete Buffer
- Proposed Island
- Proposed Bus Stop Passenger Wait Zone
- Proposed Planting Zone
- Proposed Warning Tactile Treatment (Yellow)
- Proposed Warning Tactile Treatment (Green)
- Proposed Warning Tactile Treatment (Type 3 Separator)
- Proposed Directional Tactile Treatment
- Proposed Vehicle Crossing (Reinforced or Commercial Construction where indicated)
- Proposed Cycle Path
- Proposed Footpath
- Grass to be retained
- Proposed Grass Berm
- Existing Trees / Vegetation
- Proposed Shared Path
- Approximate Edge of closed landfill
- Traffic Signs (Existing / New)
- Cycle Parking (as TDM Technical Standards Detail CY0002A Sheffield Type with Scratch protection on top rail)
- On Road Lane Separator as CY0005A 600mm Wide
- Existing Pole and Luminaire to remain
- New Pole and Luminaire
- Existing Pole with New Luminaire
- Existing Pole decommissioned and removed
- Existing Pole relocate retrofit

SKETCH / WORK IN PROGRESS

DRAWING  
Civils - General Arrangement Plan  
Sheet 3 of 18

DRAWING NO. 419032-MMD-XX-00-DR-C-0112 C1  
REVISION  
C SCALE (A1) 1:250

ORIGINAL DRAWING IN COLOUR



REV	DESCRIPTION	DATE
A	Detailed Design - Draft for Comment	29/09/2020
B	For Stage 1 Tender	18/11/2020
C1	FOR INTERNAL USE ONLY / Work in Progress	6/03/2022

DRAWING Q.A.

WORK IN PROGRESS  
DRAWING

DO NOT SCALE OFF THIS DRAWING.  
VERIFY ALL DIMENSIONS ON SITE  
BEFORE COMMENCING ANY WORK.

CLIENT



PROJECT  
POINT CHEVALIER TO WESTMERE CYCLEWAY

PROJECT TYPE TRANSPORT INFRASTRUCTURE	PROJECT PHASE DETAILED DESIGN
CONTRACT NO. 365-20-671-PS	CONSULTANT PROJECT NO. 419032



ACCDoc\Mot\_MacDonald\419032-PT Chevalier\Drawings\0100-0199 General Arrangement\419032-MMD-XX-00-DR-C-0110.dwg Mar 6, 2022 - 6:04PM

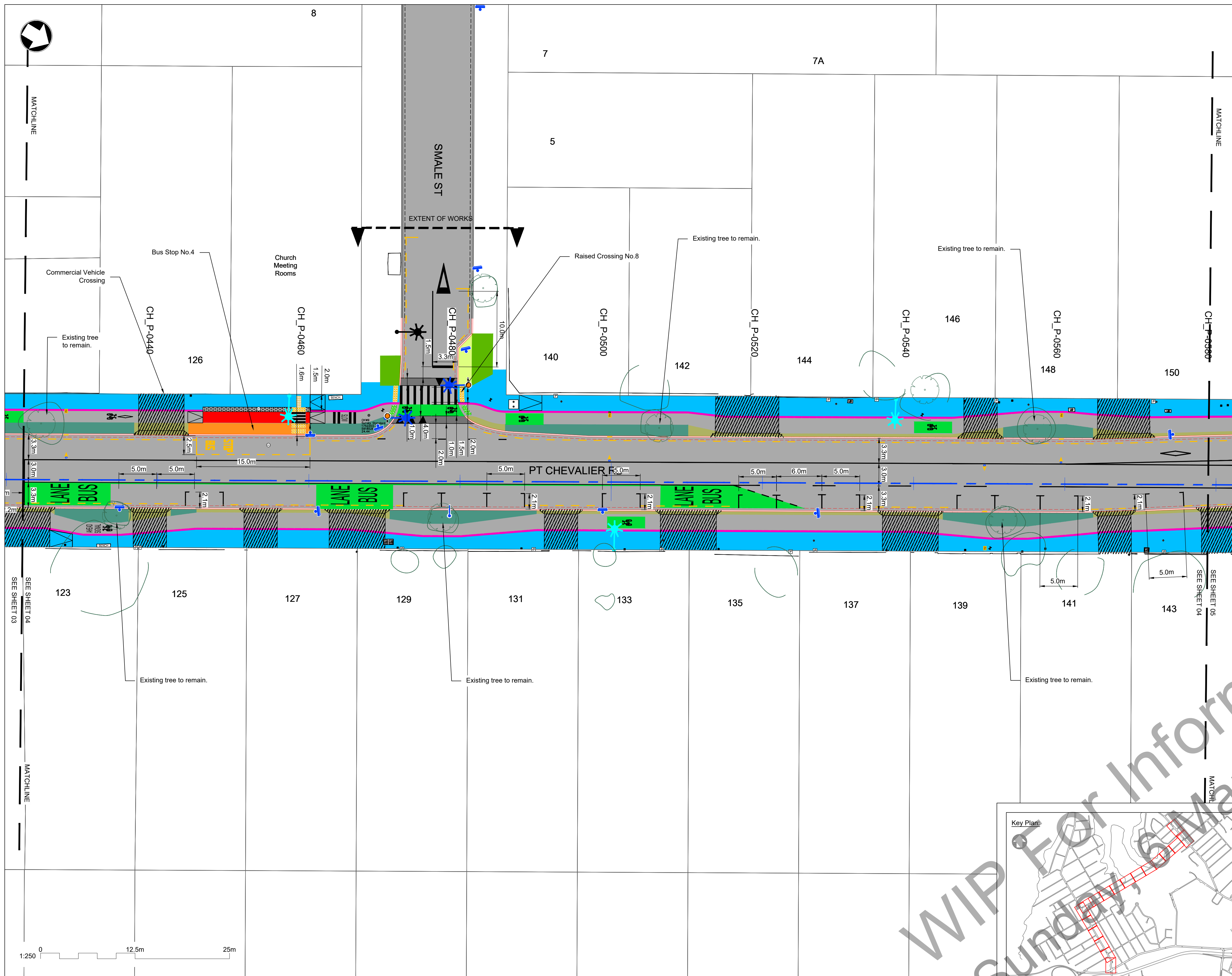

Notes:

1. This drawing is to be read in conjunction with all supplied drawings and design documentation.
2. All dimensions are in meters (unless noted otherwise).
3. Do not obtain dimensions from scaling.
4. Chainages shown on plan are in meters.
5. Drawing projection and coordinates are in terms of New Zealand Transverse Mercator circuit (NZTM) 2000.
6. Levels shown are to Auckland 1946 local vertical datum.
7. Background imagery sourced from Nearmap™ in 2020.
8. Proposed trees to be confirmed with finalised 2D design.

Legend:

General Arrangement:

- Pt Chevalier Rd Control Line
- Meola Rd Control Line
- Garnet Road Control Line
- Existing Property Boundary
- Existing Kerb & channel to remain
- Proposed Kerb & channel
- Existing Building Outlines (surveyed)
- Proposed Cycle Path Surfacing at Bus Stops
- Proposed Cycle Path Markings
- Proposed Cycle/Ped Separation Kerb (Type 2 unless stated otherwise)
- Proposed Concrete Buffer
- Proposed Island
- Proposed Bus Stop Passenger Wait Zone
- Proposed Planting Zone
- Proposed Warning Tactile Treatment (Yellow)
- Proposed Warning Tactile Treatment (Green)
- Proposed Warning Tactile Treatment (Type 3 Separator)
- Proposed Directional Tactile Treatment
- Proposed Vehicle Crossing (Reinforced or Commercial Construction where indicated)
- Proposed Cycle Path
- Proposed Footpath
- Grass to be retained
- Proposed Grass Berm
- Existing Trees / Vegetation
- Proposed Shared Path
- Approximate Edge of closed landfill
- Traffic Signs (Existing / New)
- Cycle Parking (as TDM Technical Standards Detail CY0002A Sheffield Type with Scratch protection on top rail)
- On Road Lane Separator as CY0005A 600mm Wide
- Existing Pole and Luminaire to remain
- New Pole and Luminaire
- Existing Pole with New Luminaire
- Existing Pole decommissioned and removed
- Existing Pole relocate retrofit

SKETCH / WORK IN PROGRESS

DRAWING  
Civils - General Arrangement Plan  
Sheet 4 of 18

DRAWING NO. 419032-MMD-XX-00-DR-C-0113 C1  
REVISION  
C SCALE (A1) 1:250

REV	DESCRIPTION	DATE
A	Detailed Design - Draft for Comment	29/09/2020
B	For Stage 1 Tender	18/11/2020
C1	FOR INTERNAL USE ONLY / Work in Progress	6/03/2022

DRAWING Q.A.

WORK IN PROGRESS  
DRAWING

DO NOT SCALE OFF THIS DRAWING.  
VERIFY ALL DIMENSIONS ON SITE  
BEFORE COMMENCING ANY WORK.

CLIENT



PROJECT  
POINT CHEVALIER TO WESTMERE CYCLEWAY

PROJECT TYPE TRANSPORT INFRASTRUCTURE	PROJECT PHASE DETAILED DESIGN
CONTRACT NO. 365-20-671-PS	CONSULTANT PROJECT NO. 419032



ACCDoc\Mot\_MacDonald\419032-PT Chevalier\Drawings\0100-0199 General Arrangement\419032-MMD-XX-00-DR-C-0110.dwg Mar 6, 2022 - 6:04PM

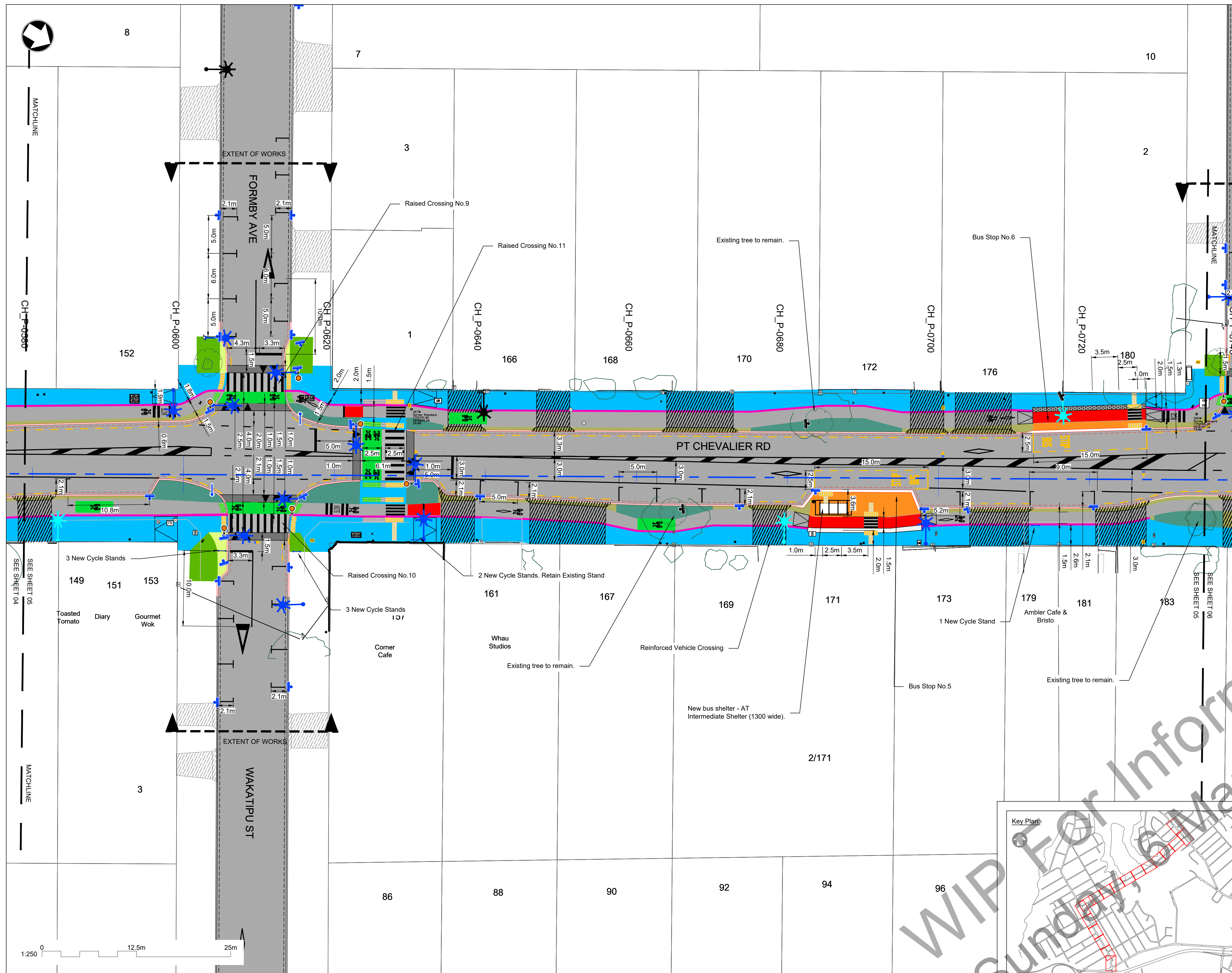

Notes:

1. This drawing is to be read in conjunction with all supplied drawings and design documentation.
2. All dimensions are in meters (unless noted otherwise).
3. Do not obtain dimensions from scaling.
4. Chainages shown on plan are in meters.
5. Drawing projection and coordinates are in terms of New Zealand Transverse Mercator circuit (NZTM) 2000.
6. Levels shown are to Auckland 1946 local vertical datum.
7. Background imagery sourced from Nearmap™ in 2020.
8. Proposed trees to be confirmed with finalised 2D design.

Legend:

General Arrangement:

- Pt Chevalier Rd Control Line
- Meola Rd Control Line
- Garnet Road Control Line
- Existing Property Boundary
- Existing Kerb & channel to remain
- Proposed Kerb & channel
- Existing Building Outlines (surveyed)
- Proposed Cycle Path Surfacing at Bus Stops
- Proposed Cycle Path Markings
- Proposed Cycle/Ped Separation Kerb (Type 2 unless stated otherwise)
- Proposed Concrete Buffer
- Proposed Island
- Proposed Bus Stop Passenger Wait Zone
- Proposed Planting Zone
- Proposed Warning Tactile Treatment (Yellow)
- Proposed Warning Tactile Treatment (Green)
- Proposed Warning Tactile Treatment (Type 3 Separator)
- Proposed Directional Tactile Treatment
- Proposed Vehicle Crossing (Reinforced or Commercial Construction where indicated)
- Proposed Cycle Path
- Proposed Footpath
- Grass to be retained
- Proposed Grass Berm
- Existing Trees / Vegetation
- Proposed Shared Path
- Approximate Edge of closed landfill
- Traffic Signs (Existing / New)
- Cycle Parking (as TDM Technical Standards Detail CY0002A Sheffield Type with Scratch protection on top rail)
- On Road Lane Separator as CY0005A 600mm Wide
- Existing Pole and Luminaire to remain
- New Pole and Luminaire
- Existing Pole with New Luminaire
- Existing Pole decommissioned and removed
- Existing Pole relocate retrofit

SKETCH / WORK IN PROGRESS

DRAWING	
Civils - General Arrangement Plan	
Sheet 5 of 18	
DRAWING NO.	REVISION
419032-MMD-XX-00-DR-C-0114	C1
C	SCALE (A1) 1:250

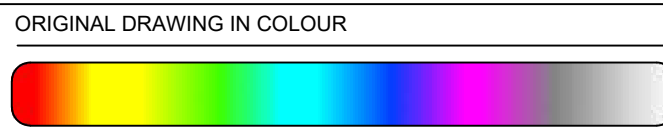

REV	DESCRIPTION	DATE
A	Detailed Design - Draft for Comment	29/09/2020
B	For Stage 1 Tender	18/11/2020
C1	FOR INTERNAL USE ONLY / Work in Progress	6/03/2022

DRAWING Q.A.
WORK IN PROGRESS DRAWING

DO NOT SCALE OFF THIS DRAWING.  
VERIFY ALL DIMENSIONS ON SITE  
BEFORE COMMENCING ANY WORK.



PROJECT	
POINT CHEVALIER TO WESTMERE CYCLEWAY	
PROJECT TYPE	PROJECT PHASE
TRANSPORT INFRASTRUCTURE	DETAILED DESIGN
CONTRACT NO.	CONSULTANT PROJECT NO.
365-20-671-PS	419032



- Notes:
1. This drawing is to be read in conjunction with all supplied drawings and design documentation.
  2. All dimensions are in meters (unless noted otherwise).
  3. Do not obtain dimensions from scaling.
  4. Chainages shown on plan are in meters.
  5. Drawing projection and coordinates are in terms of New Zealand Transverse Mercator circuit (NZTM) 2000.
  6. Levels shown are to Auckland 1946 local vertical datum.
  7. Background imagery sourced from Nearmap™ in 2020.
  8. Proposed trees to be confirmed with finalised 2D design.

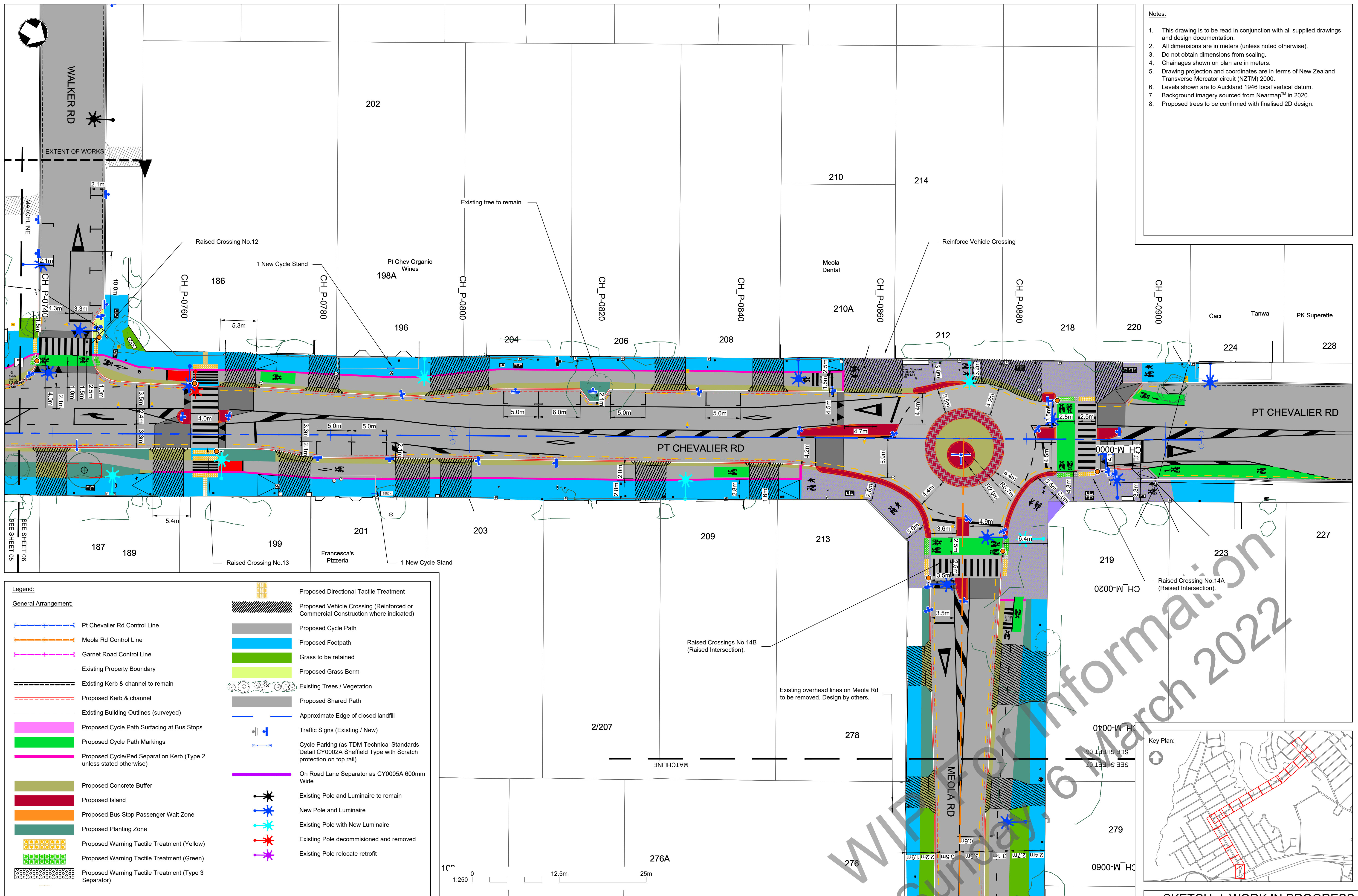

**Legend:**

**General Arrangement:**

- Pt Chevalier Rd Control Line
- Meola Rd Control Line
- Garnet Road Control Line
- Existing Property Boundary
- Existing Kerb & channel to remain
- Proposed Kerb & channel
- Existing Building Outlines (surveyed)
- Proposed Cycle Path Surfacing at Bus Stops
- Proposed Cycle Path Markings
- Proposed Cycle/Ped Separation Kerb (Type 2 unless stated otherwise)
- Proposed Concrete Buffer
- Proposed Island
- Proposed Bus Stop Passenger Wait Zone
- Proposed Planting Zone
- Proposed Warning Tactile Treatment (Yellow)
- Proposed Warning Tactile Treatment (Green)
- Proposed Warning Tactile Treatment (Type 3 Separator)

**Proposed Directional Tactile Treatment**

**Proposed Vehicle Crossing (Reinforced or Commercial Construction where indicated)**

**Proposed Cycle Path**

**Proposed Footpath**

**Grass to be retained**

**Proposed Grass Berm**

**Existing Trees / Vegetation**

**Proposed Shared Path**

**Approximate Edge of closed landfill**

**Traffic Signs (Existing / New)**

**Cycle Parking (as TDM Technical Standards Detail CY0002A Sheffield Type with Scratch protection on top rail)**

**On Road Lane Separator as CY0005A 600mm Wide**

**Existing Pole and Luminaire to remain**

**New Pole and Luminaire**

**Existing Pole with New Luminaire**

**Existing Pole decommissioned and removed**

**Existing Pole relocate retrofit**

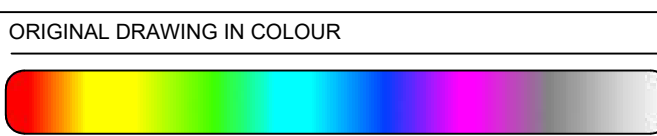

REV	DESCRIPTION	DATE
A	Detailed Design - Draft for Comment	29/09/2020
B	For Stage 1 Tender	18/11/2020
C1	FOR INTERNAL USE ONLY / Work in Progress	6/03/2022

DRAWING Q.A.
WORK IN PROGRESS DRAWING

DO NOT SCALE OFF THIS DRAWING.  
VERIFY ALL DIMENSIONS ON SITE  
BEFORE COMMENCING ANY WORK.



PROJECT	PROJECT TYPE	PROJECT PHASE
POINT CHEVALIER TO WESTMERE CYCLEWAY	TRANSPORT INFRASTRUCTURE	DETAILED DESIGN
CONTRACT NO.	365-20-671-PS	CONSULTANT PROJECT NO.
		419032

SKETCH / WORK IN PROGRESS	
DRAWING	Civils - General Arrangement Plan
Sheet 6 of 18	
DRAWING NO.	419032-MMD-XX-00-DR-C-0115
REVISION	C1
C	SCALE (A1) 1:250



ACCDoc\Mot\ MacDonald\19032-Pt Chevalier\Drawings\0100-0199 General Arrangement\19032-MMD-XX-00-DR-C-0110.dwg Mar 6, 2022 - 6:04PM

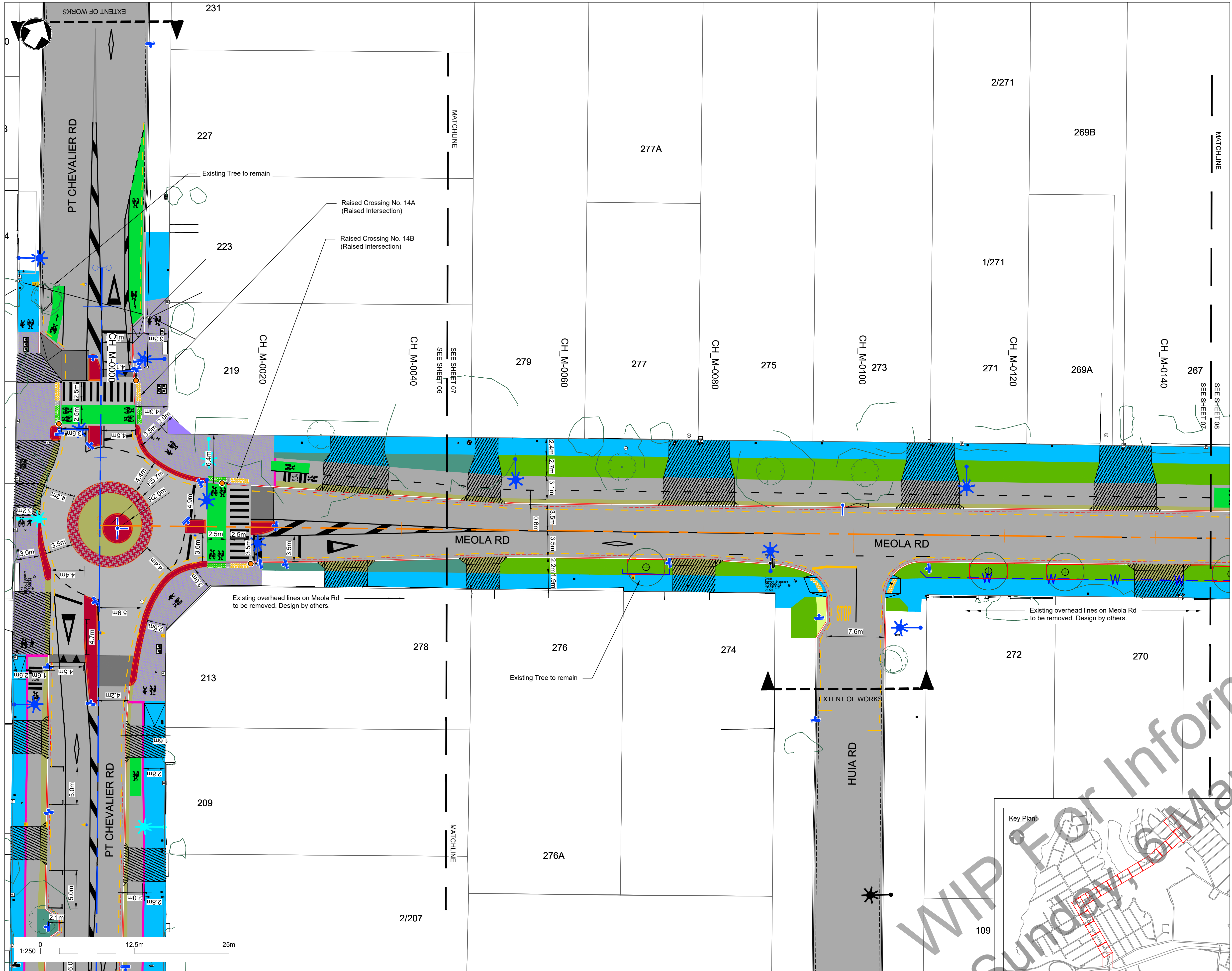

Notes:

1. This drawing is to be read in conjunction with all supplied drawings and design documentation.
2. All dimensions are in meters (unless noted otherwise).
3. Do not obtain dimensions from scaling.
4. Chainages shown on plan are in meters.
5. Drawing projection and coordinates are in terms of New Zealand Transverse Mercator circuit (NZTM) 2000.
6. Levels shown are to Auckland 1946 local vertical datum.
7. Background imagery sourced from Nearmap™ in 2020.
8. Proposed trees to be confirmed with finalised 2D design.

Legend:

General Arrangement:

- Pt Chevalier Rd Control Line
- Meola Rd Control Line
- Garnet Road Control Line
- Existing Property Boundary
- Existing Kerb & channel to remain
- Proposed Kerb & channel
- Existing Building Outlines (surveyed)
- Proposed Cycle Path Surfacing at Bus Stops
- Proposed Cycle Path Markings
- Proposed Cycle/Ped Separation Kerb (Type 2 unless stated otherwise)
- Proposed Concrete Buffer
- Proposed Island
- Proposed Bus Stop Passenger Wait Zone
- Proposed Planting Zone
- Proposed Warning Tactile Treatment (Yellow)
- Proposed Warning Tactile Treatment (Green)
- Proposed Warning Tactile Treatment (Type 3 Separator)
- Proposed Directional Tactile Treatment
- Proposed Vehicle Crossing (Reinforced or Commercial Construction where indicated)
- Proposed Cycle Path
- Proposed Footpath
- Grass to be retained
- Proposed Grass Berm
- Existing Trees / Vegetation
- Proposed Shared Path
- Approximate Edge of closed landfill
- Traffic Signs (Existing / New)
- Cycle Parking (as TDM Technical Standards Detail CY0002A Sheffield Type with Scratch protection on top rail)
- On Road Lane Separator as CY0005A 600mm Wide
- Existing Pole and Luminaire to remain
- New Pole and Luminaire
- Existing Pole with New Luminaire
- Existing Pole decommissioned and removed
- Existing Pole relocate retrofit

SKETCH / WORK IN PROGRESS

DRAWING	Civils - General Arrangement Plan
Sheet 7 of 18	
DRAWING NO.	419032-MMD-XX-00-DR-C-0116
C	C1
SCALE (A1)	1:250

REV	DESCRIPTION	DATE
A	Detailed Design - Draft for Comment	29/09/2020
B	For Stage 1 Tender	18/11/2020
C1	FOR INTERNAL USE ONLY / Work in Progress	6/03/2022

DRAWING Q.A.
WORK IN PROGRESS DRAWING

DO NOT SCALE OFF THIS DRAWING.  
VERIFY ALL DIMENSIONS ON SITE  
BEFORE COMMENCING ANY WORK.



PROJECT	POINT CHEVALIER TO WESTMERE CYCLEWAY
PROJECT TYPE	TRANSPORT INFRASTRUCTURE
CONTRACT NO.	365-20-671-PS
PROJECT PHASE	DETAILED DESIGN
CONSULTANT PROJECT NO.	419032



ACCDoc\Mot\ MacDonald\19032-Pt Chevalier\Civil\Design\Drawings\0100-0199 General Arrangement\19032-MMD-XX-00-DR-C-0110.dwg Mar 6, 2022 - 6:04PM



Notes:

1. This drawing is to be read in conjunction with all supplied drawings and design documentation.
2. All dimensions are in meters (unless noted otherwise).
3. Do not obtain dimensions from scaling.
4. Chainages shown on plan are in meters.
5. Drawing projection and coordinates are in terms of New Zealand Transverse Mercator circuit (NZTM) 2000.
6. Levels shown are to Auckland 1946 local vertical datum.
7. Background imagery sourced from Nearmap™ in 2020.
8. Proposed trees to be confirmed with finalised 2D design.

Legend:

General Arrangement:

- Pt Chevalier Rd Control Line
- Meola Rd Control Line
- Garnet Road Control Line
- Existing Property Boundary
- Existing Kerb & channel to remain
- Proposed Kerb & channel
- Existing Building Outlines (surveyed)
- Proposed Cycle Path Surfacing at Bus Stops
- Proposed Cycle Path Markings
- Proposed Cycle/Ped Separation Kerb (Type 2 unless stated otherwise)
- Proposed Concrete Buffer
- Proposed Island
- Proposed Bus Stop Passenger Wait Zone
- Proposed Planting Zone
- Proposed Warning Tactile Treatment (Yellow)
- Proposed Warning Tactile Treatment (Green)
- Proposed Warning Tactile Treatment (Type 3 Separator)
- Proposed Directional Tactile Treatment
- Proposed Vehicle Crossing (Reinforced or Commercial Construction where indicated)
- Proposed Cycle Path
- Proposed Footpath
- Grass to be retained
- Proposed Grass Berm
- Existing Trees / Vegetation
- Proposed Shared Path
- Approximate Edge of closed landfill
- Traffic Signs (Existing / New)
- Cycle Parking (as TDM Technical Standards Detail CY0002A Sheffield Type with Scratch protection on top rail)
- On Road Lane Separator as CY0005A 600mm Wide
- Existing Pole and Luminaire to remain
- New Pole and Luminaire
- Existing Pole with New Luminaire
- Existing Pole decommissioned and removed
- Existing Pole relocate retrofit

SKETCH / WORK IN PROGRESS

DRAWING  
Civils - General Arrangement Plan  
Sheet 8 of 18

DRAWING NO. 419032-MMD-XX-00-DR-C-0117 C1  
REVISION  
C SCALE (A1) 1:250

REV	DESCRIPTION	DATE
A	Detailed Design - Draft for Comment	29/09/2020
B	For Stage 1 Tender	18/11/2020
C1	FOR INTERNAL USE ONLY / Work in Progress	6/03/2022

DRAWING Q.A.
WORK IN PROGRESS DRAWING

DO NOT SCALE OFF THIS DRAWING.  
VERIFY ALL DIMENSIONS ON SITE  
BEFORE COMMENCING ANY WORK.

CLIENT



PROJECT  
POINT CHEVALIER TO WESTMERE CYCLEWAY

PROJECT TYPE	PROJECT PHASE
TRANSPORT INFRASTRUCTURE	DETAILED DESIGN
CONTRACT NO.	CONSULTANT PROJECT NO.
365-20-671-PS	419032



ACCDocs\Mot\_MacDonald\419032-PT Chevalier\Drawings\0100-0199 General Arrangement\419032-MMD-XX-00-DR-C-0110.dwg Mar 6, 2022 - 6:04PM



Notes:

1. This drawing is to be read in conjunction with all supplied drawings and design documentation.
2. All dimensions are in meters (unless noted otherwise).
3. Do not obtain dimensions from scaling.
4. Chainages shown on plan are in meters.
5. Drawing projection and coordinates are in terms of New Zealand Transverse Mercator circuit (NZTM) 2000.
6. Levels shown are to Auckland 1946 local vertical datum.
7. Background imagery sourced from Nearmap™ in 2020.
8. Proposed trees to be confirmed with finalised 2D design.

Legend:

General Arrangement:

- Pt Chevalier Rd Control Line
- Meola Rd Control Line
- Garnet Road Control Line
- Existing Property Boundary
- Existing Kerb & channel to remain
- Proposed Kerb & channel
- Existing Building Outlines (surveyed)
- Proposed Cycle Path Surfacing at Bus Stops
- Proposed Cycle Path Markings
- Proposed Cycle/Ped Separation Kerb (Type 2 unless stated otherwise)
- Proposed Concrete Buffer
- Proposed Island
- Proposed Bus Stop Passenger Wait Zone
- Proposed Planting Zone
- Proposed Warning Tactile Treatment (Yellow)
- Proposed Warning Tactile Treatment (Green)
- Proposed Warning Tactile Treatment (Type 3 Separator)
- Proposed Directional Tactile Treatment
- Proposed Vehicle Crossing (Reinforced or Commercial Construction where indicated)
- Proposed Cycle Path
- Proposed Footpath
- Grass to be retained
- Proposed Grass Berm
- Existing Trees / Vegetation
- Proposed Shared Path
- Approximate Edge of closed landfill
- Traffic Signs (Existing / New)
- Cycle Parking (as TDM Technical Standards Detail CY0002A Sheffield Type with Scratch protection on top rail)
- On Road Lane Separator as CY0005A 600mm Wide
- Existing Pole and Luminaire to remain
- New Pole and Luminaire
- Existing Pole with New Luminaire
- Existing Pole decommissioned and removed
- Existing Pole relocate retrofit

SKETCH / WORK IN PROGRESS

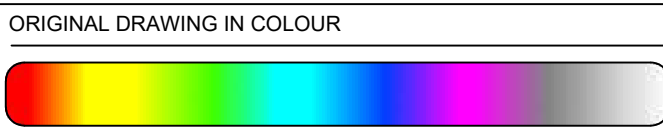

REV	DESCRIPTION	DATE
A	Detailed Design - Draft for Comment	29/09/2020
B	For Stage 1 Tender	18/11/2020
C1	FOR INTERNAL USE ONLY / Work in Progress	6/03/2022

DRAWING Q.A.
WORK IN PROGRESS DRAWING

DO NOT SCALE OFF THIS DRAWING.  
VERIFY ALL DIMENSIONS ON SITE  
BEFORE COMMENCING ANY WORK.



PROJECT	
POINT CHEVALIER TO WESTMERE CYCLEWAY	
PROJECT TYPE	PROJECT PHASE
TRANSPORT INFRASTRUCTURE	DETAILED DESIGN
CONTRACT NO.	CONSULTANT PROJECT NO.
365-20-671-PS	419032

DRAWING	REVISION
Civils - General Arrangement Plan Sheet 9 of 18	
DRAWING NO.	419032-MMD-XX-00-DR-C-0118
C	C1
SCALE (A1)	1:250



ACCDoc\Mot\_MacDonald\419032-PT Chevalier\Drawings\0100-0199 General Arrangement\419032-MMD-XX-00-DR-C-0110.dwg Mar 6, 2022 - 6:04PM



Notes:

1. This drawing is to be read in conjunction with all supplied drawings and design documentation.
2. All dimensions are in meters (unless noted otherwise).
3. Do not obtain dimensions from scaling.
4. Chainages shown on plan are in meters.
5. Drawing projection and coordinates are in terms of New Zealand Transverse Mercator circuit (NZTM) 2000.
6. Levels shown are to Auckland 1946 local vertical datum.
7. Background imagery sourced from Nearmap™ in 2020.
8. Proposed trees to be confirmed with finalised 2D design.

Legend:

General Arrangement:

- Pt Chevalier Rd Control Line
- Meola Rd Control Line
- Garnet Road Control Line
- Existing Property Boundary
- Existing Kerb & channel to remain
- Proposed Kerb & channel
- Existing Building Outlines (surveyed)
- Proposed Cycle Path Surfacing at Bus Stops
- Proposed Cycle Path Markings
- Proposed Cycle/Ped Separation Kerb (Type 2 unless stated otherwise)
- Proposed Concrete Buffer
- Proposed Island
- Proposed Bus Stop Passenger Wait Zone
- Proposed Planting Zone
- Proposed Warning Tactile Treatment (Yellow)
- Proposed Warning Tactile Treatment (Green)
- Proposed Warning Tactile Treatment (Type 3 Separator)
- Proposed Directional Tactile Treatment
- Proposed Vehicle Crossing (Reinforced or Commercial Construction where indicated)
- Proposed Cycle Path
- Proposed Footpath
- Grass to be retained
- Proposed Grass Berm
- Existing Trees / Vegetation
- Proposed Shared Path
- Approximate Edge of closed landfill
- Traffic Signs (Existing / New)
- Cycle Parking (as TDM Technical Standards Detail CY0002A Sheffield Type with Scratch protection on top rail)
- On Road Lane Separator as CY0005A 600mm Wide
- Existing Pole and Luminaire to remain
- New Pole and Luminaire
- Existing Pole with New Luminaire
- Existing Pole decommissioned and removed
- Existing Pole relocate retrofit

SKETCH / WORK IN PROGRESS

DRAWING  
Civils - General Arrangement Plan  
Sheet 10 of 18

DRAWING NO. 419032-MMD-XX-00-DR-C-0119 C1  
REVISION  
C SCALE (A1) 1:250

REV	DESCRIPTION	DATE
A	Detailed Design - Draft for Comment	29/09/2020
B	For Stage 1 Tender	18/11/2020
C1	FOR INTERNAL USE ONLY / Work in Progress	6/03/2022

DRAWING Q.A.

WORK IN PROGRESS  
DRAWING

DO NOT SCALE OFF THIS DRAWING.  
VERIFY ALL DIMENSIONS ON SITE  
BEFORE COMMENCING ANY WORK.

CLIENT



PROJECT  
POINT CHEVALIER TO WESTMERE CYCLEWAY

PROJECT TYPE	PROJECT PHASE
TRANSPORT INFRASTRUCTURE	DETAILED DESIGN
CONTRACT NO.	CONSULTANT PROJECT NO.
365-20-671-PS	419032



ACCDoc\Mot\_MacDonald\419032-PT Chevalier\Drawings\0100-0199 General Arrangement\419032-MMD-XX-00-DR-C-0110.dwg Mar 6, 2022 - 6:04PM

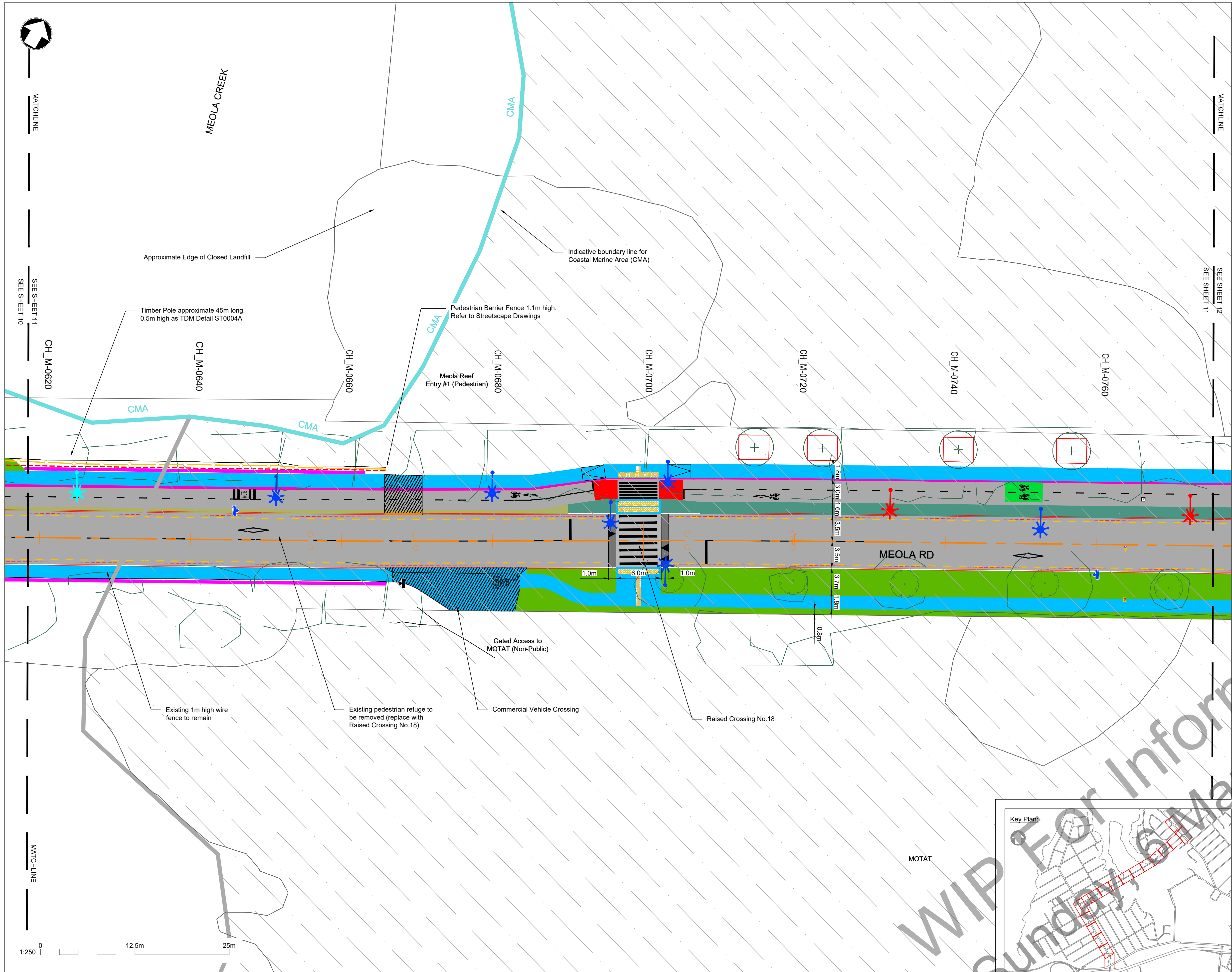

Notes:

1. This drawing is to be read in conjunction with all supplied drawings and design documentation.
2. All dimensions are in meters (unless noted otherwise).
3. Do not obtain dimensions from scaling.
4. Chainages shown on plan are in meters.
5. Drawing projection and coordinates are in terms of New Zealand Transverse Mercator circuit (NZTM) 2000.
6. Levels shown are to Auckland 1946 local vertical datum.
7. Background imagery sourced from Nearmap™ in 2020.
8. Proposed trees to be confirmed with finalised 2D design.

Legend:

General Arrangement:

- Pt Chevalier Rd Control Line
- Meola Rd Control Line
- Garnet Road Control Line
- Existing Property Boundary
- Existing Kerb & channel to remain
- Proposed Kerb & channel
- Existing Building Outlines (surveyed)
- Proposed Cycle Path Surfacing at Bus Stops
- Proposed Cycle Path Markings
- Proposed Cycle/Ped Separation Kerb (Type 2 unless stated otherwise)
- Proposed Concrete Buffer
- Proposed Island
- Proposed Bus Stop Passenger Wait Zone
- Proposed Planting Zone
- Proposed Warning Tactile Treatment (Yellow)
- Proposed Warning Tactile Treatment (Green)
- Proposed Warning Tactile Treatment (Type 3 Separator)
- Proposed Directional Tactile Treatment
- Proposed Vehicle Crossing (Reinforced or Commercial Construction where indicated)
- Proposed Cycle Path
- Proposed Footpath
- Grass to be retained
- Proposed Grass Berm
- Existing Trees / Vegetation
- Proposed Shared Path
- Approximate Edge of closed landfill
- Traffic Signs (Existing / New)
- Cycle Parking (as TDM Technical Standards Detail CY0002A Sheffield Type with Scratch protection on top rail)
- On Road Lane Separator as CY0005A 600mm Wide
- Existing Pole and Luminaire to remain
- New Pole and Luminaire
- Existing Pole with New Luminaire
- Existing Pole decommissioned and removed
- Existing Pole relocate retrofit

SKETCH / WORK IN PROGRESS

DRAWING	Civils - General Arrangement Plan	REVISION
Sheet 11 of 18		
DRAWING NO.	419032-MMD-XX-00-DR-C-0120	C1
C	SCALE (A1)	1:250

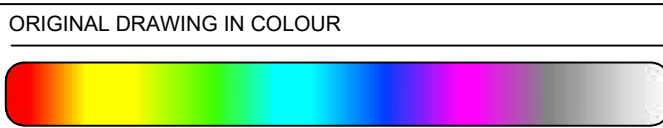

REV	DESCRIPTION	DATE
A	Detailed Design - Draft for Comment	29/09/2020
B	For Stage 1 Tender	18/11/2020
C1	FOR INTERNAL USE ONLY / Work in Progress	6/03/2022

DRAWING Q.A.
WORK IN PROGRESS DRAWING

DO NOT SCALE OFF THIS DRAWING.  
VERIFY ALL DIMENSIONS ON SITE  
BEFORE COMMENCING ANY WORK.



PROJECT	POINT CHEVALIER TO WESTMERE CYCLEWAY
PROJECT TYPE	TRANSPORT INFRASTRUCTURE
CONTRACT NO.	365-20-671-PS
PROJECT PHASE	DETAILED DESIGN
CONSULTANT PROJECT NO.	419032



ACCDocs\\Mot\_MacDonald\\419032-PT Chevalier\\Drawings\\0100-0199 General Arrangement\\419032-MMD-XX-00-DR-C-0110.dwg Mar 6, 2022 - 6:04PM

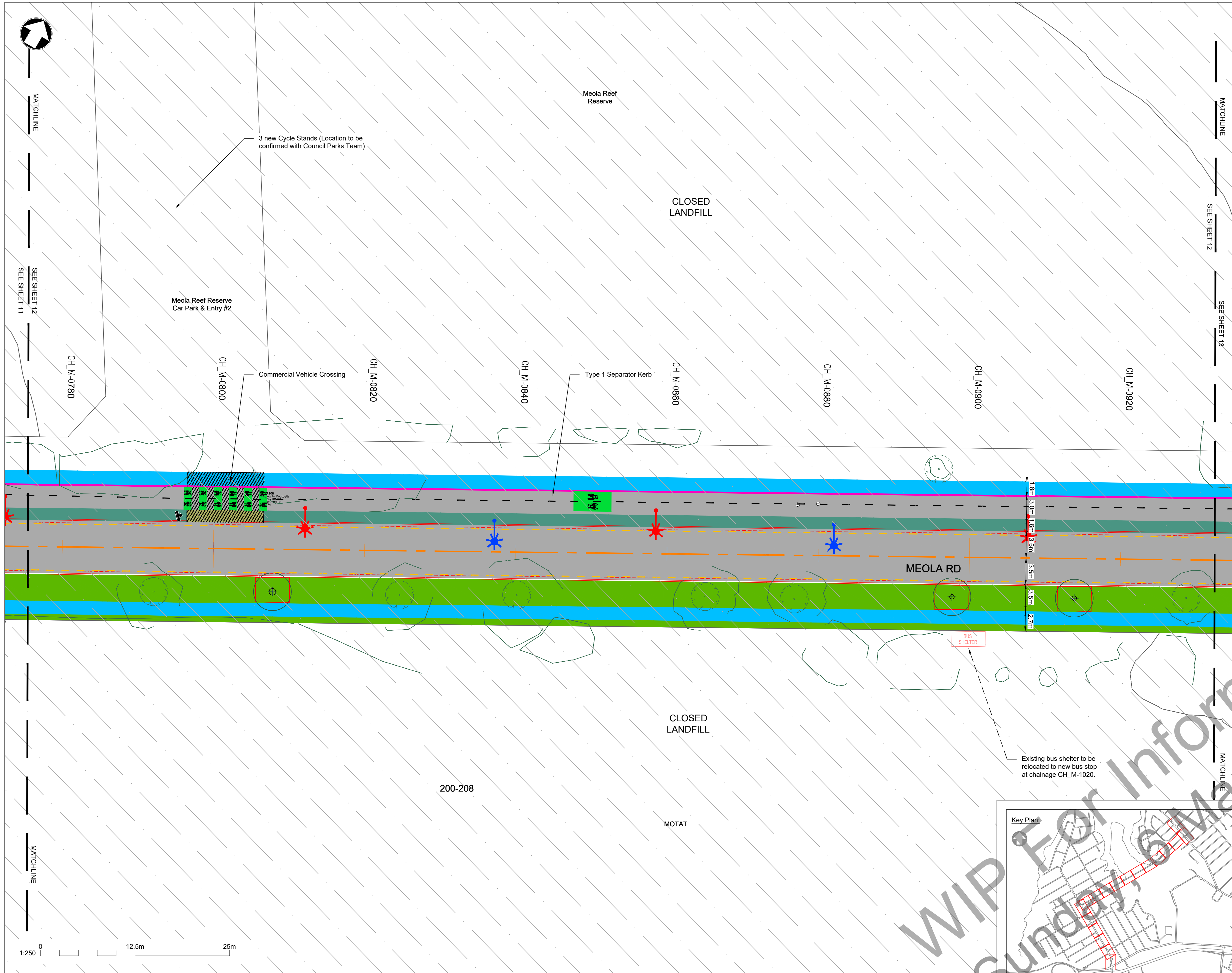

Notes:

1. This drawing is to be read in conjunction with all supplied drawings and design documentation.
2. All dimensions are in meters (unless noted otherwise).
3. Do not obtain dimensions from scaling.
4. Chainages shown on plan are in meters.
5. Drawing projection and coordinates are in terms of New Zealand Transverse Mercator circuit (NZTM) 2000.
6. Levels shown are to Auckland 1946 local vertical datum.
7. Background imagery sourced from Nearmap™ in 2020.
8. Proposed trees to be confirmed with finalised 2D design.

Legend:

General Arrangement:

- Pt Chevalier Rd Control Line
- Meola Rd Control Line
- Garnet Road Control Line
- Existing Property Boundary
- Existing Kerb & channel to remain
- Proposed Kerb & channel
- Existing Building Outlines (surveyed)
- Proposed Cycle Path Surfacing at Bus Stops
- Proposed Cycle Path Markings
- Proposed Cycle/Ped Separation Kerb (Type 2 unless stated otherwise)
- Proposed Concrete Buffer
- Proposed Island
- Proposed Bus Stop Passenger Wait Zone
- Proposed Planting Zone
- Proposed Warning Tactile Treatment (Yellow)
- Proposed Warning Tactile Treatment (Green)
- Proposed Warning Tactile Treatment (Type 3 Separator)
- Proposed Directional Tactile Treatment
- Proposed Vehicle Crossing (Reinforced or Commercial Construction where indicated)
- Proposed Cycle Path
- Proposed Footpath
- Grass to be retained
- Proposed Grass Berm
- Existing Trees / Vegetation
- Proposed Shared Path
- Approximate Edge of closed landfill
- Traffic Signs (Existing / New)
- Cycle Parking (as TDM Technical Standards Detail CY0002A Sheffield Type with Scratch protection on top rail)
- On Road Lane Separator as CY0005A 600mm Wide
- Existing Pole and Luminaire to remain
- New Pole and Luminaire
- Existing Pole with New Luminaire
- Existing Pole decommissioned and removed
- Existing Pole relocate retrofit

SKETCH / WORK IN PROGRESS

DRAWING  
Civils - General Arrangement Plan  
Sheet 12 of 18

DRAWING NO. 419032-MMD-XX-00-DR-C-0121 C1  
C  
SCALE (A1) 1:250

ORIGINAL DRAWING IN COLOUR



REV	DESCRIPTION	DATE
A	Detailed Design - Draft for Comment	29/09/2020
B	For Stage 1 Tender	18/11/2020
C1	FOR INTERNAL USE ONLY / Work in Progress	6/03/2022

DRAWING Q.A.

WORK IN PROGRESS  
DRAWING

DO NOT SCALE OFF THIS DRAWING.  
VERIFY ALL DIMENSIONS ON SITE  
BEFORE COMMENCING ANY WORK.

CLIENT



PROJECT  
POINT CHEVALIER TO WESTMERE CYCLEWAY

PROJECT TYPE	PROJECT PHASE
TRANSPORT INFRASTRUCTURE	DETAILED DESIGN
CONTRACT NO.	CONSULTANT PROJECT NO.
365-20-671-PS	419032



ACCDoc\Mot\_MacDonald\19032-PT Chevalier\Drawings\0100-0199 General Arrangement\19032-MMD-XX-00-DR-C-0110.dwg Mar 6, 2022 - 6:04PM

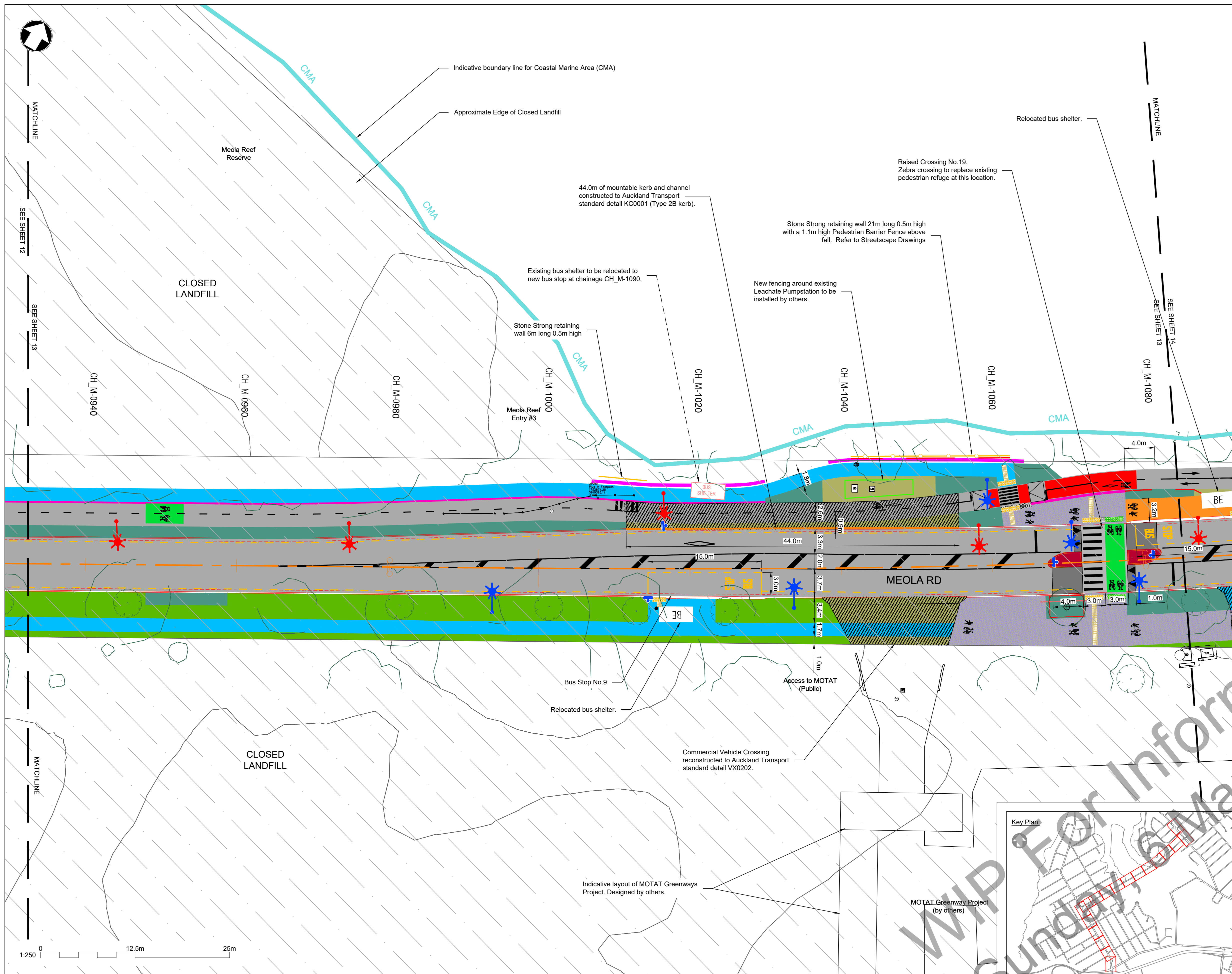

Notes:

1. This drawing is to be read in conjunction with all supplied drawings and design documentation.
2. All dimensions are in meters (unless noted otherwise).
3. Do not obtain dimensions from scaling.
4. Chainages shown on plan are in meters.
5. Drawing projection and coordinates are in terms of New Zealand Transverse Mercator circuit (NZTM) 2000.
6. Levels shown are to Auckland 1946 local vertical datum.
7. Background imagery sourced from Nearmap™ in 2020.
8. Proposed trees to be confirmed with finalised 2D design.

Legend:

General Arrangement:

- Pt Chevalier Rd Control Line
- Meola Rd Control Line
- Garret Road Control Line
- Existing Property Boundary
- Existing Kerb & channel to remain
- Proposed Kerb & channel
- Existing Building Outlines (surveyed)
- Proposed Cycle Path Surfacing at Bus Stops
- Proposed Cycle Path Markings
- Proposed Cycle/Ped Separation Kerb (Type 2 unless stated otherwise)
- Proposed Concrete Buffer
- Proposed Island
- Proposed Bus Stop Passenger Wait Zone
- Proposed Planting Zone
- Proposed Warning Tactile Treatment (Yellow)
- Proposed Warning Tactile Treatment (Green)
- Proposed Warning Tactile Treatment (Type 3 Separator)
- Proposed Directional Tactile Treatment
- Proposed Vehicle Crossing (Reinforced or Commercial Construction where indicated)
- Proposed Cycle Path
- Proposed Footpath
- Grass to be retained
- Proposed Grass Berm
- Existing Trees / Vegetation
- Proposed Shared Path
- Approximate Edge of closed landfill
- Traffic Signs (Existing / New)
- Cycle Parking (as TDM Technical Standards Detail CY0002A Sheffield Type with Scratch protection on top rail)
- On Road Lane Separator as CY0005A 600mm Wide
- Existing Pole and Luminaire to remain
- New Pole and Luminaire
- Existing Pole with New Luminaire
- Existing Pole decommissioned and removed
- Existing Pole relocate retrofit

SKETCH / WORK IN PROGRESS

ORIGINAL DRAWING IN COLOUR



REV	DESCRIPTION	DATE
A	Detailed Design - Draft for Comment	29/09/2020
B	For Stage 1 Tender	18/11/2020
C1	FOR INTERNAL USE ONLY / Work in Progress	6/03/2022

DRAWING Q.A.

WORK IN PROGRESS  
DRAWING

DO NOT SCALE OFF THIS DRAWING.  
VERIFY ALL DIMENSIONS ON SITE  
BEFORE COMMENCING ANY WORK.

CLIENT



PROJECT

POINT CHEVALIER TO WESTMERE CYCLEWAY

PROJECT TYPE  
TRANSPORT INFRASTRUCTURE  
CONTRACT NO.  
365-20-671-PS

PROJECT PHASE  
DETAILED DESIGN  
CONSULTANT PROJECT NO.  
419032

DRAWING

Civils - General Arrangement Plan  
Sheet 13 of 18

DRAWING NO.

419032-MMD-XX-00-DR-C-0122 C1

C

SCALE (A1)

1:250



ACCDoc\Mot\_MacDonald\419032-PT Chevalier\Drawings\0100-0199 General Arrangement\419032-MMD-XX-00-DR-C-0110.dwg Mar 6, 2022 - 6:04PM

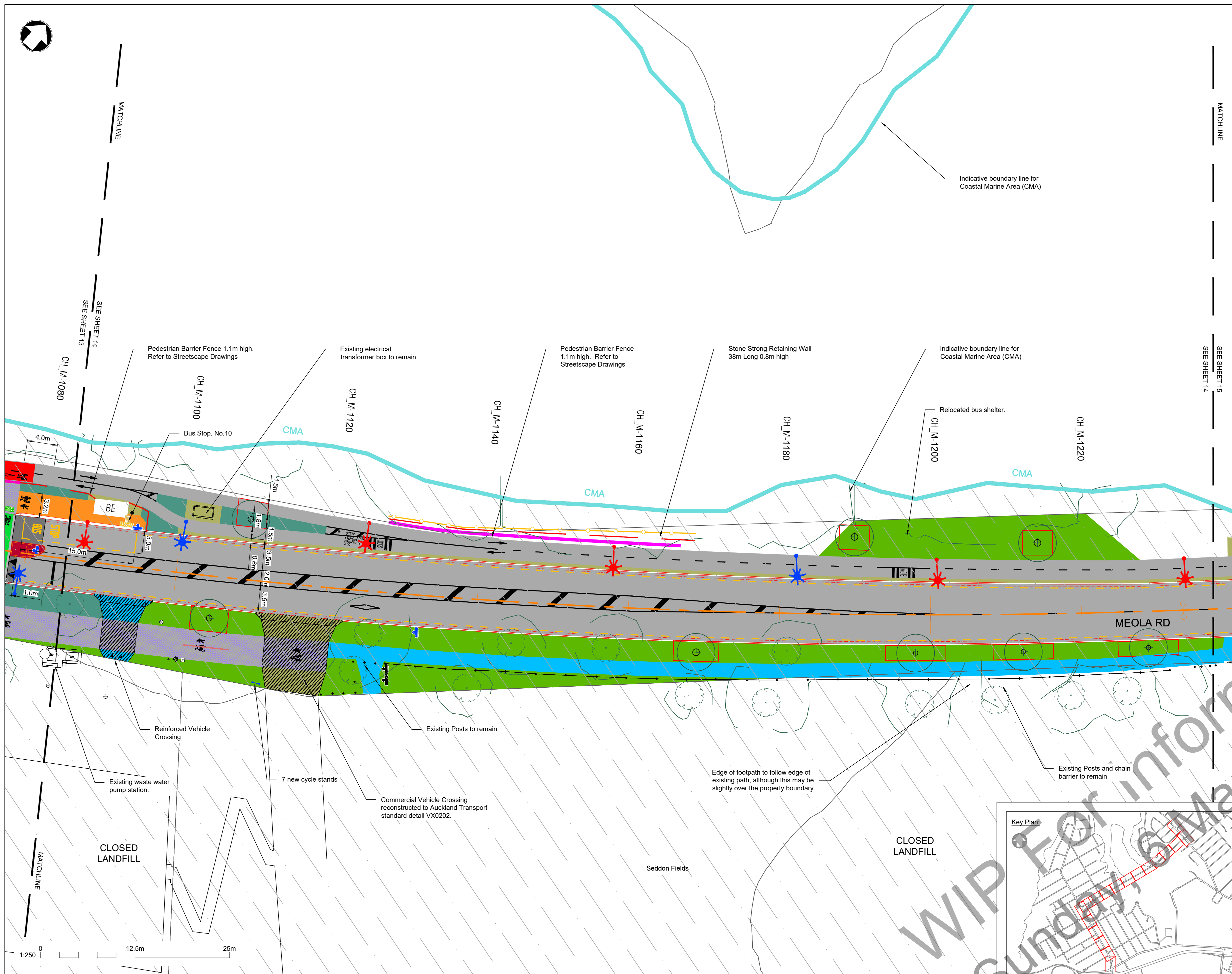

#### Notes:

1. This drawing is to be read in conjunction with all supplied drawings and design documentation.
2. All dimensions are in meters (unless noted otherwise).
3. Do not obtain dimensions from scaling.
4. Chainages shown on plan are in meters.
5. Drawing projection and coordinates are in terms of New Zealand Transverse Mercator circuit (NZTM) 2000.
6. Levels shown are to Auckland 1946 local vertical datum.
7. Background imagery sourced from Nearmap™ in 2020.
8. Proposed trees to be confirmed with finalised 2D design.

#### Legend:

##### General Arrangement:

- Pt Chevalier Rd Control Line
- Meola Rd Control Line
- Garnet Road Control Line
- Existing Property Boundary
- Existing Kerb & channel to remain
- Proposed Kerb & channel
- Existing Building Outlines (surveyed)
- Proposed Cycle Path Surfacing at Bus Stops
- Proposed Cycle Path Markings
- Proposed Cycle/Ped Separation Kerb (Type 2 unless stated otherwise)
- Proposed Concrete Buffer
- Proposed Island
- Proposed Bus Stop Passenger Wait Zone
- Proposed Planting Zone
- Proposed Warning Tactile Treatment (Yellow)
- Proposed Warning Tactile Treatment (Green)
- Proposed Warning Tactile Treatment (Type 3 Separator)
- Proposed Directional Tactile Treatment
- Proposed Vehicle Crossing (Reinforced or Commercial Construction where indicated)
- Proposed Cycle Path
- Proposed Footpath
- Grass to be retained
- Proposed Grass Berm
- Existing Trees / Vegetation
- Proposed Shared Path
- Approximate Edge of closed landfill
- Traffic Signs (Existing / New)
- Cycle Parking (as TDM Technical Standards Detail CY0002A Sheffield Type with Scratch protection on top rail)
- On Road Lane Separator as CY0005A 600mm Wide
- Existing Pole and Luminaire to remain
- New Pole and Luminaire
- Existing Pole with New Luminaire
- Existing Pole decommissioned and removed
- Existing Pole relocate retrofit

#### SKETCH / WORK IN PROGRESS

DRAWING	Civils - General Arrangement Plan
Sheet 14 of 18	
DRAWING NO.	419032-MMD-XX-00-DR-C-0123
REVISION	C1
C	SCALE (A1) 1:250

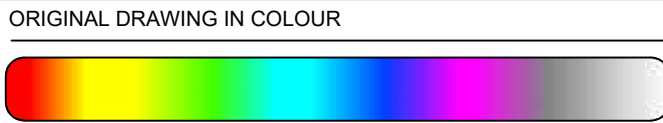

REV	DESCRIPTION	DATE
A	Detailed Design - Draft for Comment	29/09/2020
B	For Stage 1 Tender	18/11/2020
C1	FOR INTERNAL USE ONLY / Work in Progress	6/03/2022

DRAWING Q.A.
WORK IN PROGRESS DRAWING

DO NOT SCALE OFF THIS DRAWING.  
VERIFY ALL DIMENSIONS ON SITE  
BEFORE COMMENCING ANY WORK.



PROJECT	POINT CHEVALIER TO WESTMERE CYCLEWAY
PROJECT TYPE	TRANSPORT INFRASTRUCTURE
CONTRACT NO.	365-20-671-PS
PROJECT PHASE	DETAILED DESIGN
CONSULTANT PROJECT NO.	419032



ACCDocs\\Mot\_MacDonald\\419032-PT Chevalier\\Drawings\\0100-0199 General Arrangement\\419032-MMD-XX-00-DR-C-0110.dwg Mar 6, 2022 - 6:04PM



Notes:

1. This drawing is to be read in conjunction with all supplied drawings and design documentation.
2. All dimensions are in meters (unless noted otherwise).
3. Do not obtain dimensions from scaling.
4. Chainages shown on plan are in meters.
5. Drawing projection and coordinates are in terms of New Zealand Transverse Mercator circuit (NZTM) 2000.
6. Levels shown are to Auckland 1946 local vertical datum.
7. Background imagery sourced from Nearmap™ in 2020.
8. Proposed trees to be confirmed with finalised 2D design.

Legend:

General Arrangement:

- Pt Chevalier Rd Control Line
- Meola Rd Control Line
- Garrett Road Control Line
- Existing Property Boundary
- Existing Kerb & channel to remain
- Proposed Kerb & channel
- Existing Building Outlines (surveyed)
- Proposed Cycle Path Surfacing at Bus Stops
- Proposed Cycle Path Markings
- Proposed Cycle/Ped Separation Kerb (Type 2 unless stated otherwise)
- Proposed Concrete Buffer
- Proposed Island
- Proposed Bus Stop Passenger Wait Zone
- Proposed Planting Zone
- Proposed Warning Tactile Treatment (Yellow)
- Proposed Warning Tactile Treatment (Green)
- Proposed Warning Tactile Treatment (Type 3 Separator)
- Proposed Directional Tactile Treatment
- Proposed Vehicle Crossing (Reinforced or Commercial Construction where indicated)
- Proposed Cycle Path
- Proposed Footpath
- Grass to be retained
- Proposed Grass Berm
- Existing Trees / Vegetation
- Proposed Shared Path
- Approximate Edge of closed landfill
- Traffic Signs (Existing / New)
- Cycle Parking (as TDM Technical Standards Detail CY0002A Sheffield Type with Scratch protection on top rail)
- On Road Lane Separator as CY0005A 600mm Wide
- Existing Pole and Luminaire to remain
- New Pole and Luminaire
- Existing Pole with New Luminaire
- Existing Pole decommissioned and removed
- Existing Pole relocate retrofit

SKETCH / WORK IN PROGRESS

DRAWING	Civils - General Arrangement Plan	REVISION
Sheet 15 of 18		
DRAWING NO.	419032-MMD-XX-00-DR-C-0124	C1
C	SCALE (A1)	1:250

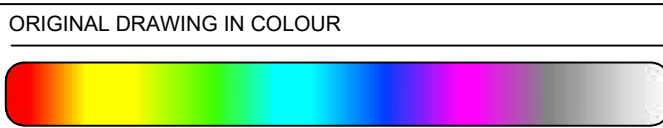

REV	DESCRIPTION	DATE
A	Detailed Design - Draft for Comment	29/09/2020
B	For Stage 1 Tender	18/11/2020
C1	FOR INTERNAL USE ONLY / Work in Progress	6/03/2022

DRAWING Q.A.
WORK IN PROGRESS DRAWING

DO NOT SCALE OFF THIS DRAWING.  
VERIFY ALL DIMENSIONS ON SITE  
BEFORE COMMENCING ANY WORK.



PROJECT	POINT CHEVALIER TO WESTMERE CYCLEWAY
PROJECT TYPE	TRANSPORT INFRASTRUCTURE
CONTRACT NO.	365-20-671-PS
PROJECT PHASE	DETAILED DESIGN
CONSULTANT PROJECT NO.	419032



ACCDocs\Mot\ MacDonald\419032-PT Chevalier\Drawings\0100-0199 General Arrangement\419032-MMD-XX-00-DR-C-0110.dwg Mar 6, 2022 - 6:04PM

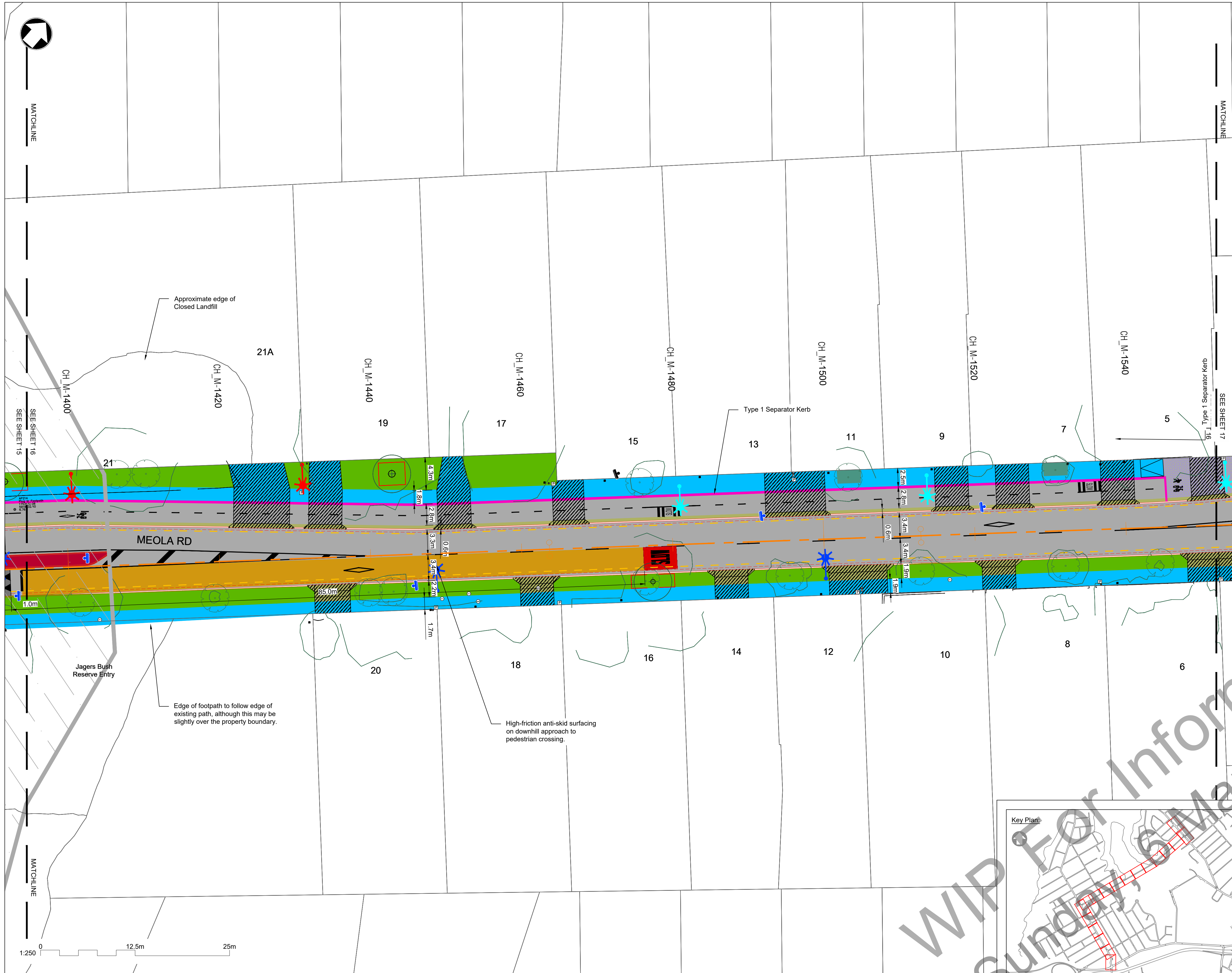

Notes:

1. This drawing is to be read in conjunction with all supplied drawings and design documentation.
2. All dimensions are in meters (unless noted otherwise).
3. Do not obtain dimensions from scaling.
4. Chainages shown on plan are in meters.
5. Drawing projection and coordinates are in terms of New Zealand Transverse Mercator circuit (NZTM) 2000.
6. Levels shown are to Auckland 1946 local vertical datum.
7. Background imagery sourced from Nearmap™ in 2020.
8. Proposed trees to be confirmed with finalised 2D design.

Legend:

General Arrangement:

- Pt Chevalier Rd Control Line
- Meola Rd Control Line
- Garnet Road Control Line
- Existing Property Boundary
- Existing Kerb & channel to remain
- Proposed Kerb & channel
- Existing Building Outlines (surveyed)
- Proposed Cycle Path Surfacing at Bus Stops
- Proposed Cycle Path Markings
- Proposed Cycle/Ped Separation Kerb (Type 2 unless stated otherwise)
- Proposed Concrete Buffer
- Proposed Island
- Proposed Bus Stop Passenger Wait Zone
- Proposed Planting Zone
- Proposed Warning Tactile Treatment (Yellow)
- Proposed Warning Tactile Treatment (Green)
- Proposed Warning Tactile Treatment (Type 3 Separator)
- Proposed Directional Tactile Treatment
- Proposed Vehicle Crossing (Reinforced or Commercial Construction where indicated)
- Proposed Cycle Path
- Proposed Footpath
- Grass to be retained
- Proposed Grass Berm
- Existing Trees / Vegetation
- Proposed Shared Path
- Approximate Edge of closed landfill
- Traffic Signs (Existing / New)
- Cycle Parking (as TDM Technical Standards Detail CY0002A Sheffield Type with Scratch protection on top rail)
- On Road Lane Separator as CY0005A 600mm Wide
- Existing Pole and Luminaire to remain
- New Pole and Luminaire
- Existing Pole with New Luminaire
- Existing Pole decommissioned and removed
- Existing Pole relocate retrofit

SKETCH / WORK IN PROGRESS

DRAWING  
Civils - General Arrangement Plan  
Sheet 16 of 18

DRAWING NO. 419032-MMD-XX-00-DR-C-0125 C1  
REVISION  
C SCALE (A1) 1:250

ORIGINAL DRAWING IN COLOUR

REV	DESCRIPTION	DATE
A	Detailed Design - Draft for Comment	29/09/2020
B	For Stage 1 Tender	18/11/2020
C1	FOR INTERNAL USE ONLY / Work in Progress	6/03/2022

DRAWING Q.A.  
  
WORK IN PROGRESS  
DRAWING

DO NOT SCALE OFF THIS DRAWING.  
VERIFY ALL DIMENSIONS ON SITE  
BEFORE COMMENCING ANY WORK.

CLIENT



PROJECT  
POINT CHEVALIER TO WESTMERE CYCLEWAY

PROJECT TYPE TRANSPORT INFRASTRUCTURE	PROJECT PHASE DETAILED DESIGN
CONTRACT NO. 365-20-671-PS	CONSULTANT PROJECT NO. 419032



ACCDoc\Mot\ MacDonald\19032-PT Chevalier\Drawings\0100-0199 General Arrangement\19032-MMD-XX-00-DR-C-0110.dwg Mar 6, 2022 - 6:04PM

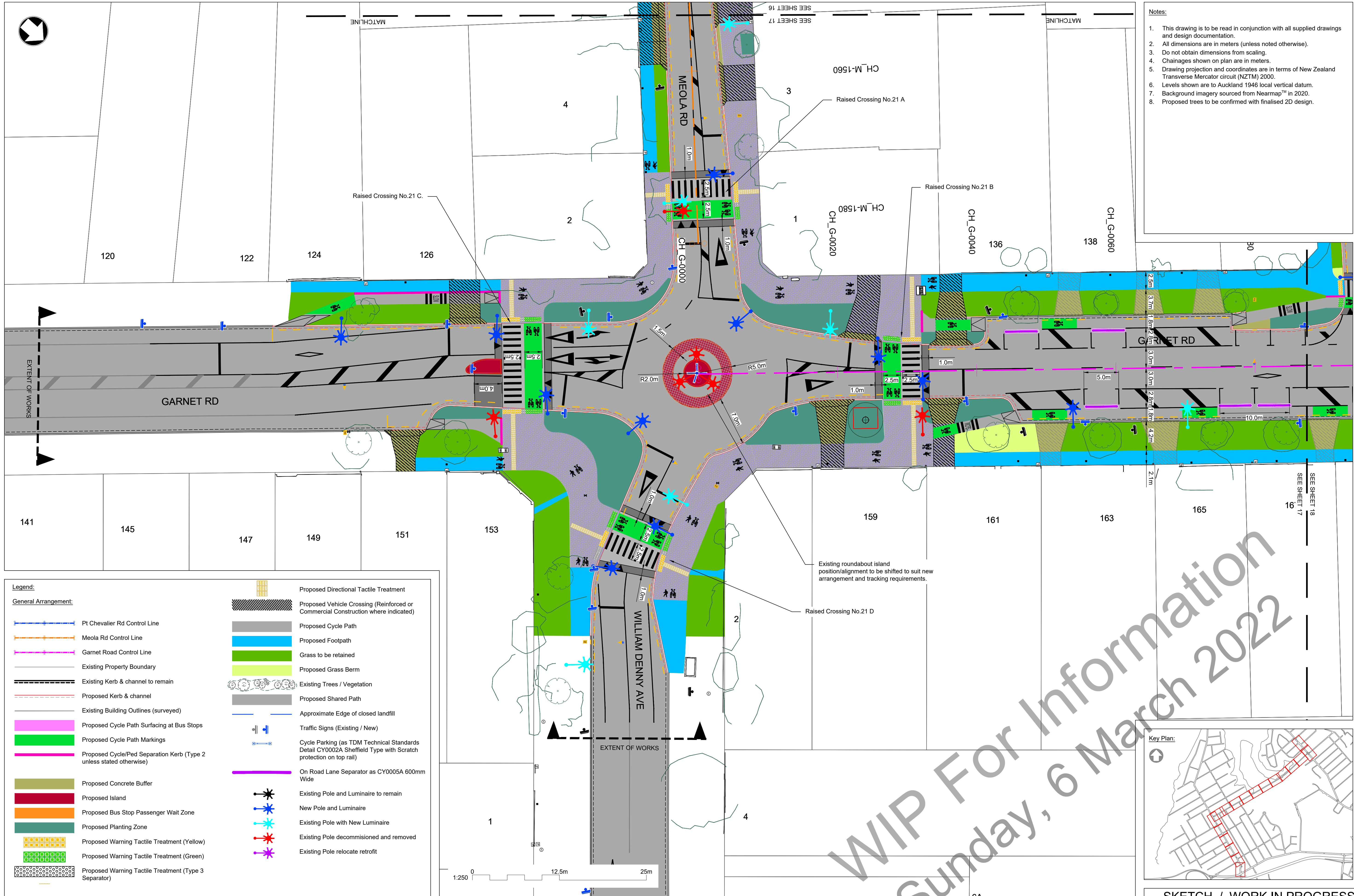

- Notes:
1. This drawing is to be read in conjunction with all supplied drawings and design documentation.
  2. All dimensions are in meters (unless noted otherwise).
  3. Do not obtain dimensions from scaling.
  4. Chainages shown on plan are in meters.
  5. Drawing projection and coordinates are in terms of New Zealand Transverse Mercator circuit (NZTM) 2000.
  6. Levels shown are to Auckland 1946 local vertical datum.
  7. Background imagery sourced from Nearmap™ in 2020.
  8. Proposed trees to be confirmed with finalised 2D design.

SKETCH / WORK IN PROGRESS

DRAWING  
Civils - General Arrangement Plan  
Sheet 17 of 18

DRAWING NO. 419032-MMD-XX-00-DR-C-0126  
C  
REVISION C1  
SCALE (A1) 1:250

CLIENT



PROJECT

POINT CHEVALIER TO WESTMERE CYCLEWAY

PROJECT TYPE

TRANSPORT INFRASTRUCTURE

CONTRACT NO.

365-20-671-PS

PROJECT PHASE

DETAILED DESIGN

CONSULTANT PROJECT NO.

419032



ACCDoc\Mot\_MacDonald\419032-PT Chevalier\Drawings\0100-0199 General Arrangement\419032-MMD-XX-00-DR-C-0110.dwg Mar 6, 2022 - 6:04PM

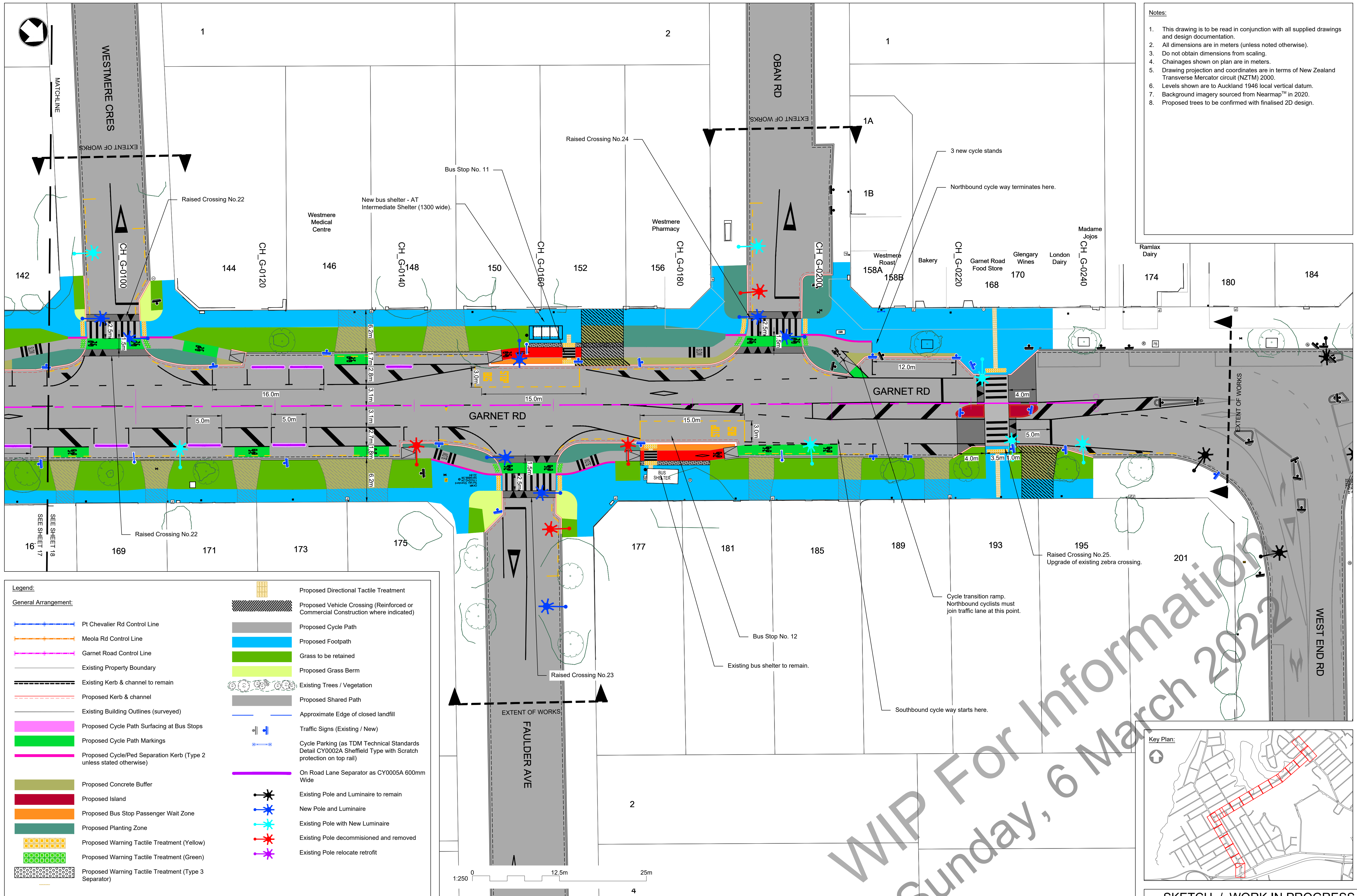

- Notes:
1. This drawing is to be read in conjunction with all supplied drawings and design documentation.
  2. All dimensions are in meters (unless noted otherwise).
  3. Do not obtain dimensions from scaling.
  4. Chainages shown on plan are in meters.
  5. Drawing projection and coordinates are in terms of New Zealand Transverse Mercator circuit (NZTM) 2000.
  6. Levels shown are to Auckland 1946 local vertical datum.
  7. Background imagery sourced from Nearmap™ in 2020.
  8. Proposed trees to be confirmed with finalised 2D design.

**Legend:**

**General Arrangement:**

- Pt Chevalier Rd Control Line
- Meola Rd Control Line
- Garnet Road Control Line
- Existing Property Boundary
- Existing Kerb & channel to remain
- Proposed Kerb & channel
- Existing Building Outlines (surveyed)
- Proposed Cycle Path Surfacing at Bus Stops
- Proposed Cycle Path Markings
- Proposed Cycle/Ped Separation Kerb (Type 2 unless stated otherwise)
- Proposed Concrete Buffer
- Proposed Island
- Proposed Bus Stop Passenger Wait Zone
- Proposed Planting Zone
- Proposed Warning Tactile Treatment (Yellow)
- Proposed Warning Tactile Treatment (Green)
- Proposed Warning Tactile Treatment (Type 3 Separator)

**Proposed Directional Tactile Treatment**

**Proposed Vehicle Crossing (Reinforced or Commercial Construction where indicated)**

**Proposed Cycle Path**

**Proposed Footpath**

**Grass to be retained**

**Proposed Grass Berm**

**Existing Trees / Vegetation**

**Proposed Shared Path**

**Approximate Edge of closed landfill**

**Traffic Signs (Existing / New)**

**Cycle Parking (as TDM Technical Standards Detail CY0002A Sheffield Type with Scratch protection on top rail)**

**On Road Lane Separator as CY0005A 600mm Wide**

**Existing Pole and Luminaire to remain**

**New Pole and Luminaire**

**Existing Pole with New Luminaire**

**Existing Pole decommissioned and removed**

**Existing Pole relocate retrofit**



REV	DESCRIPTION	DATE
A	Detailed Design - Draft for Comment	29/09/2020
B	For Stage 1 Tender	18/11/2020
C1	FOR INTERNAL USE ONLY / Work in Progress	6/03/2022

DRAWING Q.A.
WORK IN PROGRESS DRAWING

DO NOT SCALE OFF THIS DRAWING.  
VERIFY ALL DIMENSIONS ON SITE  
BEFORE COMMENCING ANY WORK.

CLIENT



PROJECT

POINT CHEVALIER TO WESTMERE CYCLEWAY

PROJECT TYPE  
TRANSPORT INFRASTRUCTURE

CONTRACT NO.  
365-20-671-PS

PROJECT PHASE  
DETAILED DESIGN

CONSULTANT PROJECT NO.  
419032

SKETCH / WORK IN PROGRESS

DRAWING

Civils - General Arrangement Plan  
Sheet 18 of 18

DRAWING NO.

419032-MMD-XX-00-DR-C-0127 C1

C

SCALE (A1)

1:250