

ORIGINAL SIZE A1 200mm DO NOT SCALE - IF IN DOUBT, ASK

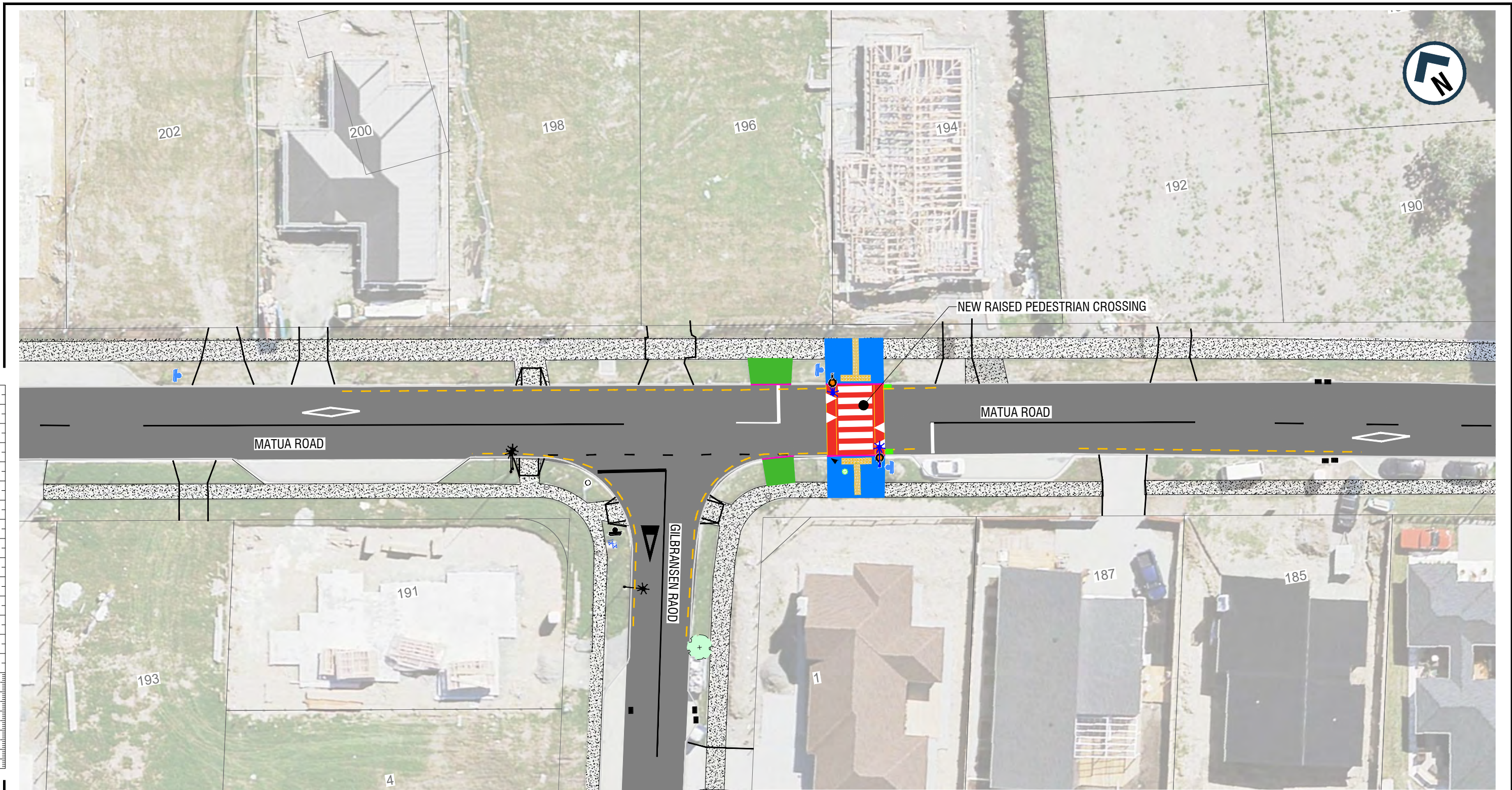

**LEGEND:**

- |            |                               |  |                               |  |                         |
|------------|-------------------------------|--|-------------------------------|--|-------------------------|
|            | EXISTING LINE MARKING (WHITE) |  | EXISTING POLE                 |  | PROPOSED TACTILE PAVERS |
|            | EXISTING KERB                 |  | EXISTING PRAM CROSSING        |  | PROPOSED BERM           |
|            | EXISTING SIGN                 |  | PROPOSED MANHOLE              |  | PROPOSED NSAAT          |
|            | EXISTING STREET LIGHT         |  | PROPOSED BELISHA DISC         |  |                         |
|            | EXISTING PROPERTY BOUNDARY    |  | PROPOSED CATCHPIT             |  |                         |
| <b>255</b> | PROPERTY NUMBERS              |  | PROPOSED STREETLIGHT          |  |                         |
|            | EXISTING CATCHPIT             |  | PROPOSED FOOTPATH             |  |                         |
|            | EXISTING MANHOLE              |  | PROPOSED RAISED SPEED TABLE   |  |                         |
|            | EXISTING TREE                 |  | PROPOSED STANDARD KERB        |  |                         |
|            | EXISTING WATER VALVE          |  | PROPOSED SIGN                 |  |                         |
|            | EXISTING FOOTPATH             |  | PROPOSED LINE MARKING (WHITE) |  |                         |



**AUCKLAND TRANSPORT**  
 SITE 3 - 196 MATUA ROAD,  
 SWEDISH STYLE RAISED TABLE,  
 KUMEU - AUCKLAND

Status Stamp: **FOR CONSULTATION**

Date Stamp: 30/03/2022

A1 Scales	1:200	A3 Scales	1:400
-----------	-------	-----------	-------

Drawing No: 02285.03 - EC100

Rev: **0**