

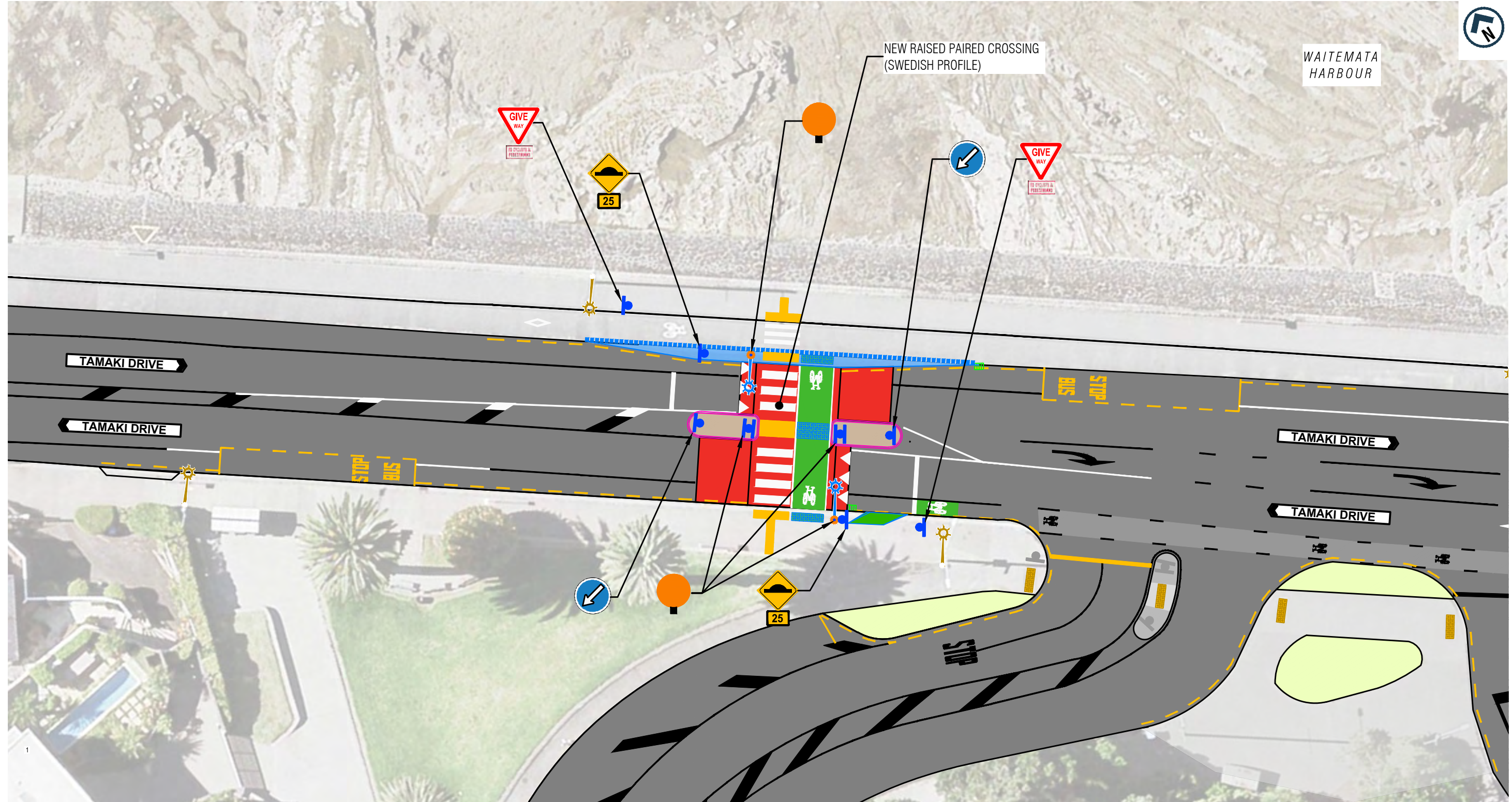

WAITEMATA HARBOUR

NEW RAISED PAIRED CROSSING (SWEDISH PROFILE)



PROPOSED PARKING LOSS	
	PARKING LOSS
NORTH	7
SOUTH	4
TOTAL	11

LEGEND

- NEW ROADMARKING (WHITE)
- PROPERTY BOUNDARY
- EXISTING KERBLINE
- NEW KERBLINE
- NEW BROKEN YELLOW LINES "NSAAT"
- EXISTING BROKEN YELLOW LINES "NSAAT"
- TRAFFIC CALMING / RAISED SPEED TABLE
- EXISTING SIGN
- NEW / RELOCATED SIGN
- NEW STREETLIGHT
- NEW CATCHPIT
- NEW TRAFFIC ISLAND
- NEW FOOTPATH / KERB EXTENSION / CYCLE PATH
- ROAD CORRIDOR
- BERM / PLANTING
- TACTILE PAVERS - PEDESTRIAN
- CYCLE LANE



AUCKLAND TRANSPORT
PEDESTRIAN IMPROVEMENT
PROGRAMME
TAMAKI DRIVE, ST. HELIERS

Status: FOR CONSULTATION

Date Stamp: 10.05.2022

A1	1:300	A3	1:600
----	-------	----	-------

Drawing No. A2110796-20

B

ORIGINAL SIZE A1 200mm DO NOT SCALE - IF IN DOUBT, ASK