



We're widening and improving the Moyle Park shared path

Kia ora,

We're widening and improving the Moyle Park shared pedestrian path to make the route safer, more comfortable and to further encourage walking and cycling in the community.

Works will take place from Tuesday 28 April to Thursday 30 June, between 7am to 6pm.

Please note that wet weather or unforeseen circumstances may delay the start or completion of the work. If there are significant delays, we will keep you informed.

Here is what you need to know about the work happening near you:

Where	<ul style="list-style-type: none">• From the path entrance next to 82 Bader Drive to the Footbridge connecting to Māngere Centre Park (work location map below).
When	<ul style="list-style-type: none">• 28 April to Thursday 30 June, between 7am and 6pm.
What we're doing	<ul style="list-style-type: none">• Widening the path to 4 metres.• Widening the path between the two motorway bridges to 3.5 metres.• Improving path surface.• Adding clearer markings on the shared path.• Trimming trees to improve visibility.
How it may impact you	<ul style="list-style-type: none">• Please note that some levels of noise and vibration are expected due to construction activities. Noisy activity will take place during the day wherever possible.
How travel is affected	<ul style="list-style-type: none">• Pedestrian and bike access will be closed at three points: the path entrances behind Kura Kaupapa o Māngere, and the motorway footbridge at the end of Māngere Centre Park shared path.• These closures are in place at all times.• Please follow all signs safely.

Work location

The map below shows where the work is taking place:

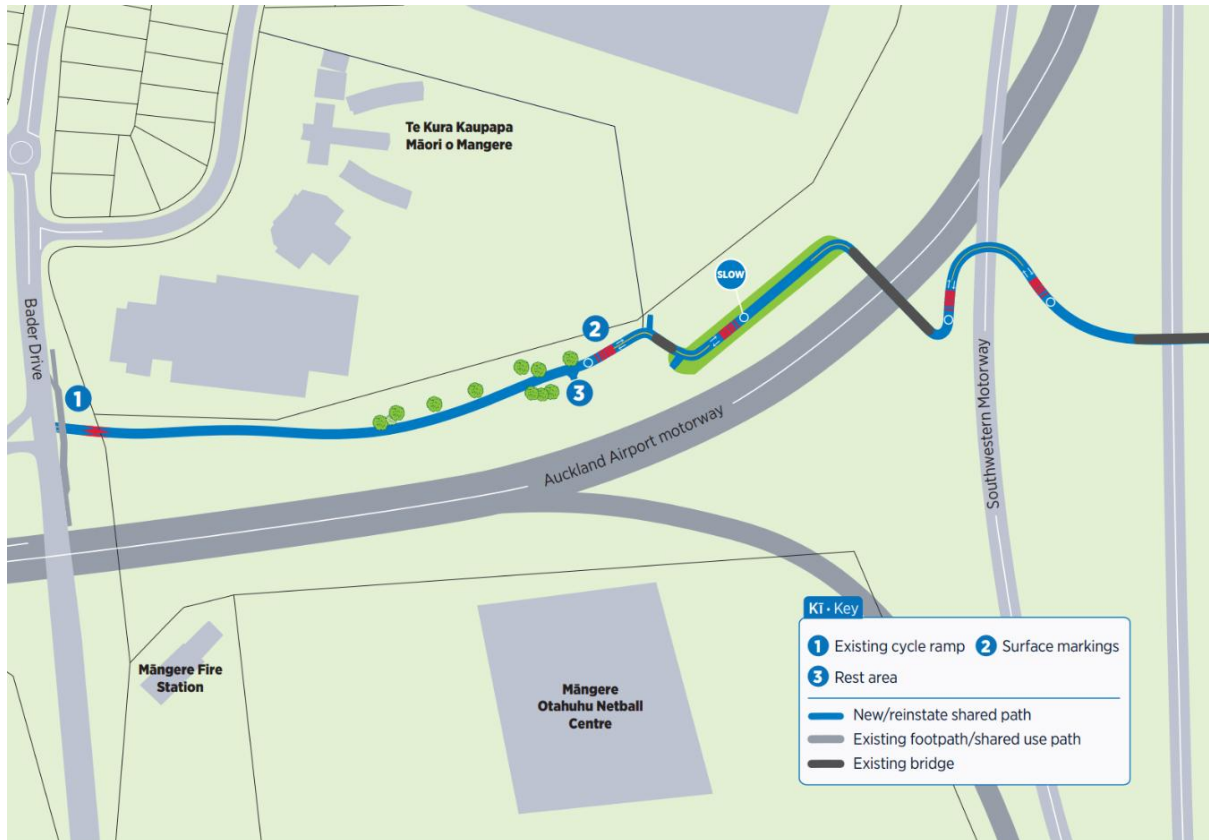

Contact us

If you have any questions related to the **construction**, please contact:

Name: Ikram Patel

Phone: 021 638 728

Email: ikram@traffica.co.nz

If you have any questions or concerns about this project, please contact AT:

Email: info@at.govt.nz (include reference 'Moyle Park shared path improvements')

Phone: 09 3553 553

Thank you for your patience and understanding while we carry out these improvements.

Ngā mihi,
Auckland Transport